

# REVO TOUCH

## *Operating Manual*



**THE FIRE  
OF AUSTRIA.**

<b>1. PREFACE</b>	<b>3</b>
Explanations to symbols .....	3
Spare part overview exploded diagram .....	4
Spare part overview article numbers .....	6
Dimensions .....	7
Technical data.....	7
Amount of fuel .....	7
Packaging .....	7
Electrical connection .....	7
<b>2. IMPORTANT INFORMATION</b>	<b>8</b>
General warning and safety information .....	8
First heating.....	8
Safety distances .....	8
Prior to set up.....	9
The correct chimney connection .....	9
<b>3. BRIEF INFORMATION ON FUEL - PELLETS</b>	<b>10</b>
What are pellets? .....	10
Wood pellet specification according to ENplus – A1 .....	10
Pellet container refilling during operation .....	10
Pellet storage .....	10
<b>4. TECHNOLOGY AND SAFETY FUNCTIONS</b>	<b>11</b>
Operating comfort.....	11
Top efficiency - lowest emissions.....	11
Overheating.....	11
Low-temperature shutdown .....	11
Electrical excess current protection.....	11
Automatic cleaning cycle.....	11
Component monitoring .....	11
Auger motor monitoring .....	11
Power failure (during heating).....	11
Power failure (during the initial stage).....	11
<b>5. INSTALLING THE STOVE</b>	<b>12</b>
General information .....	12
Connection to the chimney .....	12
Connecting to a steel chimney .....	12
Combustion air.....	12
Feeding in external combustion air.....	12
<b>6. ASSEMBLY/DISMANTLING STOVE AND OPTIONS</b>	<b>13</b>
Disassembly of the front side casing.....	13
Disassembly of the rear side panel.....	13

<b>7. COMFORT OPTIONS</b>	<b>14</b>
Room sensor, Radio room sensor.....	14
GSM Control.....	14
Interface for various options.....	14
External room thermostat.....	14
External connection cable bridge.....	14
Option firenet.....	14
<b>8. MAINTENANCE</b>	<b>15</b>
Open the combustion chamber door.....	15
Cleaning of the burn pot - daily.....	15
Cleaning the flame temperature sensor.....	15
Empty the ash drawer.....	15
Cleaning the door glass.....	15
Cleaning painted surfaces.....	15
<b>9. CLEANING</b>	<b>16</b>
Cleaning the convection air openings.....	16
Combustion air - intake.....	16
Cleaning the pellet container.....	16
Clean flue gas fan housing.....	16
Cleaning flue pipes.....	16
Clean flue gas collecting channel.....	17
Cleaning the flue pipes.....	17
Bearings.....	17
Checking door seal.....	17
<b>10. PROBLEMS - POSSIBLE SOLUTIONS</b>	<b>18</b>
Problem 1.....	18
Problem 2.....	18
Problem 3.....	18
<b>11. INSTRUCTIONS FOR COMMISSIONING PROTOCOL</b>	<b>19</b>
<b>12. WARRANTY</b>	<b>21</b>

## 1. PREFACE

### Explanations to symbols

	...Important note		...Hex #8		...Hex #10		...Spanner #19
	...Useful tip		...Manually				

*Spare part overview exploded diagram*

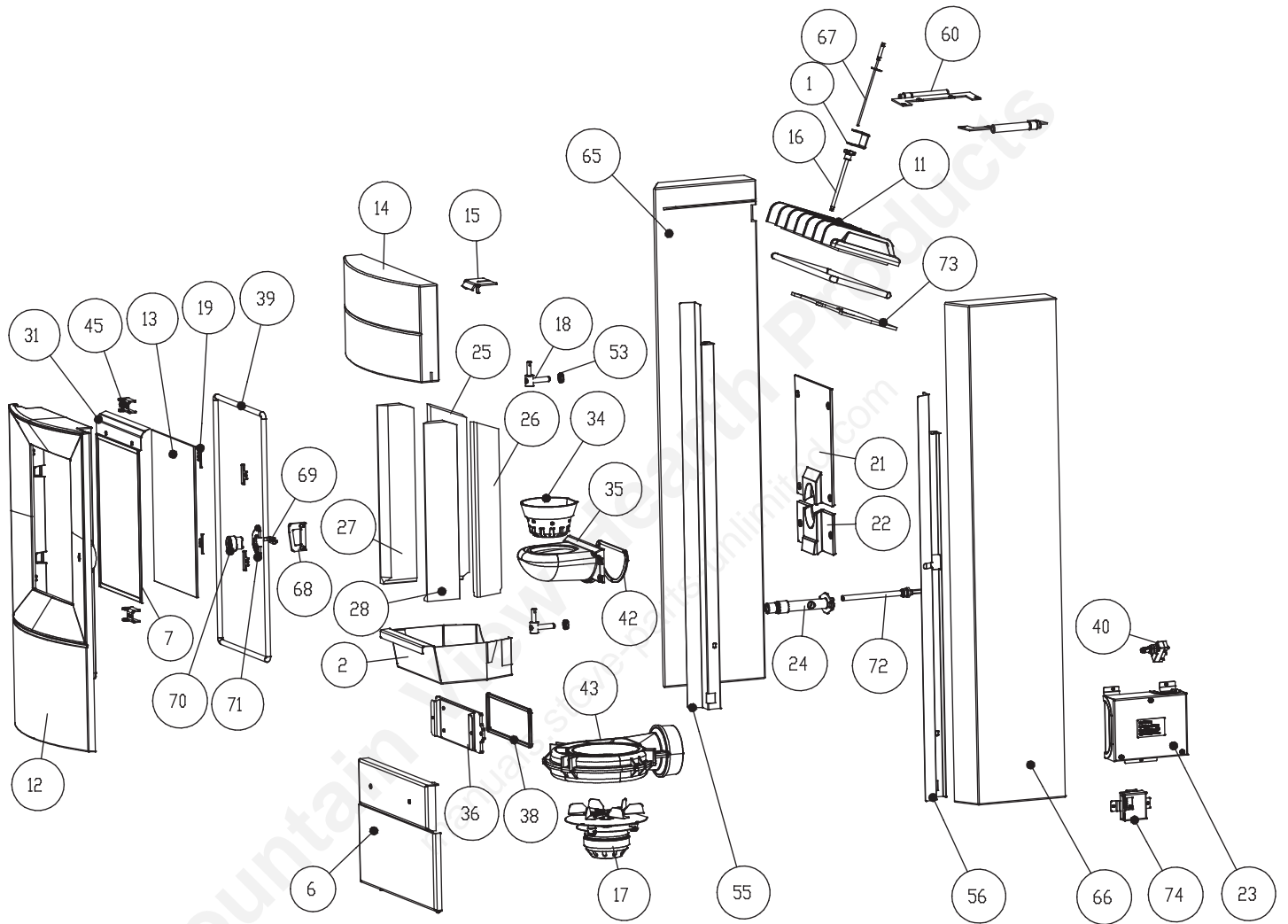

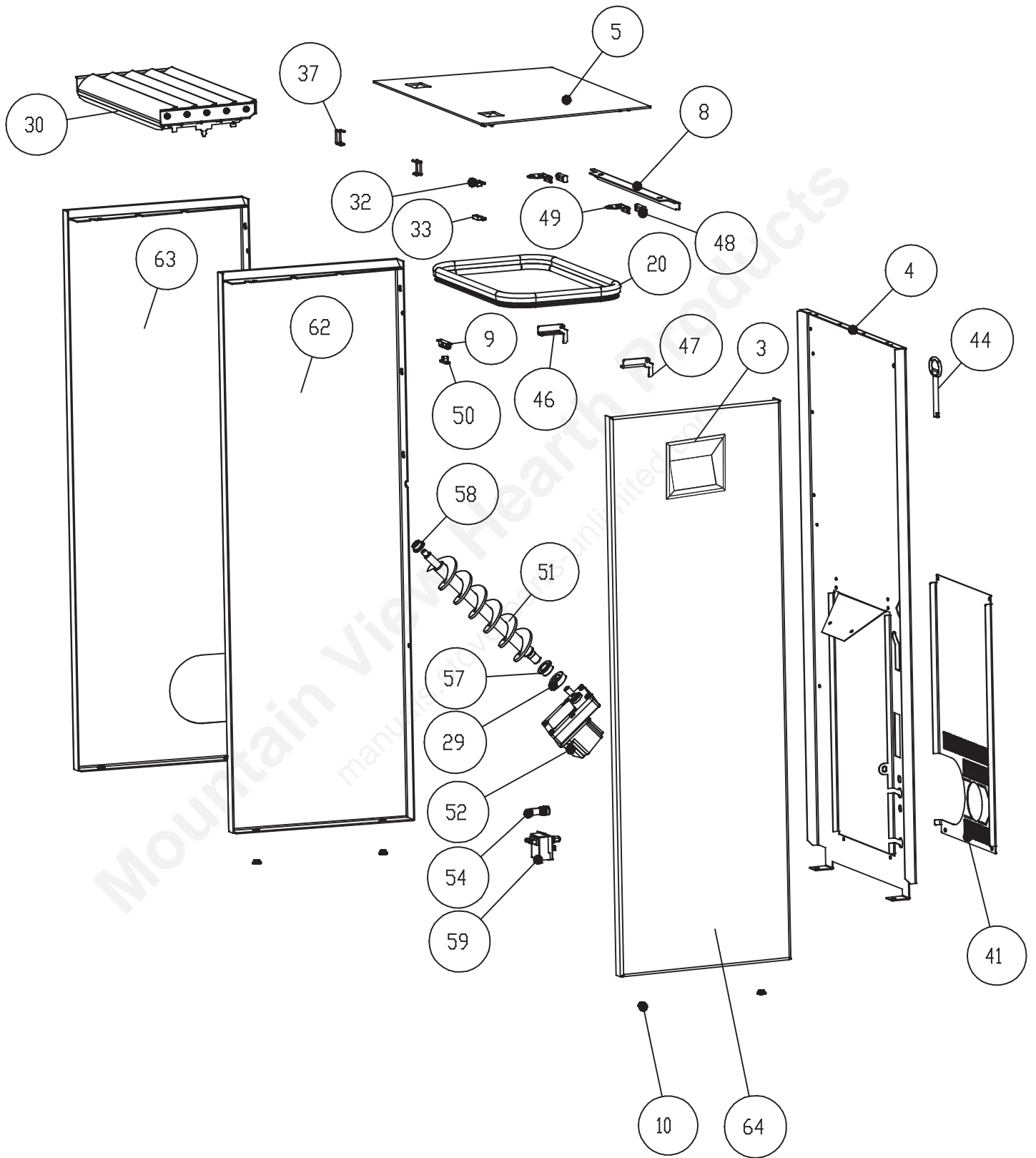

## Spare part overview article numbers

Nr.	Art.Nr.	Description	Nr.	Art.Nr.	Description
1	L01441	Pressure bracket	44	N112017	Key
2	L01447	Ash drawer	45	L01448	Hinge
3 *1	B15621	Key display	46	L01772	Hinge left
3 *2	B16574	Touch-Display plug-in		L02542	Hinge left (from nr.: 1305474)
4	Z34176	Reservoir rear gray	47	L01773	Hinge right
	Z34193	Reservoir rear black		L02543	Hinge right (from nr.: 1305474)
5	Z34194	Container lid grey (till nr.: 1305473)	48	Z30494	Hinge shaft
	Z34195	Container lid black (till nr.: 1305473)		Z34854	Hinge shaft
	Z35609	Container lid grey (from nr.: 1305474)	49	L01813	Hinge holder (till nr.: 1305473)
	Z35608	Container lid black (from nr.: 1305474)		L02498	Hinge holder (from nr.: 1305474)
6	Z34141	Cover panel, bottom grey	50	N110461	Double ball catch
	Z34196	Cover panel, bottom black	51	B12301	Auger
7	N103693	Flat seal black 8x2	52	N112030	Screw motor, stepless
8	Z34197	Cover panel grey (till nr.: 1305473)	53	N100483	Hexagonal nut M10
	Z34198	Cover panel black (till nr.: 1305473)	54	N107887	Fuse holder
	Z35611	Cover panel grey (from nr.: 1305474)	55	Z34138	Cover panel left metallic grey
	Z35610	Cover panel black (from nr.: 1305474)		Z34200	Cover panel left black
9	N110461	Double ball catch	56	Z34139	Cover panel right metallic grey
10	N111730	Grommet		Z34199	Cover panel right black
11	Z34135	Comb. Chamber cover grey	57 *5	Z35182	Friction bearing Di16
	Z33788	Comb. chamber cover black	58	Z35183	Friction bearing Di10
12	Z34084	Combustion chamber door	59	N111586	Safety temperature limiter
	B16324	Combustion chamber door assy	60	B16328	Stone holder left/right
	Z34235	Combustion chamber door metallic	62	L01781	Side casing panel back left grey
	B16380	Combustion chamber door metallic assy		L01814	Side casing panel back left black
13	Z32866	Combustion chamber door glass	63	L01816	Side casing connection left grey
14	Z32867	Front stone soapstone		L01815	Side casing connection left black
	Z33187	Sandstone front	64 *1	L01780	Side casing back right grey
	Z36819	Front stone white	64 *2	B17472	Side casing back right grey (for touch-display)
15 *3	L00838	Front holder	64 *1	L01817	Side casing back right black
	L01921	Front holder	64 *2	B17471	Side casing back right black (for touch-display)
16	B16053	Sensor tube	65	Z32870	Side casing soapstone left
17	N111581	Induced draft fan motor		Z34201	Side casing sandstone left
18	B15807	Hinge BA1		Z36818	Side casing stone white left
19	L00475	Glass holder	66	Z32869	Side casing soapstone right
20	N111731	Container seal		Z34202	Side casing sandstone right
21	Z34132	Cast rear panel, top, metallic grey		Z36817	Side casing stone white right
	Z33786	Cast rear panel, top black	67	B16114	Temperature sensor
22	Z34131	Cast rear panel bottom metallic grey	68	L01998	Closure flap
	Z33785	Cast rear panel bottom black		L00427	Closure flap black
23 *1	B15856	Motherboard C2 (for Key display)	69	L01449	Lock tongue
23 *2	B16561	Mainboard USB11	70	Z33794	Locking bolt
24 *4	B17166	Ceramic ignition	71	L01450	Closure plate
25	Z33791	Firebrick lining rear left	73	Z34438	Baffle plate cast iron
26	Z33792	Firebrick lining rear right	74	B16030	Add. board motor
27	Z33789	Firebrick lining front left	*1	B16058	Wiring harness (for Key display)
28	Z33790	Firebrick lining front right	*2	B17364	Wiring harness (for touch-display)
29	Z11915	Lock ring conveyer screw	*1	Z33136	Cable for Key display
30	B15506	Convection fins metallic grey	*2	Z35018	Cable 1,25m for touch-screen
	B15646	Convection fins black		L00797	Motor plate
31	Z34137	Air blade		N111604	Fuse 2,5A
32	N111732	Magnetic switch top part		E15471	Sealing kit
33	N111733	Solenoid switch bottom part		*1	till serial number 1346067
34	Z32345	Fire trough		*2	from serial number 1346068
35	Z33692	Fire trough holder		*3	till serial number 276572
36	B16320	Cleaning opening metallic		*4	requires 2,5A fuse (N111604) till serial number 1346068
	B16352	Cleaning opening black		*5	up to serial number 1331613 the motor plate (L00797) must be supplied as a spare part when replacing the plastic bearing Di16 (Z35182).
37	Z26051	Rest spring			
38	N111280	Sealing cord Ø8mm			
39	N100476	Sealing cord black Ø10mm			
40	N111825	Door contact switch			
41	L01777	Rear wall grey			
	L01812	Rear wall black			
42	N103066	Round sealing strip black D06			
43	B16155	Induced draft fan housing			
	B15913	Induced draft fan assy			

Note: Please consider the powdercoated parts can differ slightly in colour and colour effects though they are elaborated in high quality.

## Dimensions

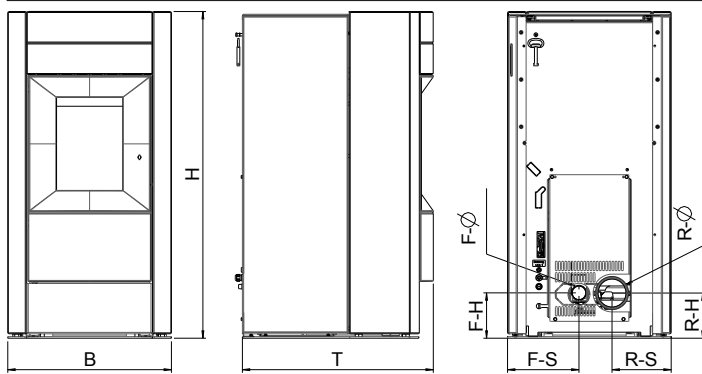

## Technical data

### Technical data

Heating power range	[kW]	2,4 - 9
Room heating capacity (depending on house insulation)	[m <sup>3</sup> ]	50 - 240
Fuel consumption	[kg/h]	bis 2,2
Pellet container capacity	[kg]	40
Electric supply	[V]/[Hz]	230/50
Average electrical input	[W]	~ 20
Fuse	[A]	2,5 AT
Efficiency	[%]	91,1
CO <sub>2</sub>	[%]	14,3
CO-emission on 13% O <sub>2</sub>	[mg/m <sub>N</sub> <sup>3</sup> ]	163
Dust emission	[mg/m <sub>N</sub> <sup>3</sup> ]	9
Exhaust	[g/s]	4,9
Exhaust temperature	[°C]	175,3
Chimney draft requirement	[Pa]	0

The owner of small firing systems or the person authorised for the small firing system is to keep the technical documentation and is to submit it to the authorities or the chimney sweep on request.

#### Note

Please observe the national and European standards as well as local regulations concerning the installation and operation of firing installations!

## Packaging

Your first impression is important to us!

The packaging of your new stove provides excellent protection against damage. However damage to the stove and accessories may still occur during transport.

#### Note

Therefore please check your stove on receipt for damage and completeness! Report any deficiencies to your dealer immediately! Pay particular attention during unpacking that the stone panels remain intact. Scratches to the material can easily occur. Stone panels are excluded from the warrant.

The packaging of your new stove is environmentally neutral to a great extent.

#### Tip

The wood used in the packaging has not been surface treated and may therefore be burnt in your woodburning stove (not in a pelletstove!). The cardboard and film (PE) can be depolluted via the municipal waste collection for recycling.

## Electrical connection

The stove is supplied with an approx. 2m long connecting cable with a Euro-plug. This cable is to be connected to a 230Volt/50Hz socket. The average electrical power consumption is about 20 Watt in heating operation and approx. 150 Watt during automatic ignition. The connection cable must be laid in a way that there is no contact to any sharp edges or hot surfaces of the stove.

## Technical data

### Dimensions

Height	[mm]	1038
Width	[mm]	520
Ccorpus depth	[mm]	606

### Weight

Weight without shell	[kg]	149
Weight with shell	[kg]	237

### Flue pipe connection

R - Ø flue pipe outlet	[mm]	100
RO - H original angle pipe connection height	[cm]	-
RO - T1 original angle pipe total depth	[cm]	-
RO - T2 original angle pipe distance to rear wall	[cm]	-
RO - T3 deapth from rear wall to middle of flue pipe	[cm]	-
RO - S original angle pipe side distance	[cm]	-
R - H rear connection height	[cm]	14
R - S rear connection side distance	[cm]	19

### Fresh air connection

F - Ø diameter	[mm]	50
F - H connection height	[cm]	14
F - S side distance	[cm]	23

### Convection air connection

K - Ø diameter	[mm]	-
K - H connection height	[cm]	-
K - S side distance	[cm]	-

## Amount of fuel

	Nominal load	Part load
Amount of fuel	~2,2kg*	~0,6kg*
Burn time at full pellet hopper	up to ca. 22h	up to ca. 53h

\*Practical values may vary depending on pellet quality.

#### Note

Pellet consumption depends on the size of the pellets. The larger the pellet, the slower the feed and vice versa.

## 2. IMPORTANT INFORMATION

### General warning and safety information

Observance of the introductory general warning information is imperative.

- Read the entire manual thoroughly before installing and putting the stove into service. Observe the national provisions and laws as well as the regulations and rules applicable locally.
- RIKA stoves should only be installed in rooms with normal humidity (dry areas according to VDE 0100 Part 200). The furnaces are not splash water protected and may not be installed in wet areas.
- Only approved transport equipment with sufficient load carrying capacity may be used with your heating appliance.
- Your heating appliance is not suitable for use as a ladder or stationary scaffolding.
- The burning of fuel releases heat energy that lead to extensive heating of the stove surfaces, doors, door and operating handles, glass, flue pipes and possibly the front wall. Refrain from touching these parts without appropriate protective clothing or equipment e.g. heat-resistant gloves or means of operation (operating handle).
- Make your children aware of this particular danger and keep them away from the stove during heating.
- Only burn approved heating materials.
- The combustion or introduction of highly flammable or explosive materials such as empty spray cans etc. in the combustion chamber and storing them near the stove is strictly prohibited due to the danger of explosion.
- No light or inflammable clothing is to be worn when post-heating.
- Use the heat-resistant gloves supplied to open the doors of your stove.
- Make sure that no embers fall out of the combustion chamber onto inflammable material.
- Placing non-heat resistant objects on the stove or near it is prohibited.
- Do not place clothing on the stove to dry.
- Laundry racks etc. must be placed at a sufficient distance to the stove – ACUTE DANGER OF FIRE!
- When your stove is burning, the use of highly inflammable and explosive materials in the same or adjacent rooms is prohibited.
- If the stove is heated in continuous operation, the cleaning intervals are shorter. Increased wear, especially of the thermally stressed parts, is the result. Please therefore strictly follow the requirements for cleaning and maintenance!

**Note**  
Waste and liquids may not be burnt in the stove!

**Note**  
To prevent your stove from overheating of the internal components, do never cover the convection fins!

**Note**  
CAUTION when filling the pellet container. The opening of the pellet container is sufficiently dimensioned to ensure easy filling. Take great care that no pellets drop to the convection fins and the hot stove body. This can cause a lot of smoke.

**Tip**  
Therefore we recommend refilling the pellet container at a cold stove.

#### Note

Your stove will expand and contract during the heating and cooling phase. This can sometimes lead to slight bending or cracking noises. This is normal and is no reason for a complaint.

### First heating

The stove body, just as various steel parts, cast iron parts and the flue pipes are painted with a heat resistant paint. During the first heating the paint dries out completely. This may cause a slight smell. Touching or cleaning the painted surfaces during the curing should be avoided. The hardening of the paint is finished after the first heating with high power.

### Safety distances

#### Note

1. To non-combustible objects  
a > 40 cm b > 10 cm
2. To combustible objects and reinforced concrete load-bearing walls  
a > 80 cm b > 20 cm

#### Tip

please observe a minimum distance of 20 cm behind and sideways the stove for maintenance.

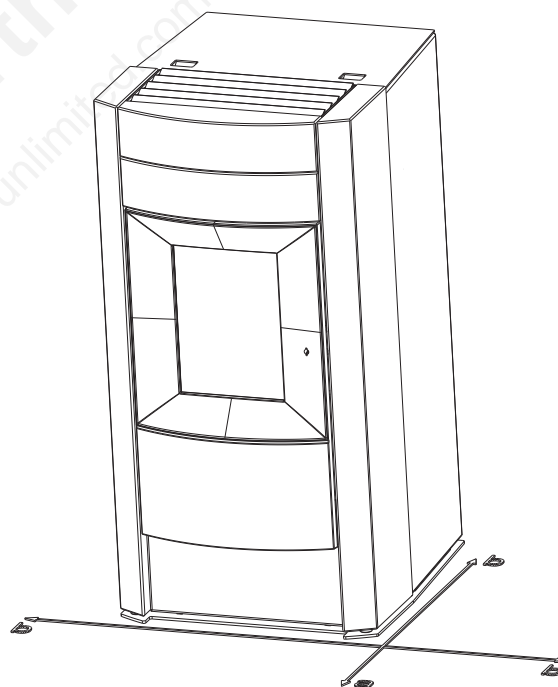

## Prior to set up

### Floor bearing capacity

Ensure that the substructure is capable of bearing the weight of the stove prior to set-up.

#### Note

No modifications may be made to the firing installation. This also leads to loss of warranty and guarantee.

### Floor protection

A base is recommended (glass, sheet steel or ceramic) if the floor is combustible (wood, carpet, etc.). Please observe the respective local regulations and rules.

### Flue pipe connection

- Flue pipes pose a particular source of hazard regarding gas leaks and fire. Get the advice of an authorised specialist company for the layout and assembly.
- Please observe the corresponding installation guidelines for walls panelled with wood when connecting your flue pipes to the stove.
- Observe the formation of flue gas (atmospheric inversion) and draughts when the weather is unfavourable.
- Infeed of too little combustion air can lead to smoke in the rooms or to flue gas leaks. Hazardous deposits in the stove and chimney may also occur.
- If flue gas escapes, let the fire burn out and check whether all the air inlet openings are free and the flue gas pipes and the stove pipe are clean. If in doubt notify the master chimney sweep since draught malfunctions may be connected to your chimney.

## The correct chimney connection

There are several ways to connect your stove to the chimney, eg:

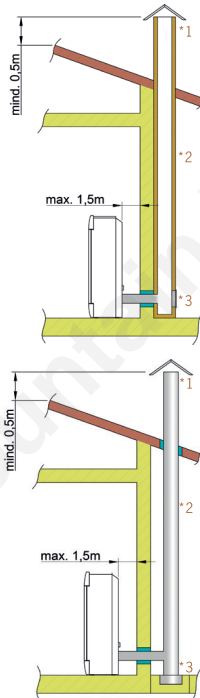

1) wind break, 2) chimney, 3) inspection opening

For the selection of the connection and to ensure a proper connection between the stove and chimney, please read the guide „INSTALLING THE STOVE“ or ask your local chimney sweep.

### Stoves type 1 (BA 1):

- Suitable for multiple occupancy. (Note the different country regulations.)
- These may only be operated with the combustion chamber door closed.
- The combustion chamber door is to be kept closed when the stove is not in operation.
- Fouling of the chimney i.e. deposits of highly inflammable materials such as soot and tar and subsequently fire in the chimney may occur if the chimney is miscalculated and dimensioned wrong.
- If this occurs, disconnect the mains plug. Phone the fire brigade and get yourself and other residents out of harm's way.

#### Note

Your pellet stove has been tested as a room-air independent stove according to EN14785. It can be operated room air dependent or room air independent.

#### ROOM-AIR INDEPENDENT OPERATION:

The stove is certificated for type FC52x / FC62x of the approval principles for the inspection and evaluation of ambient air independent fireplaces specified by the Deutsches Institut für Bautechnik (DIBT) (German Institute for Building Technology). Thanks to an air-tight configuration of the air supply line and flue pipes the stove may be operated in air-tight rooms and in rooms with room-air installations (e.g. controlled ventilation and venting systems, extractors etc.).

#### ROOM-AIR DEPENDENT OPERATION:

In combination with room-air installations (e.g. controlled ventilation and venting systems (extractors etc.) it must be ensured that the stove and the room air system are monitored and safeguarded mutually (e.g. via a differential pressure controller). The combustion air infeed of approx. 20 m<sup>3</sup>/h must be ensured.

Please observe the respective local regulations and rules in consultation with your master chimney sweep. For changes after the printing of this manual, we can not assume any liability. We reserve the right to change without notice.

### 3. BRIEF INFORMATION ON FUEL - PELLETS

#### What are pellets?

Wood pellets are a standardised fuel. Every manufacturer must adhere to certain conditions in order to enable flawless, energy-efficient heating. Pellets are made from wooden waste, from sawmills and planing workshops, as well as from residue from forestry operations. These “starting products” are crushed, dried, and pressed into Pellet “Fuel” without any bonding agent.

#### ENplus – Pellets

This ENplus standard sets benchmarks in the European pellet market. The traceability of pellets is ensured thanks to the use of identification numbers. The pellet manufacturers’ production facilities and manufacturing processes are reviewed every year. A quality assurance system ensures the pellets comply with the requirements of the new standard and that the conditions for trouble-free heating are guaranteed



#### Wood pellet specification according to ENplus – A1

Parameter	Measure	ENplus-A1
diameter	mm	6 (±1) <sup>2)</sup>
length	mm	3,15 bis 40 <sup>3)</sup>
bulk density	kg/m <sup>3</sup>	≥600
calorific value	MJ/kg	≥16,5
water content	Ma.-%	≤10
fine fraction (<3,15mm)	Ma.-%	≤ 1
mechanical rigidity	Ma.-%	≥97,5 <sup>4)</sup>
ash content	Ma.-% <sup>1)</sup>	≤0,7
ash softening temperature	(DT) °C	≥1200
chlorine content	Ma.-% <sup>1)</sup>	≤0,02
sulphur content	Ma.-% <sup>1)</sup>	≤0,03
nitrogen content	Ma.-% <sup>1)</sup>	≤0,3
copper content	mg/kg <sup>1)</sup>	≤10
chrome content	mg/kg <sup>1)</sup>	≤10
arsenic content	mg/kg <sup>1)</sup>	≤1
cadmium content	mg/kg <sup>1)</sup>	≤0,5
mercury content	mg/kg <sup>1)</sup>	≤0,1
lead content	mg/kg <sup>1)</sup>	≤10
nickel content	mg/kg <sup>1)</sup>	≤10
zinc content	mg/kg <sup>1)</sup>	≤100

1) in an anhydrous state

2) diameter must be specified

3) a maximum of 1% of the pellets may be longer than 40 mm, max. length is 45 mm

4) the limit value of ≥97,7 Ma.-% applies when conducting measurements with a lignotester (internal control)

Your pellet stove is only approved for the burning of pellets of tested quality. Please ask your pellet stove dealer for tested fuel and a list of monitored fuel manufacturers.

#### Note

Only burn pellets that have been inspected according to ENplus-A1. Using poor quality or prohibited pellet fuel will have a negative effect on the function of your pellet stove and can also lead to the warranty becoming null and void, as well as the product liability connected with this.

#### Note

Burning straw, maize, woodchips etc. is not permitted! Observe waste incineration legislation! Non-observance of these regulations makes void all warranty and guarantee claims and may impair the safety of the unit!

#### Pellet container refilling during operation

#### Note

CAUTION when filling! Avoid direct contact between the plastic bag and the hot stove. Immediately remove all pellets that have fallen on the hot stove or next to the container!

We recommend always having a suitable amount of pellets in the container to prevent the fire from extinguishing due to a lack of fuel. Check the level frequently. However the container lid should be kept closed, except during filling.

If you refill the container during operation (open the container lid), the fan will speed up and the pellet auger will stop; operation will only be continued once the container lid is closed again (see WARNING AND ERROR MESSAGES)

Pellet container capacity (see Technical Data).

#### Pellet storage

In order to guarantee problem free burning of the wooden pellets, it is imperative necessary to store the fuel as dry as possible and free from impurities.

Pellets should not be kept in sacks outdoors or stored in a manner where they are exposed to the environment. This can lead to blockages in the screw conveyor.

#### Note

“Screw stoppers” are excluded from the warranty.

## 4. TECHNOLOGY AND SAFETY FUNCTIONS

The technological advances in your new combi stove are the result of years of testing and practical experience. The practical advantages of your pellet stove are convincing:

### Operating comfort

The microprocessor-controlled combustion regulation optimises the interaction of flue gas blower and screw using the current combustion chamber temperature. This guarantees optimum combustion and operating status.

All function can be regulated centrally using the integrated operating unit. The intuitive graphic interface permits easy operation; all the settings can be made quickly and simply.

### Top efficiency – lowest emissions

A very great heat exchange surface together with optimum combustion air control leads to excellent fuel utilisation.

Fine continuous pellet dosing in an optimised burner pot made of high-quality grey cast iron leads to virtually complete combustion with very good exhaust gas values - and this is guaranteed in every operating phase.

#### Note

During operation, the flame noise, pellets dropping and actuation of the electronic components are audible due to the automatic control.

### Overheating

A safety temperature limiter (STL) switches the stove off automatically on overheating. Once the stove has cooled, the STB at the stove rear must be unlocked manually (pressed). The stove is ready for operation again after acknowledging the error message at the internal unit.

#### Note

Maintenance and cleaning work must be performed if overheating occurs! If this error recurs, operation without danger is no longer guaranteed; notify customer service immediately.

### Low-temperature shutdown

The unit switches off if the stove cools below a minimum temperature. This switch-off may occur if pellet ignition is delayed.

### Electrical excess current protection

The stove has a main fuse (at the rear) to protect against excess current.

### Automatic cleaning cycle

The speed of the flue gas fan is increased every hour for a short period to blow ash from the burn pot, increasing the operational safety. The status indicator CLEANING appears on the display.

#### Only for stoves with turning grids:

Every 6 hours (interval adjustable) an additionally automatic cleaning cycle is performed. The stove stops, the automatic cleaning tilts the grid and then re-ignites the stove. The status indicator CLEANING appears on the display continuously. The cleaning procedure with tilting the grid is to convey ash and clinker from the burn pot into the ash drawer.

#### Note

This additional function does not replace a manual cleaning as described in CLEANING and MAINTENANCE, as this is absolutely necessary to do regularly.

#### Note

Due to the turning grid there is a certain generation of noise during the automatic cleaning cycle.

### Component monitoring

All the electrical components used are continuously monitored during operation. If a component is defective or can no longer be actuated correctly, then operation is stopped and a warning or error message is issued (see MANUAL TOUCH DISPLAY).

### Auger motor monitoring

Too long or wet pellets as well as pellets with too high dust content (see BRIEF INFORMATION ON FUEL PELLETS) can cause so-called “auger jammers” in the auger channel. This may also happen if the pellets accumulate in the burn pot and the backlog reaches into the chute. The auger motor reacts in both cases with an increased current consumption, which causes the error message: DISCHARGE MOTOR BLOCKED. The stove will be stopped. Please call the customer service immediately.

### Power failure (during heating)

After a brief power failure, the operating functions that were set before the power failure, continues. If the power failure lasts longer, the stove goes to start phase if sufficient temperature or embers are present. If the power failure lasts too long, the stove goes into the stop phase. The flue gas fan continues to burn any pellet residues (approximately 10 minutes). Then it will restart automatically.

### Power failure (during the initial stage)

After a brief power failure the boot process continues. If the power failure lasts longer, the stove is in the stop phase. The flue gas fan continues to burn any pellet residues (approximately 10 minutes). Then it will restart automatically.

## 5. INSTALLING THE STOVE

### General information

**Note**  
Assembly may only be performed by authorised specialist companies.

**Note**  
Please observe the regional safety and building regulations. Please contact your master chimney sweep in this context.

**Note**  
Only use heat-resistant sealing materials as well as corresponding sealing strips, heat-resistant silicon and rock wool.

**Note**  
Also take care that the flue does not project into the free cross-section of the chimney.

**Note**  
In case of room-air independent operation the stove pipe connections must be tightly sealed permanently. Use a heat-proof silicon to position the stove pipe on the conical supports of the flue tube nozzles and for insertion in the chimney flue lining.

**Note**  
The stove should not be pushed on unprotected floors.

**Tip**  
Strong corrugated cardboard, cardboard or e.g. old carpet is useful to assist assembly and as a base. The stove can also be pushed on this cardboard or carpet.

We recommend original flue pipes from RIKA for proper connection.

### Connection to the chimney

- The device must be connected to an approved chimney for solid fuels. The chimney must have a diameter of min. 100mm for pellet stoves and 130mm -150mm for log wood stoves depending on the diameter of the flue pipes.
- Avoid long flue pipes to the chimney. The horizontal length of the flue pipe should not exceed 1.5 m.
- Avoid too many bends of the flue gas pipes. There should not be more than 3 bends in the exhaust pipe.
- If you just can not connect directly to the chimney, please use a connection with a cleaning opening.
- Connections must be made of metal and must meet the requirements of the standard (install the connections airtight).
- Before installing a chimney calculation must be made. The evidence must be performed for single occupancy to EN13384-1 and EN13384-2 for multiple occupancy.
- The maximum draft of the chimney should not exceed 15Pa.
- The derivation of the flue gases must be guaranteed even during a temporary power outage.

**Note**  
If connecting to multiple connection chimneys additional safety equipment is required. Your local chimney sweep will advise you in this case.

**Note**  
Be sure to prevent condensed water from entering via the flue connection. You may need to have a condensate ring installed - ask your chimney sweeping expert for more information. Damages caused by condensate are excluded from manufacturer's warranty.

### Connecting to a steel chimney

The connection must be calculated and shown with EN13384-1 and EN13384-2.

Use only insulated (double) stainless steel tubes (flexible aluminum or steel tubes are not permitted).

An inspection door for regular inspection and cleaning must be present.

The flue pipe connection to the chimney has to be air-tight.

### Combustion air

Every combustion process requires oxygen from the surrounding air. This so-called combustion air is removed from the living area in the case of individual stoves without external air connections.

This air removed must be replaced in the living space. Very tightly sealed windows and doors in modern flats may mean that too little air replaces that used. The situation also becomes problematical due to additional venting in flats (e.g. in the kitchen or WC). If you cannot feed in external combustion air, then air the room several times a day to prevent negative pressure in the room or poor combustion.

### Feeding in external combustion air

*only for devices which are able to run in room-air independent operation.*

- Combustion air must be fed to the stove from outside via a sealed pipe for operation independent of the room air. According to EnEV, it must be possible to shut off the combustion air pipe. The open/closed setting must be clearly recognisable.
- Connect at the air intake either a pipe Ø125mm (log wood and combi stoves) or Ø50mm (pellet stoves) and fix it with a hose clamp (not included!). At pellet stoves with longer intake pipes than 1m the diameter should be increased to 100mm. (see RIKA range).
- To ensure sufficient air intake, the intake pipe should not exceed max. 4m and have max. 3 bends.
- If the line leads outside it must have a windbreak.
- In extreme cold pay attention to icing on the air intake opening (check).
- It is also possible to suction in combustion air directly from another sufficiently vented room (e.g. cellar).
- The combustion air pipe must be tightly connected (adhesive or cement) permanently to the air nozzles of the stove.
- If you do not use the stove for a long time, please close the combustion air intake to prevent the stove from moisture.

**Note**  
Please note that problems may arise due to updrafts in the case of combustion air supply from an integrated chimney ventilation shaft. If the combustion air flowing downwards is heated it may rise and thus counter the chimney with a resistance which in turn reduces the negative pressure in the combustion chamber. The chimney manufacturer is to guarantee that the resistance for the combustion air is a maximum 2 Pa even in the least favourable operating state of the chimney.

*If one or more of these conditions does NOT apply, the result is poor combustion in the stove and negative pressure in the installation room.*

## 6. ASSEMBLY/DISMANTLING STONE AND OPTIONS

### Note

Only work on the unit when the mains plug has been disconnected and the stove has cooled completely.

### Note

During assembly / dismantling do not allow objects (screws etc.) to fall into the pellet container – they can block the screw conveyor and damage the stove.

### Note

During any conversion work, take particular care of your fingers and any panels and stove attachments.  
Select soft bases to prevent scratches to your living space furniture and stove panels.

### Disassembly of the front side casing

Remove the convection fins by lifting slightly. The convection fins are only suspended.

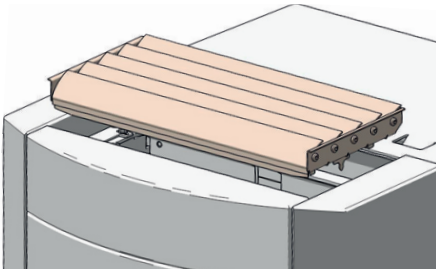

Now remove the upper hexagon screw on the front stone holder and loosen the bottom two.

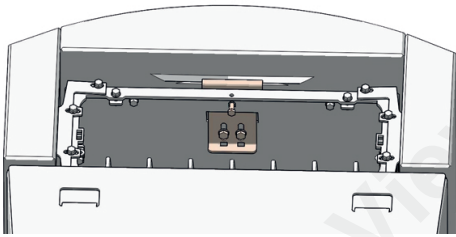

You can now lift the front stone.

Now remove the 8 hexagonal screws used to attach the two side stone holder. You can then remove the side stones.

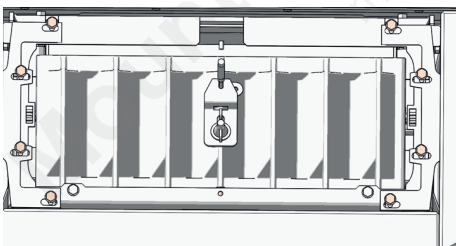

Install the removed parts in reverse order.

### Disassembly of the rear side panel

Open the container lid.

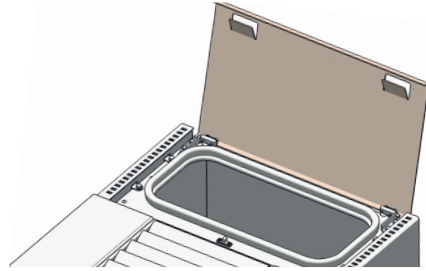

Remove the 2 vertical hexagonal screws used to attach the right rear side panel.

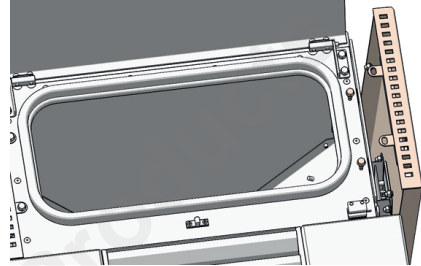

You can now lift the right rear side panel.

Install the removed parts in reverse order.

The disassembly of the left rear side panel is analogous to removing the right rear side panel.

## 7. COMFORT OPTIONS

### *Room sensor, Radio room sensor*

This option permits control of your stove via room temperature. You can set both the room temperature and the heating times required. A room temperature selected by you is observed during the heating times.

Please see the operating instructions for the option room sensor and wireless room sensor for more detailed information.

### *GSM Control*

Your stove can also be controlled via a mobile phone as an additional option.

Please see the operating instructions for the telephone option – GSM for more detailed information.

### *Interface for various options*

*for various options*

The ROOM SENSOR, the WIRELESS ROOM SENSOR and the PHONE OPTION – GSM are to be connected to the interface (stove rear) using the connection cable supplied.

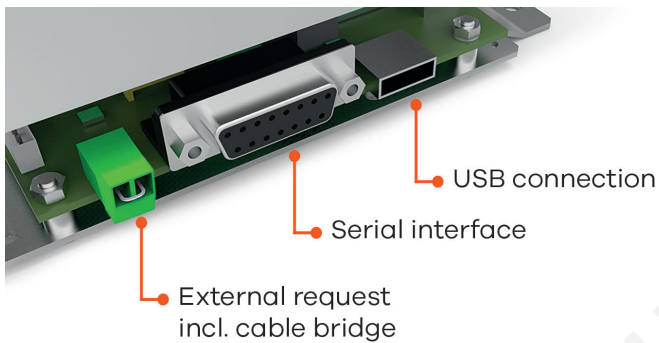

*(condition as delivered)*

### *External room thermostat*

Your stove has an interface on the rear wall to which you can connect a customary room thermostat. This requires a 2-pole cable of 0.5 – 0.75 mm<sup>2</sup> cross-section that you have to connect instead of the cable bridge fitted for delivery.

### *External connection cable bridge*

If the control of your stove is to be assumed by an external room thermostat, you have to connect your external room thermostat (1) instead of the standard integrated cable bridge (2).

The connected room thermostat can be operated in either MANUAL or AUTOMATIC MODE. In both MODES, the current set heat output is used, in AUTOMATIC MODE the heating times set at the stove can also be activated.

You can see whether the external demand is currently activated in the INFO main menu in submenu item Info - inputs.

If your stove receives an external demand to stop operation, it takes approx. 5 minutes until it switches off. All further settings required to your thermostat can be taken from the respective room thermostat operating instructions.

#### **Note**

Operation is not possible unless either a cable bridge or an external room thermostat is connected. The external demand has priority over all operating modes (MANUAL/AUTOMATIC/COMFORT).

### *Option firenet*

*Only for combination and pellet stoves with touch panel version V2.16 or higher.*

The firenet module connects your stove to the Internet. You can operate the stove with any Internet-enabled device (tablet, PC, Smartphone ...). So you retrieve the operational status, various information and make your settings remotely.

For further information, please contact your dealer.

## 8. MAINTENANCE

The frequency with which the stove requires cleaning and the maintenance intervals depend on the fuel you use. High moisture content, ash, dust and chips may more than double the maintenance required. We would like to point out again that only tested and recommended pellets may be used as fuel.

### Tip

Wood as fertiliser - the mineral content of the wood remains in the combustion chamber as ash as a residue of the combustion. This is an excellent fertiliser for all plants in the garden; it is a completely natural product. The ash should be stored first and slaked with water.



### Note

Ash may contain embers – only place ash in steel sheet containers!



### Open the combustion chamber door

To open or close the combustion chamber door use the included key. This key can be stored on the back of the stove when not in use.

### Cleaning of the burn pot - daily

Make sure that the air vents are not blocked with ash or clinker. Remove the clinker using the supplied brush and vacuum the burn pot. The burn pot can be easily cleaned inside the stove. After removing the pot the area underneath can be vacuum-cleaned.



Do not damage the ignition when cleaning with the brush.

### Note

Clean the fire trough regularly. Only clean when cold, when embers are extinguished!



### Note

If the stove is heated in continuous operation, it must be cleaned 2x within 24 hours. FIRE HAZARD!



### Cleaning the flame temperature sensor

Remove the dust deposits from the sensor at regular intervals. Use a clean cleaning cloth or newspaper.

### Empty the ash drawer

Empty the ash drawer regularly. The ash drawer is simply pulled forward with the combustion chamber door open.

### Cleaning the door glass

The viewing window becomes coated in the case of solid fuels, particularly with the very fine ash of wood pellets, light or dark depending on the pellet quality (especially with low output). The glass can be cleaned best with a moist cloth. Stubborn dirt can be removed with a special cleaner available from your stove dealer. Usual cleaners containing acid or solvents can be too harsh and damage the glass.

### Cleaning painted surfaces

Wipe the painted surfaces with a damp cloth, do not scrub. Do not use solvent-containing cleaners.

## 9. CLEANING

### Tip

Your RIKA dealer will gladly advise you about their service and maintenance offers.

Depending on pellet consumption, a message prompting cleaning of the stove appears on the display in regular intervals. This message can be acknowledged on the Touch Display, while continuing operation. Perform a cleaning cycle at the next opportunity.

Subsequently, reset the counter in the SETTINGS menu / RESETS submenu, as per operating instructions of TOUCH DISPLAY.

### Tip

The message will only stop reappearing once you have reset the feed volume in the SETTINGS / Resets menu.

### Note

Your stove must be switched off and cooled before any maintenance work is performed. Only work on the unit when the mains plug has been disconnected.

### Cleaning the convection air openings

Vacuum clean any dust deposits from the convection air openings at regular intervals.

The stove should be cleaned thoroughly prior to the start of the heating season to prevent excess odour.

### Note

To prevent your stove from overheating of the internal components, do never cover the convection fins!

### Combustion air – intake

If necessary, please also clean the air intake with a Hoover.

### Note

Only when the stove is cold! You could vacuum out embers – FIRE RISK!

### Cleaning the pellet container

Do not refill the completely empty container immediately; remove the residues (dust, chippings etc.) from the empty container. The unit must be disconnected from the mains!

### Clean flue gas fan housing

To inspect and clean the flue gas fan, the back wall has to be removed.

The four screws that secure the flue gas fan motor have to be opened and the motor is carefully to pull out of the case.

Remove with a vacuum cleaner the ash from the fan and flue gas pipes. When closing again definitely pay attention to leaks.

For cleaning the flue pipe connection, pull the flue pipe from the flue gas fan and vacuum the blower housing.

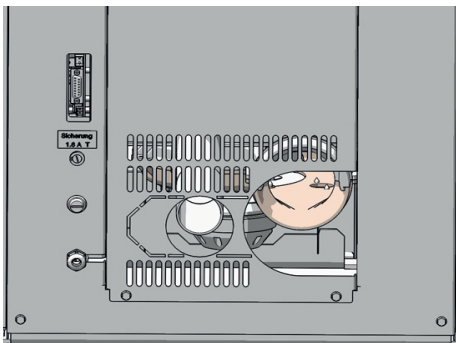

### Cleaning flue pipes

The flue gas fan and the flue pipe connection should be cleaned at least 2 times a year, or after about 700 kg of pellets. The flue gas passes are situated on the side of the combustion chamber, the flue gas duct is located in the lower region of the combustion chamber.

Remove the convection fins by lifting slightly. The convection fins are only suspended.

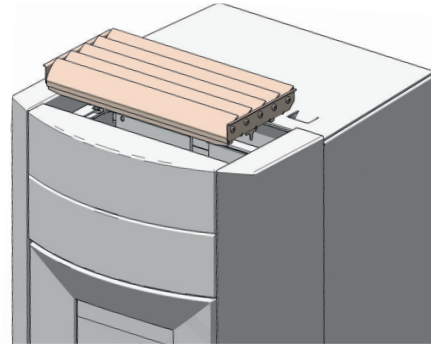

Open the screw of the sensor tube with an open end wrench #19 and remove the flame temperature sensor and the sensor tube.

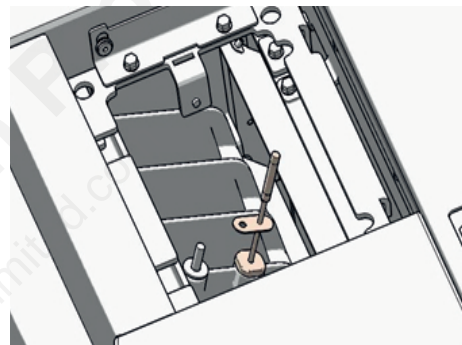

Open and remove the wing nut, which serves to secure the firebox lid. For ease of disassembly, you should hold up the screw through the combustion chamber.

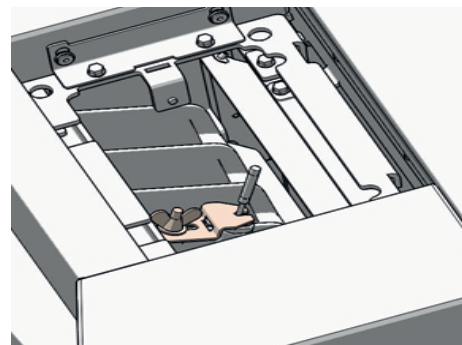

You can now lift off the combustion chamber lid.

Now clean the flue gas passes on the left and right of the combustion chamber with the supplied wire brush.

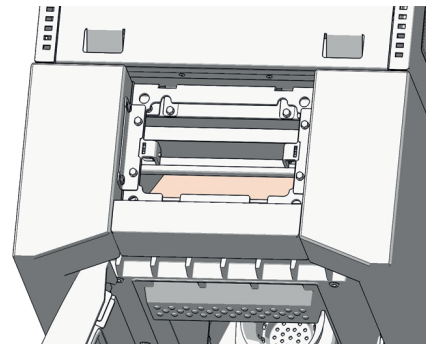

Vacuum clean the exposed interior and the side passages of impurities.

Install the removed parts in reverse order again.

## Clean flue gas collecting channel

Open the firebox door.

Loosen the two hex head screws and remove the lower front panel.



Remove the cover plate by opening the two outer hexagon screw.

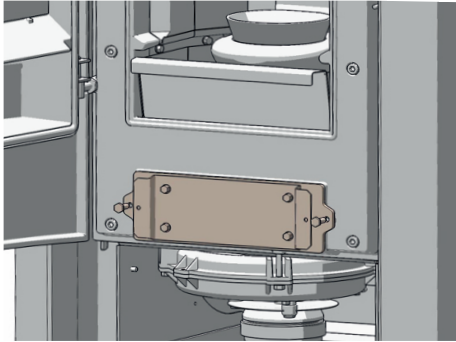

Vacuum clean the combustion residues from the flue gas collection channel.

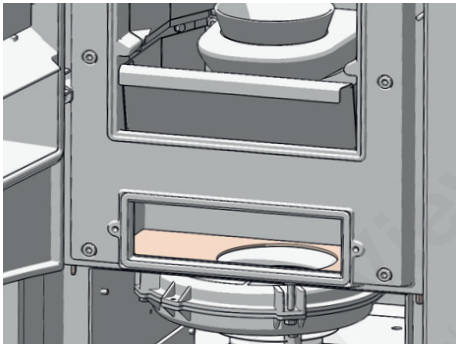

Install the removed parts in reverse order.

### Note

Your stove may suck in false air via incorrectly sealed cleaning covers; this air may lead to incomplete combustion in the fire trough and thus piling up of pellets. DANGER of FIRE!

To ensure the proper operation of your pellet stove, replace any defect (porous, frayed) seals after cleaning and maintenance.

## Cleaning the flue pipes

(annually)

Remove the flue pipes. Inspect and clean the chimney connection. Brush off any soot and dust deposits in the fire and in the flue pipes and vacuum.

### Note

Accumulated fly ash in the flue gas channels may impair the performance of the stove and pose a safety risk.

## Bearings

(annually)

All built-in bearings (pellet screw) should be checked. Clean or replace bearings depending on condition.

## Checking door seal

(annually)

The condition of the seals at doors and glass should be checked at least once a year. Repair or replace seals depending on condition.

### Note

Only intact seals ensure your stove works perfectly!

## 10. PROBLEMS - POSSIBLE SOLUTIONS

### Problem 1

---

Fire burns with weak, orange flame. Pellets heap up in fire trough, window soots up.

#### Cause(s)

- Insufficient combustion air
- Poor chimney draught
- Stove is sooted over inside

#### Possible solutions

- Remove any ash or clinker from the fire trough that may block the air inlets. (see CLEANING and MAINTENANCE)
- If possible swap to better pellet quality.
- Check whether flue gas pipes are blocked with ash (see CLEANING and MAINTENANCE).
- Check whether the air intake or flue tubes are blocked.
- Check door and cleaning cover seals for leaks (see CLEANING and MAINTENANCE)
- Clean fan (see CLEANING and MAINTENANCE)
- Have service performed by authorised specialist company.
- The window has to be cleaned from time to time (see CLEANING and MAINTENANCE)

### Problem 2

---

Stove smells strongly and smokes outside.

#### Cause(s)

- Burning-in phase (taking into service)
- Stove has accumulated dust and/or dirt

#### Possible solutions

- Wait to end of burning-in phase and vent the room sufficiently.
- Vacuum off any dust deposits from the convection air openings at regular intervals

### Problem 3

---

Flue gas discharge when wood is added and during heating phase.

#### Cause(s)

- Leaking cleaning openings
- Chimney draught too low
- Leaking flue pipe connection

#### Possible solutions

- Check seals and replace (fire door, cleaning lid, ..)
- Check chimney
- Check connections and if necessary re-seal

#### Note

Please note that checks on the control system and wiring may only be performed in unit switched dead. Any repairs may only be performed by trained specialists.

#### Tip

If a malfunction message occurs, the cause must first be remedied; the unit can be put back into operation by acknowledging the malfunction at the internal unit.

# 11. INSTRUCTIONS FOR COMMISSIONING PROTOCOL

## FOR PELLET AND COMBI STOVES

The commissioning protocol is to be treated as a document and serves as the basis for the warranty and guarantee terms. It is to be completed entirely, in particular the stove data and addresses, the work to be performed is to be ticked off after completion. The signatories confirm with their signatures that all the items on the list have been concluded properly.

### Note

Please return 1 completed protocol for putting into service to RIKA Innovative Ofentechnik GmbH, Müllerviertel 20, 4563 Micheldorf, Austria.

### Electrical periphery

It is important that the connection socket in the electrical periphery is earthed. The operability of any room thermostat present must be checked. The execution of commands is to be established by phoning in the case of a GSM modem.

### Exhaust gas system

The exhaust line, stove and combustion air inlet are part of the combustion system as a whole; therefore the correct execution must also be checked. The plug connections should be tight in general since the system works with excess pressure. The exhaust tube has a diameter of 100mm for pellet stove, and of 150 mm for the combi stove, which is sufficient for short distances. In the case of several changes in direction, the resistance of the exhaust system can increase with the flue to such an extent that the combustion quality suffers and/or noise arises from the greater flow speed. Correct determination of the chimney draught can only be performed at nominal thermal output and serves to evaluate the chimney. If the draught is more than 15 Pa, then a draught limiter should be installed.

### Stove functions

These are the basic stove functions that are to be checked and ticked off. The stove is ready for operation if these functions are ensured.

### Operator instruction

This is one of the most important points in the putting into operation. It is very important that the operator understands the stove properly and is prepared to assume responsibility for the basic tasks required for operational safety.

In particular the connection between special features of a biomass heating system and his obligations as well as the warranty and guarantee terms must be explained. e.g. non-tested pellets and screw blockers, lack of cleaning or maintenance and stove malfunctions. Thorough instruction can prevent many complaints.

### Stove functions

Explanation of the processes in the stove during ignition, normal operation, cleaning phase etc.

### Control

Explain operator's possibilities to intervene, empty pellet container, room thermostat, GSM modem, functions and settings, program times if necessary. Operating instructions: Handover and reference to the content to the following points, is a document.

### Warranty terms

Difference between warranty (statutory) and guarantee (voluntary), terms of guarantee, determination of wearing parts, reference to pellet quality to be used and the consequences of poor quality.

### Cleaning instructions

Ash and dust occurs with a biomass heating unit. The fire trough is to be cleaned regularly with regular heating operation (in the case of pellet operation, the drilled air holes in particular must be free of residues). The ash drawer is to be emptied regularly. The flue gas pipes are to be cleaned once or twice in the heating season depending on stove type; by a specialist company is best.

### Maintenance

Maintenance work after defined burn-off output is to be performed by specialist company, including thorough cleaning.

### Combustion

All doors must close tightly to prevent intake of false air.

**Note**

Please contact your warranty partner for any warranty questions or claims. This is your dealer or installation company. No warranty claims can be accepted without proper putting into operation, proper operation according to the operating instructions and the supplements in this information sheet.

**Protocol for putting into operation for RIKA pellet and combi stoves**

Date: \_\_\_\_\_

Installation address	Dealer
Name: _____	Name: _____
Street: _____	Street: _____
City: _____	City: _____
Telephone: _____	Telephone: _____

**Stove data**

Stove type:	Casing undamaged
Serial number:	Operating instructions
Software version:	Warranty documents
Touchdisplay version:	Door opener

**Electrical periphery**

Connection socket earthed	GSM modem present
Room thermostat present	Function checked

**Check of system components**

Combustion chamber door seal checked	Ease of movement burnback flap checked (combi)
Ease of movement flue gas flap checked (combi)	

**Exhaust line / chimney**

Diameter	Connection leakproof
Bends	Chimney draught

**Stove functions**

Pellet container filled	Grid turns (360°) und keeps in heating position
Tested pellet quality according to Önorm/DIN plus/ENplus-A1	Ignition element glows
Electrical connections made	Screw motors run
Safety flaps tightened (combi)	Do pellets fall into the combustion chamber?
Induced draught blower runs	Ignition performed
Stove was switched off when handed over	

**Operator instruction**

Stove function	Warranty terms
Control	Cleaning
Operating instructions	Cleaning or maintenance interval

*work performed correctly according to order placed*\_\_\_\_\_  
Technician:\_\_\_\_\_  
Operator\_\_\_\_\_  
Client

Company: \_\_\_\_\_

## 12. WARRANTY

These warranty conditions are only valid for the following countries: Austria, Germany and Switzerland. Separate conditions imposed by the importer apply for all other countries. In case of doubt as well as missing or incorrect translations, the German version is the only valid one.

For the purpose of timely damage limitation the claimant is required to file the warranty claim with the RIKA dealer in writing, submitting the invoice and stating the purchase date, model name, serial number and reason for complaint.

### Warranty

5 years on the welded stove body. This exclusively applies to defects in materials and workmanship as well as free replacement. Labour and travel times are not included in the manufacturer's warranty.

Only original parts supplied by the manufacturer should be used. Loss of warranty on non-observance!

The precondition for the warranty is that the stove has been installed and commissioned properly according to the User and installation manuals valid at the time of purchase. Connection must be performed by a specialist for such stoves.

Any costs incurred by the manufacturer due to unjustified warranty claims are to be charged to the claimant.

**Wear parts and parts affected by fire are excluded, such as glass, coating, surface coatings (e.g. handles, panels), seals, fire trough, grates, draught plates, deflector plates, combustion chamber liners (e.g. fireclay), ceramics, natural stone, thermo stone, ignition elements, sensors, combustion chamber sensors and temperature controller.**

Also excluded from this warranty are all damages arising from non-observance of the manufacturer's operating instructions of the unit, or damage caused by overheating, use of nonapproved fuels, unauthorised tampering with the appliance or the flue gas pipe, electrical excess voltage, an incorrect, insufficient or excessive flue draught, condensation, non-performance or deficient maintenance and cleaning, nonobservance of the relevant and applicable building regulations, incorrect operation by the user or third parties, as well as any transport and handling damage.

**This manufacturer's warranty does not affect the statutory warranty provisions.**

02.12.2015

Mountain View Hearth Products  
manuals.stove-parts-unlimited.com





Technical and design changes, as well as typesetting and printing errors reserved

© 2017 | RIKA Innovative Ofentechnik GmbH

Mountain View Hearth Products  
manuals.stove-parts-unlimited.com



RIKA Innovative Ofentechnik GmbH  
4563 Micheldorf/Austria, Müllerviertel 20  
Telefon: +43 7582 686-41, Fax-DW: 43  
E-Mail: [verkauf@rika.at](mailto:verkauf@rika.at)

**RIKA.AT**

Z35958\_EN\_Revo\_Touch | 12.10.2017