

M55 FS STEEL - QUICK REFERENCE GUIDE

M55 Steel Control Panel Operation

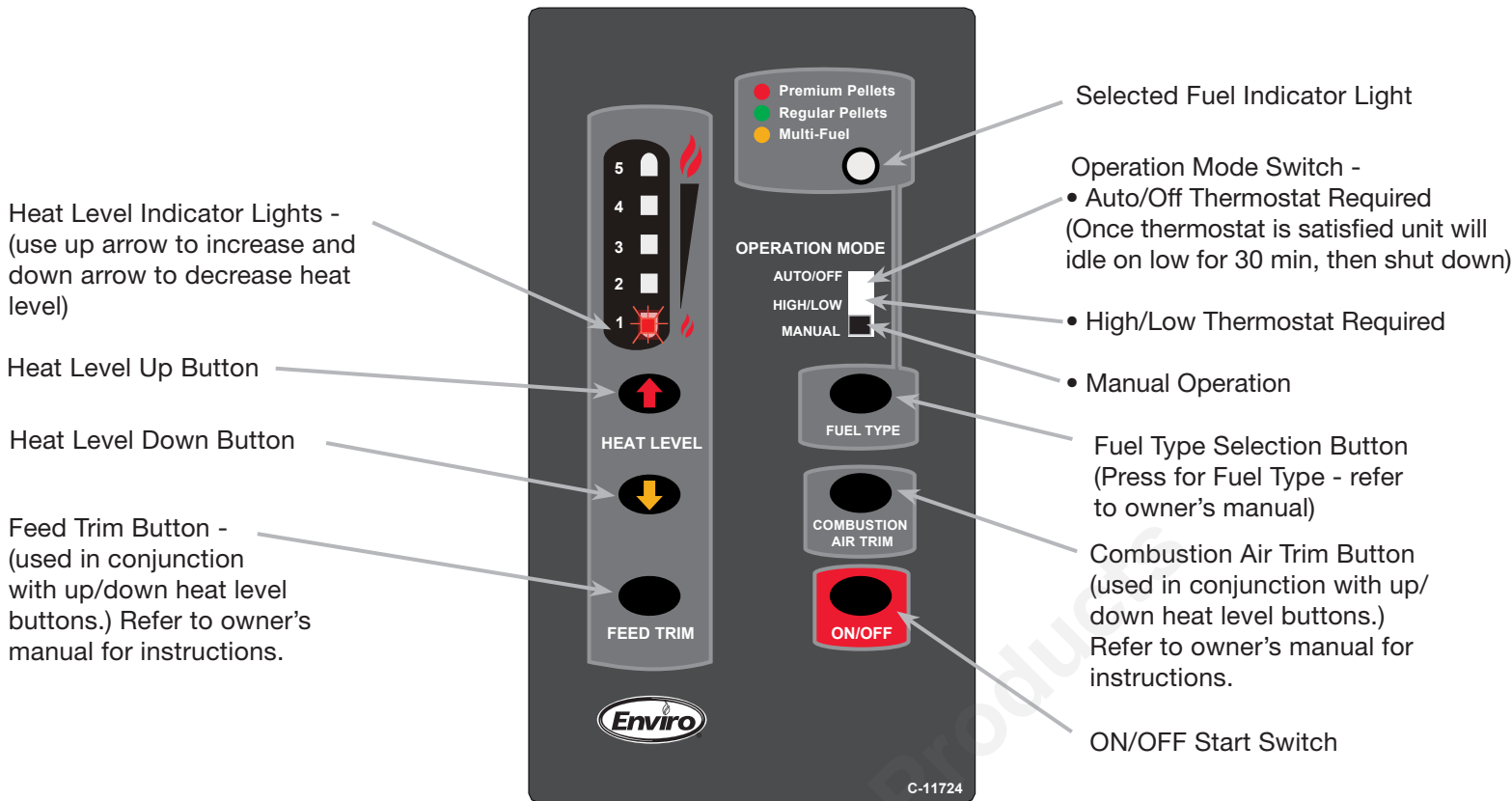

Error Flash Codes - Troubleshooting Guide for the M55 FS Steel.

(This is a reference only - please see Owner's Manual for full instructions.)

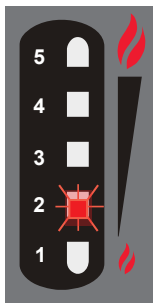

For a **flashing #2** Heat Level Light (indicates loss of vacuum) check the following -

- Make sure the firebox door is latched and sealed.
- Make sure ash pan is closed and sealed.
- Make sure unit and venting is clear of fly ash.
- If #2 light continues to flash contact your dealer or your service technician.

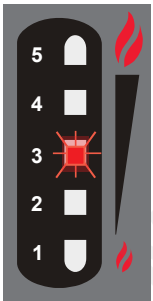

For a **flashing #3** Heat Level Light (indicates exhaust temperature sensor is not at operating temperature) check the following -

- Make sure there are pellets in the hopper.
- Make sure burn pot liner is positioned correctly and clean.
- If #3 light continues to flash contact your dealer or your service technician.

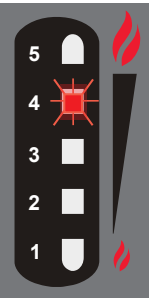

For a **flashing #4** Heat Level Light (indicates that the high-limit sensor has tripped or the hopper lid sensor has failed to detect the lid magnet) check the following -

- Make sure hopper lid is closed.
- Make sure high-limit sensor has been reset (see below).
- If #4 light continues to flash contact your dealer or your service technician.

To Reset the High-Limit Sensor

(See Owner's Manual for details)

- 1 - Unplug unit
- 2 - Open hopper lid
- 2 - Remove stove top
- 3 - Push high-limit reset button (if tripped you should feel a click when resetting)
- 4 - If #4 light continues to flash contact your dealer or your service technician.

High-Limit
Sensor
Location

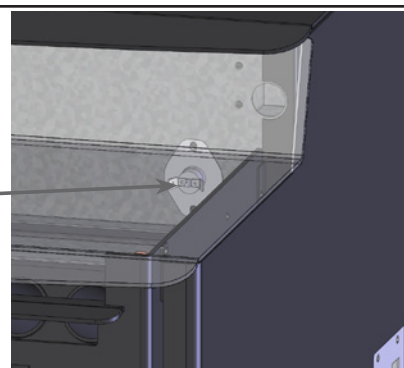

Control Panel



C-123510

Sherwood Industries Ltd., November 2010