

# Glass Assembly Instructions

Tadpole gasket replacement instructions for:

Castile

Castile Insert

Santa Fe

Santa Fe Insert

Mt Vernon (non AE)

## Step 1

Note the amount of gasket still showing of the edge of the glass. About half.

Start on corner of short side taking the gasket down the side of the glass. Take tape backing off as you go otherwise the gasket will stick together.

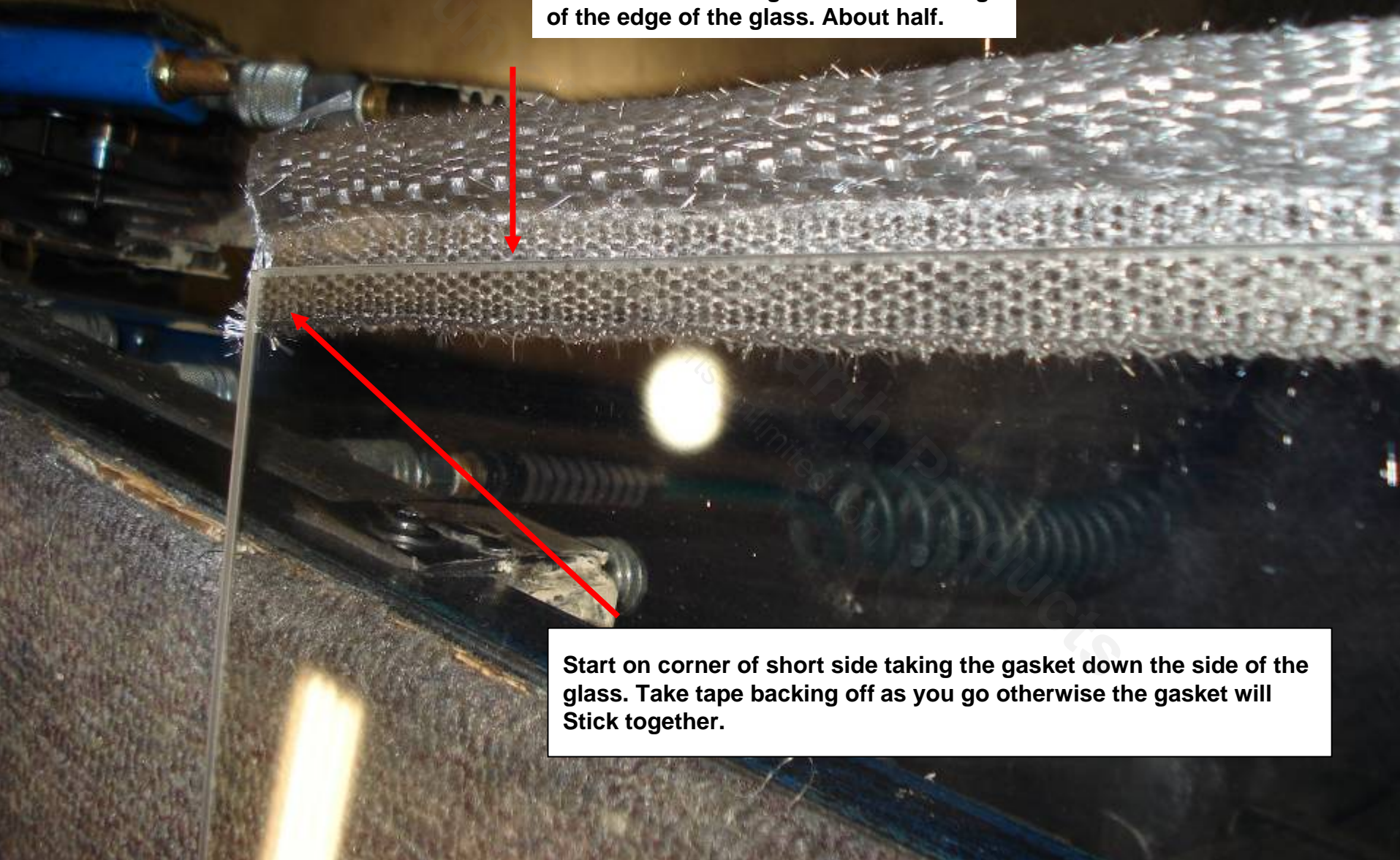

## Step 2

When you get to the first corner it will need to be cut in order to go around the glass, and to close properly. Do not cut the thick Tadpole, only the flat part of the gasket.

when cut this way it makes a much nicer corner however, a V shape can be cut in the flat gasket and work as well.

3 3:00 PM

### Step 3

Wrap gasket around corner and continue to the next corner, cutting to wrap the gasket around the glass. Continue to the end of the short side of the glass.

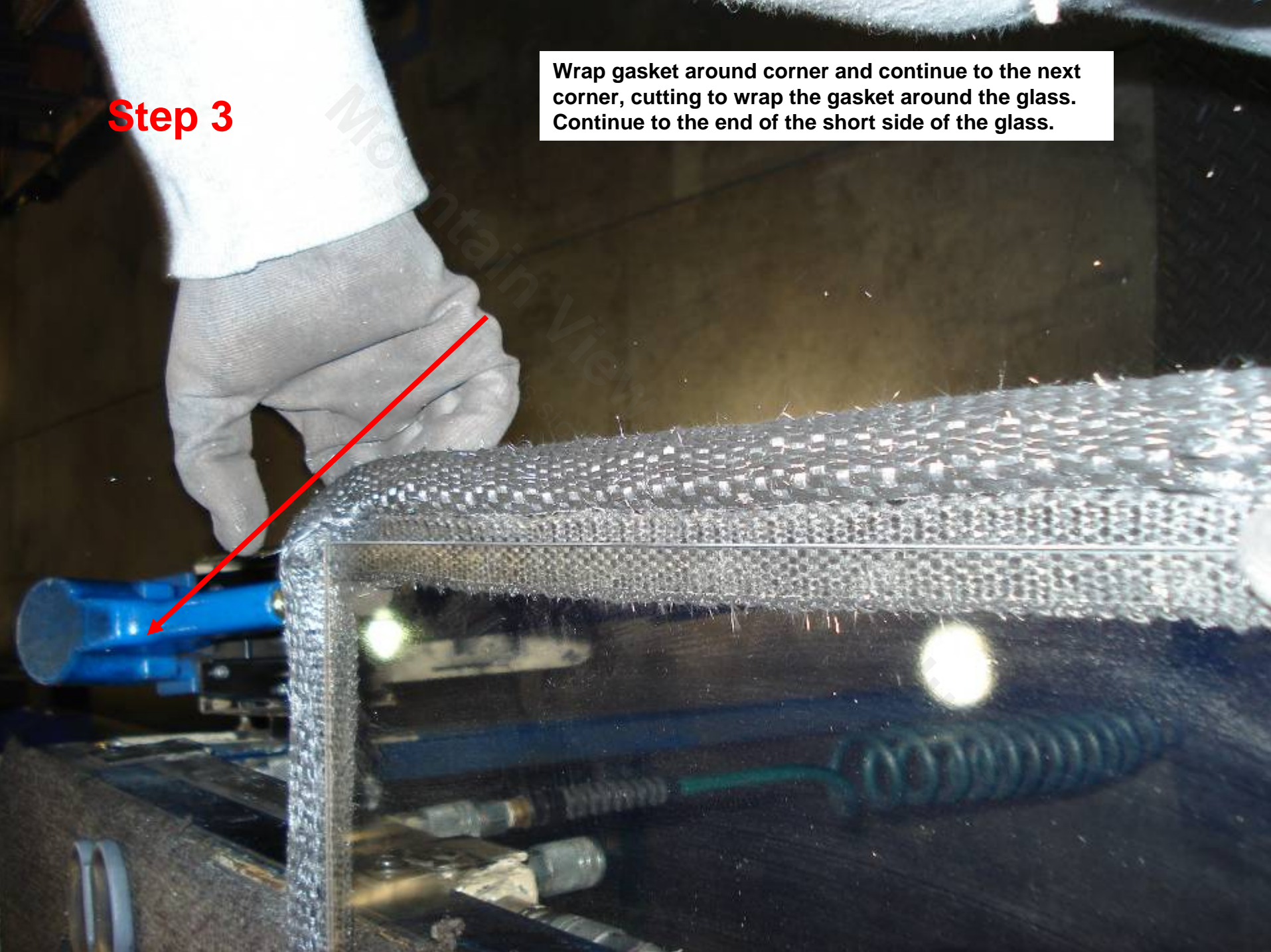

## Step 4



Cut at end of glass  
straight across.

Note: Do not wrap around last long side of  
glass.

## Step 5



After placing tadpole gasket on glass, it should only have one side remaining without gasket.

Step 6

Turn glass over, place flat glass tape on bare end of glass.  
Touch end of gasket to tadpole gasket on each end.



3 3:03 PM

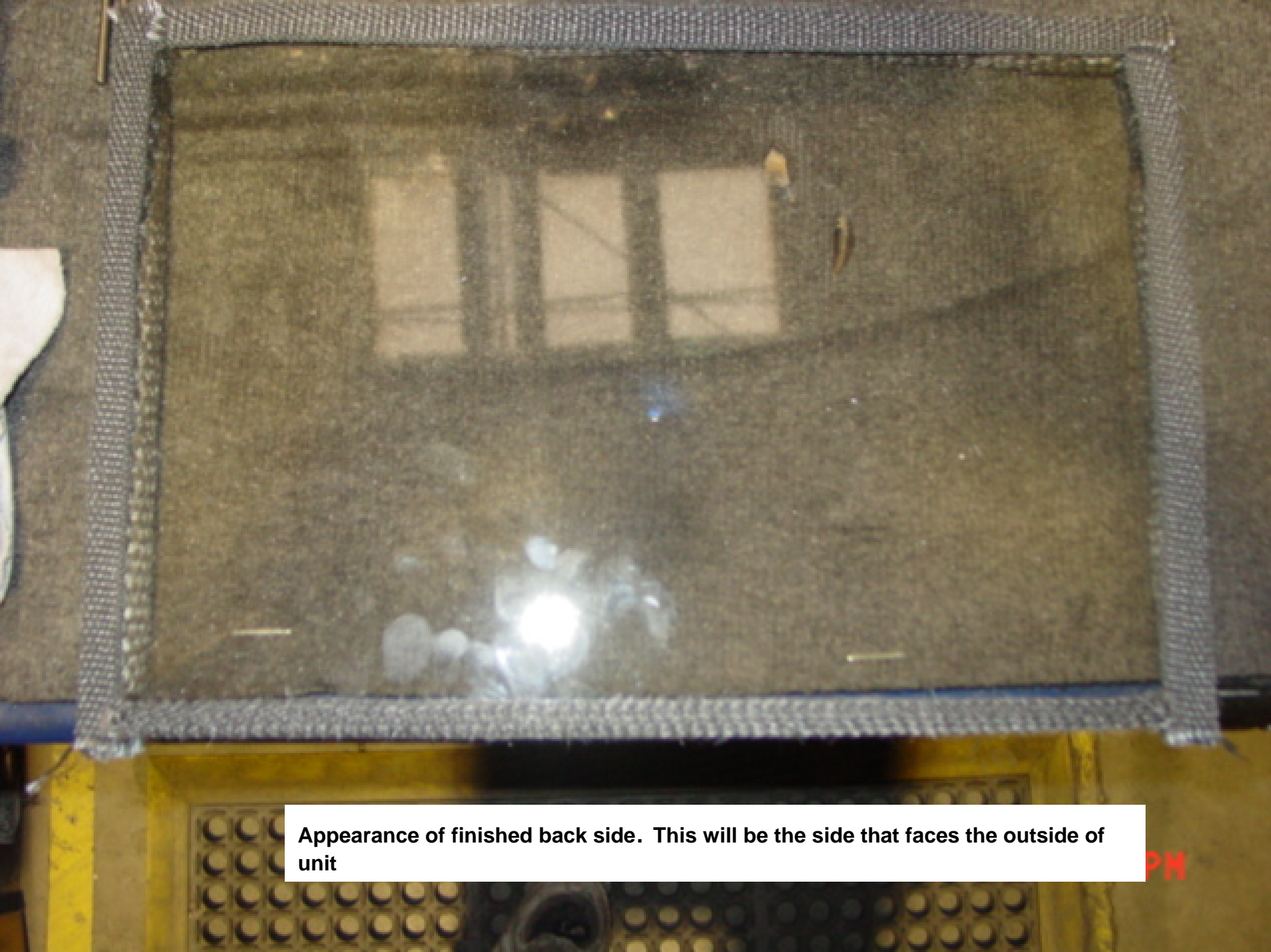

**Appearance of finished back side. This will be the side that faces the outside of unit**

## Step 7

After placing tadpole gasket on the glass, cut a small piece of 3m tape, place on end of tadpole gasket across the bottom

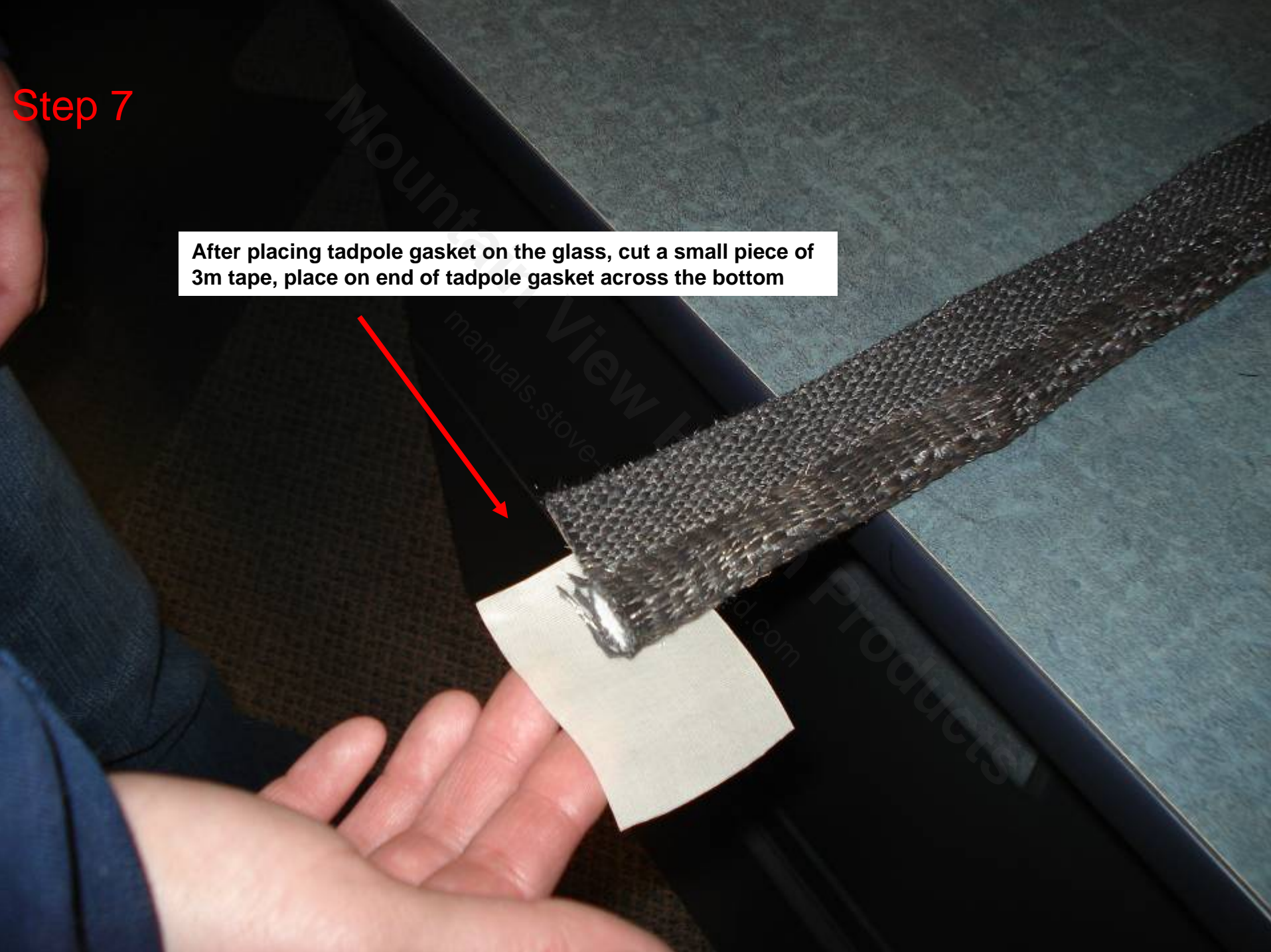
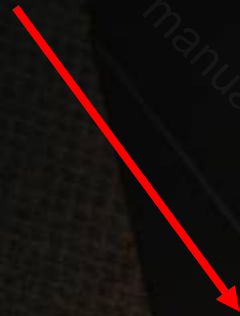

## Step 8



Fold tape over front

**Note:** This tape only goes over the tadpole gasket, not on the glass.

Step 9



Fold tape over top of tadpole gasket

Step 10

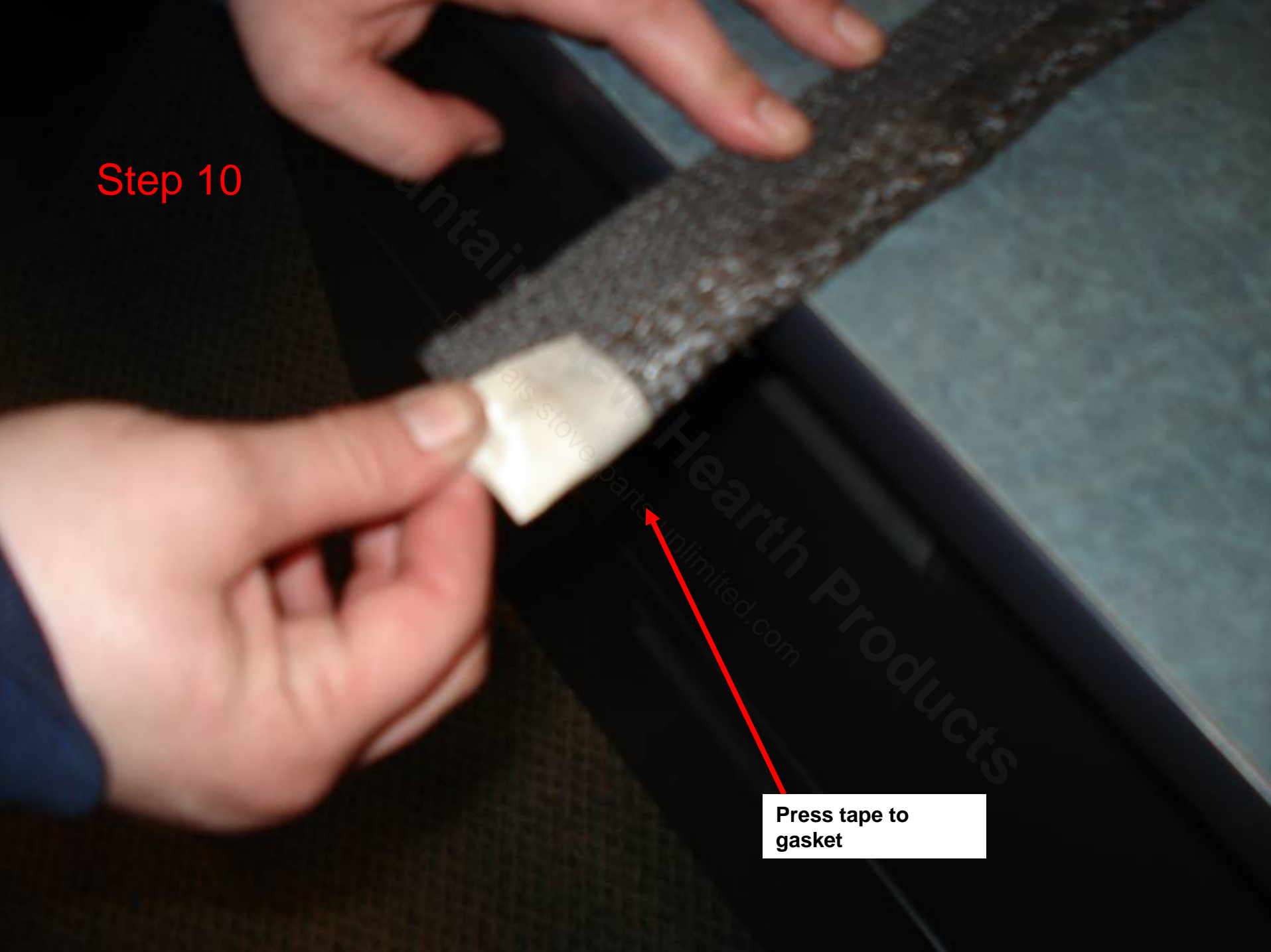

Press tape to  
gasket

**This is how it should appear when finished**



**This is where the 3M tape will be on a finished piece of glass**



3 3:06 PM