

# START-UP TIMING BLOCK REPLACEMENT INSTRUCTIONS

## CHECK CONDITION OF SHIPMENT

Upon receipt of this kit, check the condition of the packaging. Damage to the package should be noted on the carrier's freight receipt. Any damage claims as a result of shipping must be handled through the shipper. Travis Industries will provide assistance in resolving shipping claims or replacing items not included in the package. Please report any missing items immediately.

## COMPATIBILITY

- Avalon 900 PS & PI
- Lopi 400 PS & PI
- Elan PS

## ITEMS NEEDED FOR ASSEMBLY

- Standard & Phillips Head Screwdriver

## PACKING LIST

- Start-up Timing Block
- Jumper Wire (for 1992 or earlier models only)

## INSTALLATION INSTRUCTIONS

All Travis Industries pellet stoves utilize a start-up timing block to allow for shut down if the pellet heater does not start. Older models used the ACP timing block, newer models the Airotronics. The replacement timing block is an Airotronics timing block, but it can be used on older heaters. Follow the instructions below to install.

1. Unplug the heater. Remove the left side access panel.
2. For 1990 models the start-up timing block is exposed. Later models have the timing block inside the control box. Remove the control box and access its interior by removing the phillips head screw that holds the cover plate in place.
3. Mark each wire leading from the start-up timing block with the corresponding number next to the post it attaches to. See the illustration below to see what the start-up timing block looks like. Remove the old start-up timing block by unscrewing the screw or nut in the center of the timing block.

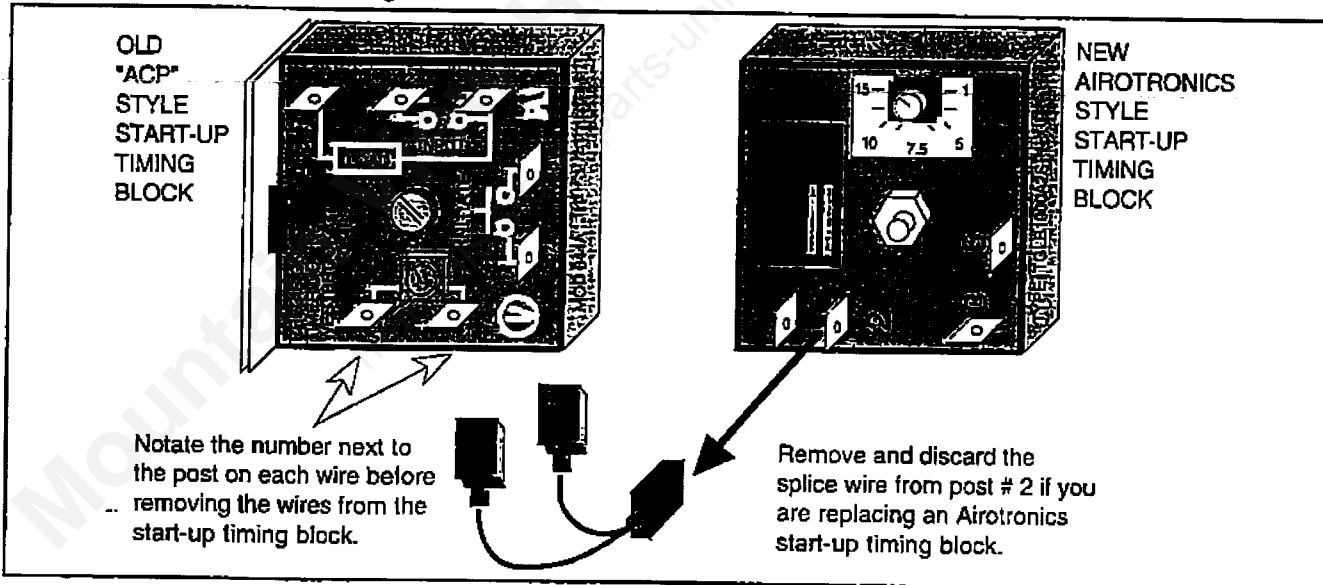

4. If you are replacing an Airotronics timing block, remove and discard the splice wire attached to the new start-up timing block. Attach the timing block to the pellet heater, replacing the green ground wire and washers as originally installed.
5. If you are replacing an Airotronics timing block, replace the wires to the same posts that they were removed from. If you are replacing an ACP start-up timing block, follow the table below to attach the wires to the new start-up timing block (NOTE: the two wires that led to post # 2 and post # 7 now attach to the splice wire).

Wire Attached to "ACP" Start-Up Timing Block	Post # 1	Post # 2	Post # 3	Post # 4 (Not Used)	Post # 5 (Not Used)	Post # 6	Post # 7
<b>GOES TO</b>	↓	↓	↓			↓	↓
New "Airotronics" Start-Up Timing Block	Post # 1	Post # 2 (Splice Wire)	Post # 3			Post # 5	Post # 2 (Splice Wire)

