

The PR-SR2543 door latch kit comes with 7 parts:

Vertical door latch = orange arrow

Door roller pin = purple

Door rod = yellow

2 keeper screws = green

2 keeper clips = blue arrows in drawing on page 3

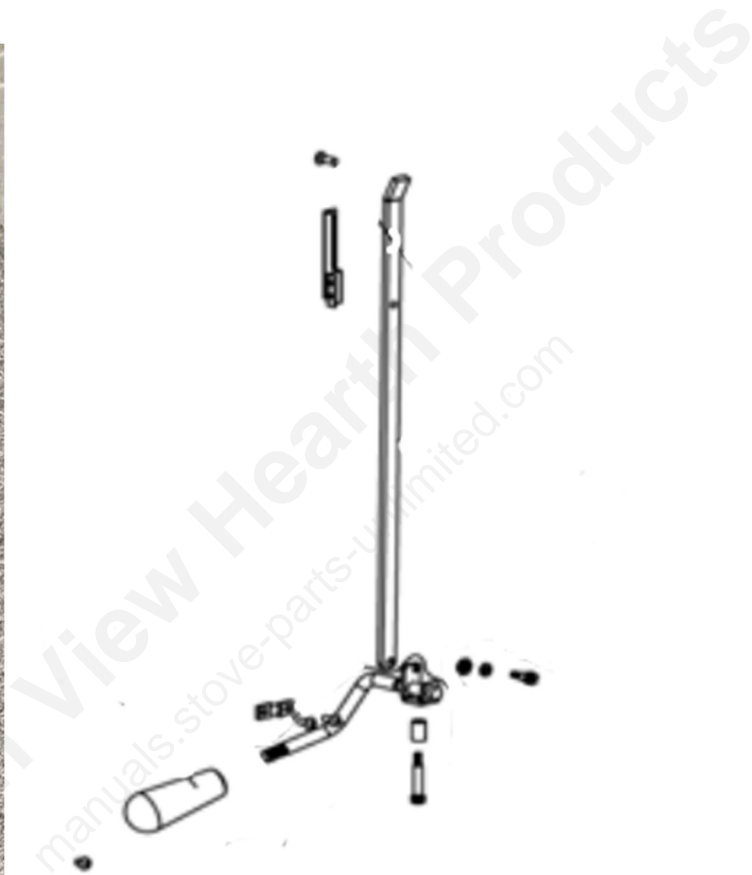

Insert non-threaded end of door rod through the right door and then through the vertical latch bracket and then screw the roller pin into the hole in the end of the door rod.



Mountain View Hearth Products
manuals.stove-parts-unlimited.com

Note the slot in the door rod below pointed out with red arrow.

The keeper clips (pointed out with blue in drawing below and the picture on the next page) that are screwed to the inside of the door behind the gasket engage this slot to keep the door rod from pulling out of the door frame.

