

## BRICK INSTALLATION

### PERFORMER™ C/A210 BRICK INSTALLATION

**CAUTION:** Wear gloves during brick installation in case of sharp edges behind the stove.

**Note:** Installation of the baffle bricks and insulating blanket is easier when you can still access the flue outlet, (before connecting the flue pipe). **Be sure the insulating blanket is placed flat on the bricks so as not to block the flue.** Use a ruler or a piece of kindling to reach over the blanket to be sure it is completely flat on top of the baffle bricks.

Measure bricks before installing, as per list of dimensions on next page, to be sure the correct bricks are installed in the correct location.

1. Install bricks #1-26 in the numbered sequence shown in Figure 1.

**Important:** The secondary burn tubes at the top of the firebox are supported by a metal bracket. Move this bracket so it is centered left and right on the tubes. Also make sure the small supporting brackets on the front and rear tubes are centered and hanging from the steel rods at the front and rear of the stove.

2. Next install bricks #27-38 on top of the stainless steel secondary burn tubes (Figures 2 & 3) in the upper part of the firebox. Bricks #27-32 fit up against the back wall of the firebox and rest on top of bricks #24-26 and the rear tube. The steel support hanger should be centered between the sets of baffle bricks as shown in Figures 5 and 6.
3. Included with the stove are two 15-1/4" x 12" x 1/2" thick insulating blankets. Install one blanket above the baffle brick and to each side of the support bracket.
4. Next, install the front baffle bricks #33-38 under the blanket and on top of the front two secondary tubes. Make sure that the blankets are centered side to side, rest flat on the baffle bricks, and do not project forward beyond the front of the baffle bricks #33-38.

**WARNING: IF THE BRICKS ARE NOT INSTALLED EXACTLY AS SHOWN BELOW, THEY COULD FALL OUT OF PLACE DURING REFUELING OR BURNING OF THE STOVE CAUSING SERIOUS INJURY!**

### Performer™ C/A210 Brick Sizes (see Figures on this page)

A = 2-1/4 x 9"	G = 1-1/2 x 9"
B = 4-1/2 x 5-1/2"	H = 1-1/2 x 3"
C = 4-1/2 x 6-1/4"	K = 1-1/2 x 5-1/2"
D = 3 x 6-1/4"	M = 2-1/8 x 6-1/4"
E = 3 x 9"	S = 2-1/8"
F = 4-1/2 x 9"	

Two insulating blankets each measuring 1/2" x 12-1/2" x 15-1/4". They fit on top of the baffle brick (one on the left of the secondary tube support brackets and one on the right).

Firebox Brick Lay-Out Viewed From the Front

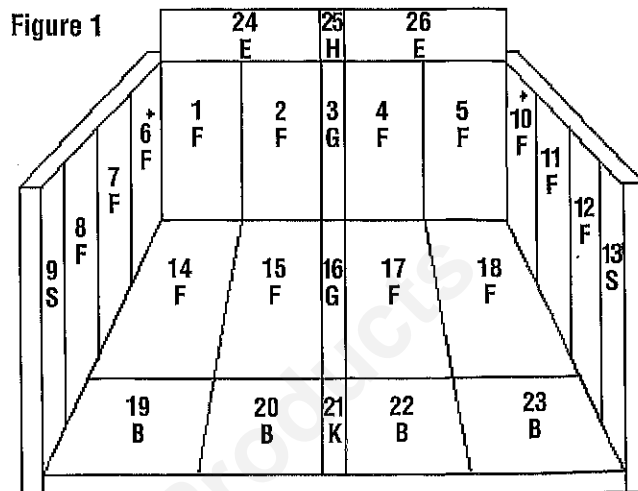

\* Bricks 6 & 10 fit up against the back of the firebox.

Front View

See the following for brick sizes

\* Fits against the back of the firebox.

**Note:** These bricks may be slightly smaller to adjust for steel and fire-brick tolerances beyond our control. Be sure to measure and mark bricks with their numbers when removing.

Secondary Tube Supporting Brackets

Figure 2

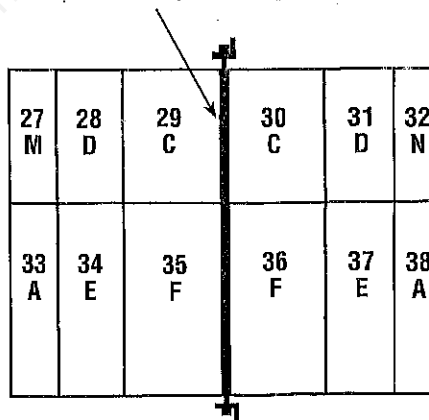

Top View of Baffle Brick as Viewed from the Front

Secondary Tube Supporting Brackets

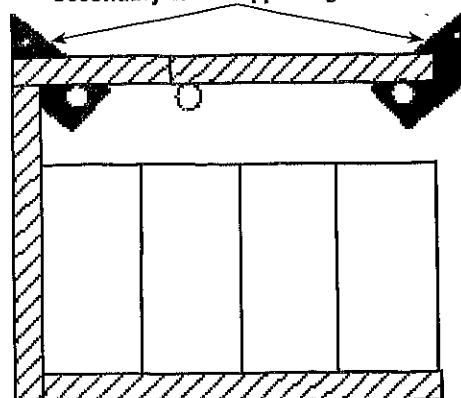

Figure 3

Side View of the Firebox

NOTE: DIAGRAMS & ILLUSTRATIONS ARE NOT TO SCALE.