

owners manual
**INSTRUCTIONS FOR INSTALLING AND
OPERATING — WITH REPAIR PARTS LIST**
Magazine Heaters

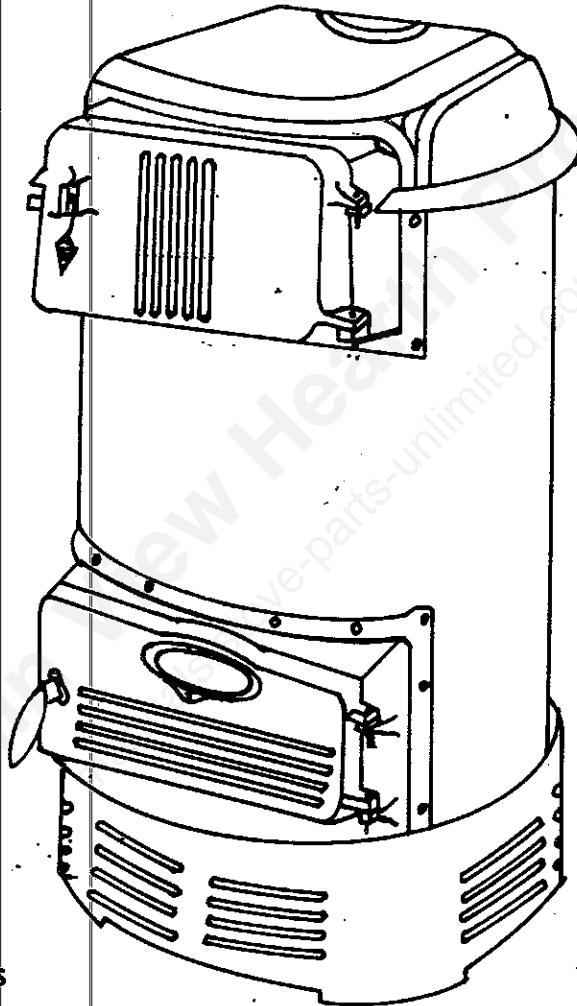

- Installation
- Operation
- Repair Parts

CAUTION:
Read All Instructions
Carefully Before Start-
ing The Installation.

Model Numbers
16-FB, 17-FB, 20-FB

THIS MANUAL WILL HELP YOU TO OBTAIN EFFICIENT, DEPENDABLE SERVICE FROM THE HEATER, AND
ENABLE YOU TO ORDER REPAIR PARTS CORRECTLY. KEEP IN A SAFE PLACE FOR FUTURE REFERENCE

UNITED STATES STOVE COMPANY • SOUTH PITTSBURG, TENNESSEE 37380

FORM 85121 7/76

INDEX

PAGE	INFORMATION
1	Front Cover
2	Index
3	Rules For Safe Installation - Tools
4	Installation - Location
5	Operating Instructions
6	Repair Parts Illustrated
7	Repair Parts List-Helpful Hints
8	Repair Part Order Information

rules for safe installation and operation

1. Read these rules and the instructions carefully. Failure to follow them could cause malfunction of the heater. This could result in death, serious bodily injury, and/or property damage.
2. Check your local codes. The installation must comply with their rulings.
3. Do not install this heater in a mobile home or trailer.
4. Always connect this heater to a chimney and vent to the outside. Never vent to another room or inside a building.
5. Do not connect a coal burning heater to an aluminum Type B gas vent. This is not safe and is prohibited by the National Fire Protection Association Code. Use only a Class "A" masonry or, All-Fuel prefabricated chimney. Prefabricated chimneys must be listed by Underwriters Laboratories (UL) Inc. The inside diameter must be at least six inches.
6. The heater should be placed on a non-combustible floor.
7. Provide air for combustion from the outside into the room where the heater is located. If the intake is not in the same room, the air must have free access to the room.
8. CAST IRON PARTS MUST BE "SEASONED" TO AVOID CRACKING. BUILD ONLY SMALL FIRES DURING YOUR EARLY USE. Never build extremely large fires in your heater. If any part of the heater becomes red hot, damage will likely result.
9. To prevent injury do not allow anyone who is unfamiliar with the operation to use the heater.
10. CAUTION: Do not touch the heater until it has cooled.

tools and materials needed

TOOLS

Pencil
6 Foot Folding Rule or Tape
Tin Snips
Drill, Hand or Electric
Drill Bit (For Sheet Metal Screws)

MATERIALS

6" Smoke Pipe
1/2" Sheet Metal Screws
6" Flue Thimble
6" Collar
6" Elbow

locating the heater

Look at Fig. 2. The smoke pipe and fittings you will need to connect to a masonry chimney or ALL-FUEL CHIMNEY on the outside wall are shown.

If your CHIMNEY starts at the ceiling (Fig. 3) you will need an elbow, enough pipe to reach the ceiling and a finish collar.

Connect the heater to the chimney. The crimped end of the vent pipe fits inside the heater flue collar. Additional pipe and elbows should be installed crimped end toward the heater.

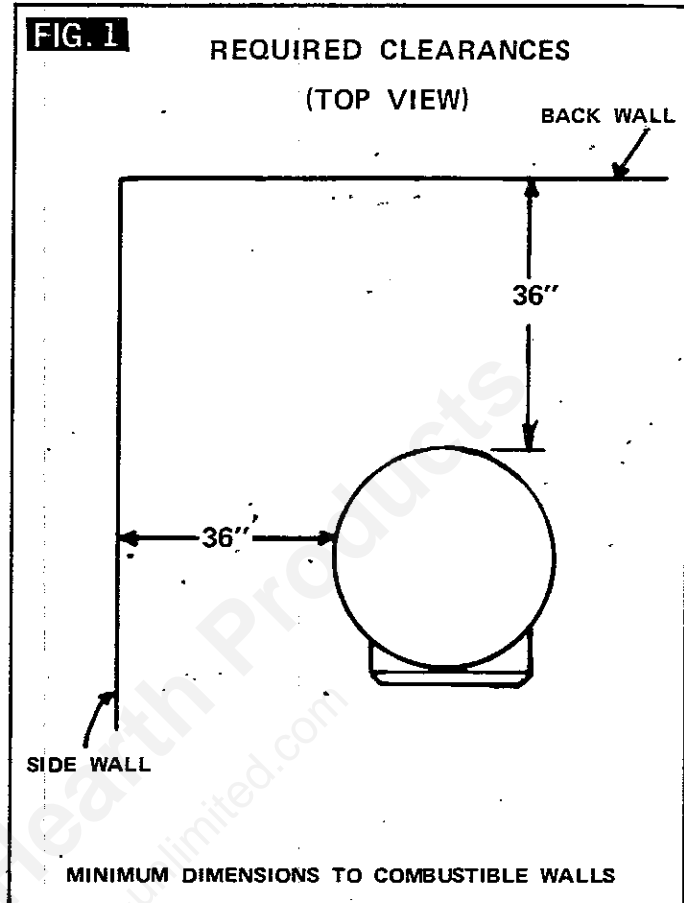
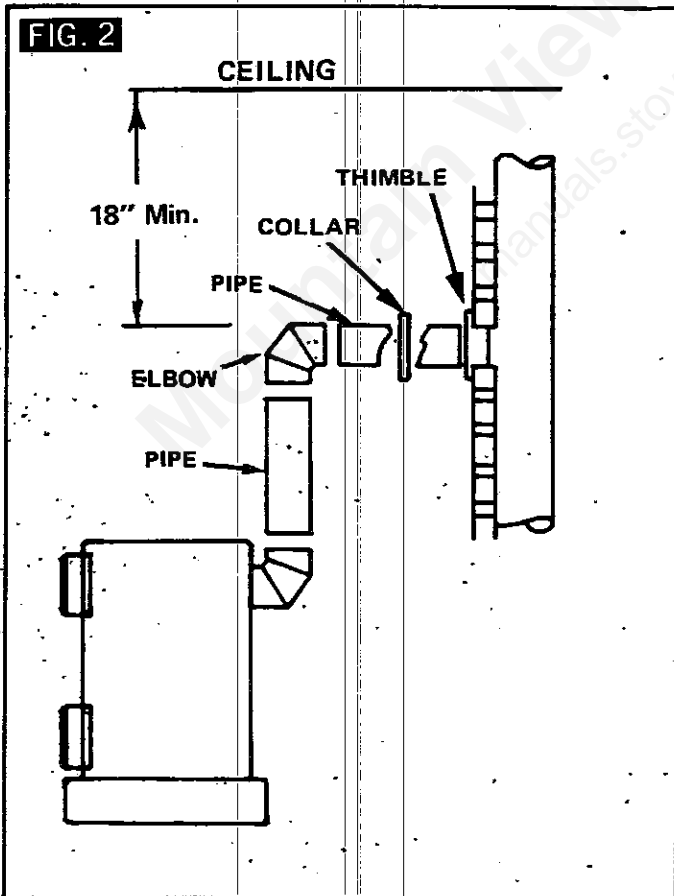

installation

As a location is selected, keep the following in mind:

1. The chimney connection should be as short as possible. The heater must have its own chimney. Do Not connect any other appliance to the same flue.
If there is no chimney near where you wish to place the heater, you can use a prefabricated All-Fuel Chimney.
2. This heater should be placed on a non-combustible floor.
3. Check Figs. 1, 2, 3 and 4. You should have at least the clearances shown from the heater and the smoke pipe to combustible surfaces.

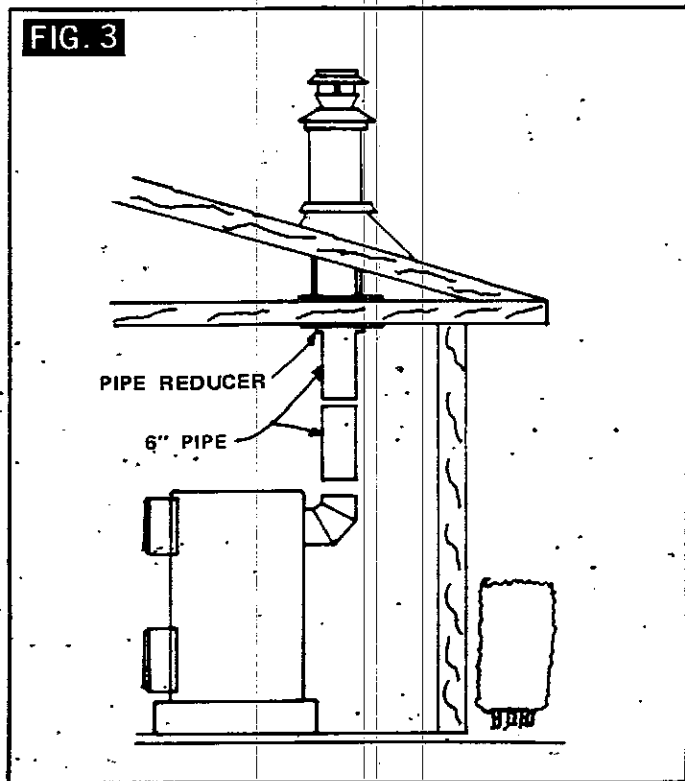
FIG. 3

These rules apply to the vent pipe installation:

1. Avoid using more than one elbow.
2. Any horizontal pipe should be pitched upward toward the chimney at least 1/4 inch for each foot of horizontal run.
3. Be sure that you have at least 18" of clearance between the horizontal piping and the ceiling.
4. Be sure the pipe does not extend into the chimney flue (Fig. 4).

For better performance seal each vent pipe joint with furnace cement. Also seal the pipe at the chimney. Finally, use three sheet metal screws at each joint to make the piping rigid.

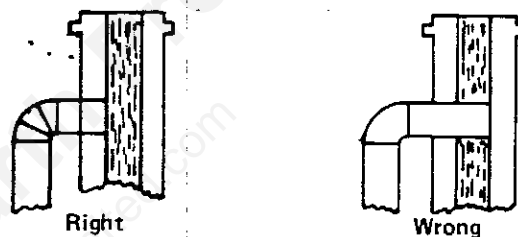
FIG. 4

operation

CAUTION

BE SURE THE FIREBRICK LININGS AND GRATES ARE IN PROPER POSITION BEFORE STARTING A FIRE.

TO START A FIRE

1. Open the ash door draft slide.
2. Lay a fire using crushed paper and kindling wood. Let it burn freely before adding the first coal.
3. Add the first charge of coal, about 15 pounds. Let it get a good start. Then add the next charge of coal. Continue this until the heater is filled (about 2 inches below the top tier of brick).

NOTE

Keep the ash door draft slide open only long enough to get the fire started.

RECHARGING

Recharge the heater when the coal has burned down to about 6" above the grate.

1. Shake the grate until some red coals fall through. Then open the ash door draft slide.

2. Let the coals burn to a glowing red. Then add fuel as when starting the fire.

Open the feed door only a very little at first. Then open it slowly all the way. This will avoid the chance of the heater smoking. The amount you add depends on the weather and the heat wanted. The draft should stay open until the fuel bed is coked. This means that all the gases have been driven from the new coal. Then regulate your fire with the ash door draft opening.

HOLDING FIRE OVER NIGHT

Put a fair amount of coal in the heater. Coke it. (Get it well started) Then close the ash door draft door.

Never allow ashes to pile up in the ash pan to within 2 inches of the grates. This will shorten the life of the grates.

Keep the top of the fuel at least 1 inch below the top of the fire brick. Coal will swell and push upward when it starts to burn.

NEVER OVERHEAT the heater. This will shorten its life. Egg size coal is recommended. Other sizes may be used but do not use oil or chemically treated coal.

PARTS ILLUSTRATION

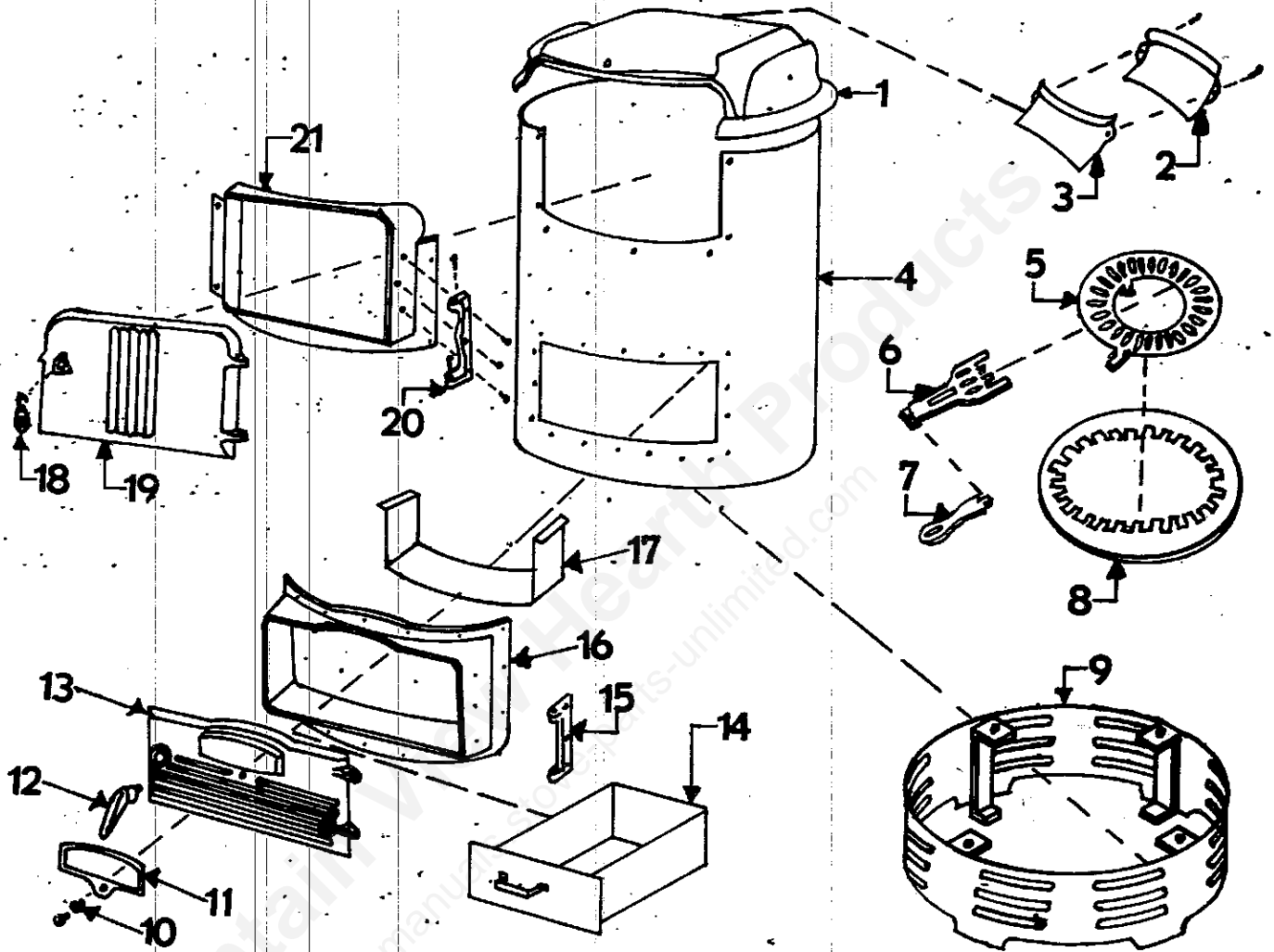

NORMAL RESPONSIBILITY OF THE USER

1. Damage to exterior or interior finish of Product after merchandise is accepted.
2. Difficulty or damage resulting from improper operation or commercial usage.
3. Over-firing cast-iron grates and linings to a red heat; ashes allowed to pile up under grates.
4. Improper chimney or stove pipe drafts.
5. Damage as a result of fire, flood or acts of God.

REPAIR PARTS LIST

WHEN ORDERING REPAIR PARTS, ALWAYS GIVE THE FOLLOWING INFORMATION AS SHOWN IN THIS LIST:

1. The Part Number
2. The Part Description
3. The Model Number
4. The Name of Item

Key No.	Model 16-FB Part No.	Model 17-FB Part No.	Model 20-FB Part No.	Name of Part.
1	40040	40040	40040	Main Top
2	40041	40041	40041	Collar Section, Back
3	40042	40042	40042	Collar Section, Front
4	67246	67247	67248	Body
5	40043	40043	40043	Round Grate
6	40044	40044	40044	Draw Grate
7	40045	40045	40045	Shaker
8	40046	40046	40046	Brick Support Ring
9	21205	21205	21205	Skirt Base
10	89102	89102	89102	Draft Slide Spring
11	21215	21215	21215	Ash Pit Draft Slide
12	40047	40047	40047	Ash Pit Door Handle
13	40048	40048	40048	Ash Pit Door
14	67245	67245	67245	Ash Pan
15	40049	40049	40049	Ash Door Hinge
16	40050	40050	40050	Ash Pit Front
17	40051	40051	40051	Brick Support, Front
18	89001	89001	89001	Wire Drop Handle
19	40052	40052	40052	Fire Door
20	40054	40054	40054	Fire Door Hinge
21	40053	40053	40053	Fire Door Front
*	89100	89100	89100	Brick, large
*	89101	89101	89101	Brick, small
*	40046	40046	40046	Brick Ring Support
*	85118	85118	85118	Nameplate (Specify Model)
*	85121	85121	85121	Instruction Manual

Small Brick No. 89101, Large Brick No. 89100

*Not Illustrated

†Model No. 16-FB Contains 7 Large Bricks and 2 Small Bricks

†Model No. 17-FB Contains 9 Large Bricks and 7 Small Bricks

†Model No. 20-FB Contains 16 Large Bricks and 2 Small Bricks

helpful hints

Do not expect a heater to draw. It is the chimney that creates the draft.

1. Chimney should extend at least 3 feet above the highest point where it passes through the roof. It should also be at least 2 feet higher than any portion of the building within 10 feet.
2. The heater chimney should have no other appliances attached to it. All unused openings and the clean-out door at the chimney base should be sealed.
3. The draft or "drawing" of the heater is fully dependent on the chimney. A chimney must be high enough and warm enough to provide draft. Adding chimney height should improve draft.
4. The smokepipe may be pushed into the chimney too far, stopping the draft.

5. Do not connect two heaters into the same chimney flue. If it cannot be avoided, be sure that one pipe is higher than the other so that the two openings will not be opposite each other.

6. The chimney used for a heater must not be used to ventilate the cellar or basement. If there is a cleanout opening at the base of the chimney, it must be closed tightly.

7. If the fire burns well but sometimes smokes or burns slowly it may be caused by the chimney top being lower than another part of the house or a nearby tree. The wind blowing over a house or a tree, falls on top of the chimney like water over a dam, beating down the smoke. Increase the chimney or flue height so that it extends 2 feet above the roof peak.

8. Some chimneys will have very high or fluctuating drafts. In this case install a barometric damper control in the vent pipe just above the first length.

owners manual

HOW TO ORDER REPAIR PARTS

THIS MANUAL WILL HELP YOU TO OBTAIN EFFICIENT, DEPENDABLE SERVICE FROM THE HEATER, AND ENABLE YOU TO ORDER REPAIR PARTS CORRECTLY.

KEEP IN A SAFE PLACE FOR FUTURE REFERENCE.

WHEN WRITING, ALWAYS GIVE THE FULL MODEL NUMBER WHICH IS ON THE NAMEPLATE ATTACHED TO THE BACK OF THE HEATER.

WHEN ORDERING REPAIR PARTS, ALWAYS GIVE THE FOLLOWING INFORMATION AS SHOWN IN THIS LIST:

1. The PART NUMBER
2. The PART DESCRIPTION
3. The MODEL NUMBER
4. The NAME of ITEM

UNITED STATES STOVE COMPANY • SOUTH PITTSBURG, TENNESSEE 37380