



# KING MODEL 200 "FATSO" LAUNDRY HEATER

## Installation, Operation, and Maintenance Manual

### IMPORTANT INFORMATION

To assure satisfactory and safe service is received from this heater:

1. Read these instructions completely before beginning any part of the installation.
2. Use these instructions as a guide during the installation of the heater.
3. Be sure this manual becomes the property of, and is reviewed by all future users of this heater to encourage proper operation and maintenance of this heater.

Improper installation, operation, or maintenance of this heater can cause:

1. Damage to the heater from overheating.
2. Exposure of parts of the building or its contents to temperatures that may cause them to ignite and burn.
3. Release of smoke and hazardous gases into the building.
4. Premature failure of the heater due to rust or corrosion.

This heater is designed to provide heat to one or more rooms connected by doorways. This heater must be installed as a free-standing heater at clearances to combustibles as specified in this manual and connected to a factory-built all fuel chimney listed by a nationally recognized testing and listing organization or masonry chimney built and maintained to N.F.P.A. standards. **THIS HEATER MUST NOT BE CONNECTED TO A CHIMNEY FLUE SERVING ANY OTHER APPLIANCE.**

This heater is not designed to be connected to any air circulation system. This heater does not comply with H.U.D. standards for installation in mobile homes.

This heater is designed to burn wood or coal. Burning of any other fuels or materials in this heater can be hazardous.

### HOW THIS HEATER OPERATES

The smoke and hot gases flowing from this heater up the chimney create a slight vacuum in the firebox of the heater. Air for burning the wood or coal is drawn through the draft slide in the ash door. Since this heater is not constructed as an airtight unit the rate at which the wood or coal is burned must be controlled by a damper in the chimney connector pipe.

As the surface of the heater becomes hot, it radiates heat to the objects around it in much the same way that a heat lamp warms objects within its beam. This means of heat transfer is effective in making persons in the area of the heater feel warm at room air temperatures lower than is required for devices that heat circulated air.

Because of the hot surface of this heater and its heat radiating characteristic, the prescribed spacing between the heater and combustible material must be maintained and precautions taken to prevent persons from coming in contact with the heater.

### BUILDING CODES AND SAFETY STANDARDS

These instructions are recommended minimum requirements for the installation of this heater. State or local codes and insurance regulations may differ from these instructions. Be sure you check with the authorities having jurisdiction in your area to assure compliance with applicable codes and regulations.

### FLOOR PROTECTION

The floor beneath the heater and in front of the feed door must be protected from sparks and embers that may fall from the heater during fire tending by a non-combustible floor covering such as a King stove board, brick, or stone.

### CHIMNEY CONNECTOR AND CHIMNEYS

It is very important to assure safe and satisfactory performance that this heater be correctly connected to a properly constructed and maintained chimney.

The chimney connector (pipe from heater to chimney) must be 8 inches in diameter and made from 24 gauge or heavier steel. The length of the chimney connector and number of elbows used should be kept to a minimum. A 1/4 inch rise per foot slope must be provided in a horizontal run of chimney connector to assure proper draft (See figure 1). **DO NOT USE MORE THAN ONE ELBOW IN THE CHIMNEY CONNECTOR.**

A chimney connector should never pass through a floor, ceiling, firewall, or fire partition. Only a listed all fuel factory built chimney or masonry chimney constructed to N.F.P.A. standards may pass through these structures.

A twist damper must be installed in the chimney connector to assist in controlling the burning rate of the heater.

If the heater is to be installed in a factory-built chimney, be sure the chimney is a 8 inch diameter, all fuel chimney listed by a na-

**CONTENTS**

1. Don't dry clothing or other articles on or near the heater.
2. Don't store or place flammable liquids, gases, or pressurized containers near the heater
3. Don't attempt to use the heater until the installation is complete.
4. Don't use improper materials or substitute parts in the installation of the heater.
5. Don't take for granted that the heater is adjusted properly and is operating properly before leaving it unattended for long periods of time.
6. Don't install this heater in an area where combustible vapors are present.
7. Don't use gasoline, kerosene, engine oil, charcoal lighter or other flammable liquids to start or intensify a fire. Using these and other similar materials can cause an explosion within the heater.
8. Don't use an unlisted, type B, or poorly constructed or maintained chimney to vent this heater.
9. Don't use galvanized pipe, steel pipe less than 24 gauge, or pipe of a diameter smaller than 6" as a chimney connector.
10. Don't store ashes in combustible containers, store them near combustible materials or dispose of them until they have completely cooled.
11. Don't use power blowers or air circulation systems with this heater that are not specifically recommended by Martin Industries.
12. Don't operate the heater in a manner that causes any part of the heater or chimney connector to become red hot.

**FIGURE 3**

**ORDER ALL REPAIR PARTS FROM YOUR KING DEALER BY SUPPLYING THE FOLLOWING INFORMATION:**

1. PART NAME
2. PART NO. (Not Key No.)
3. MODEL NO.

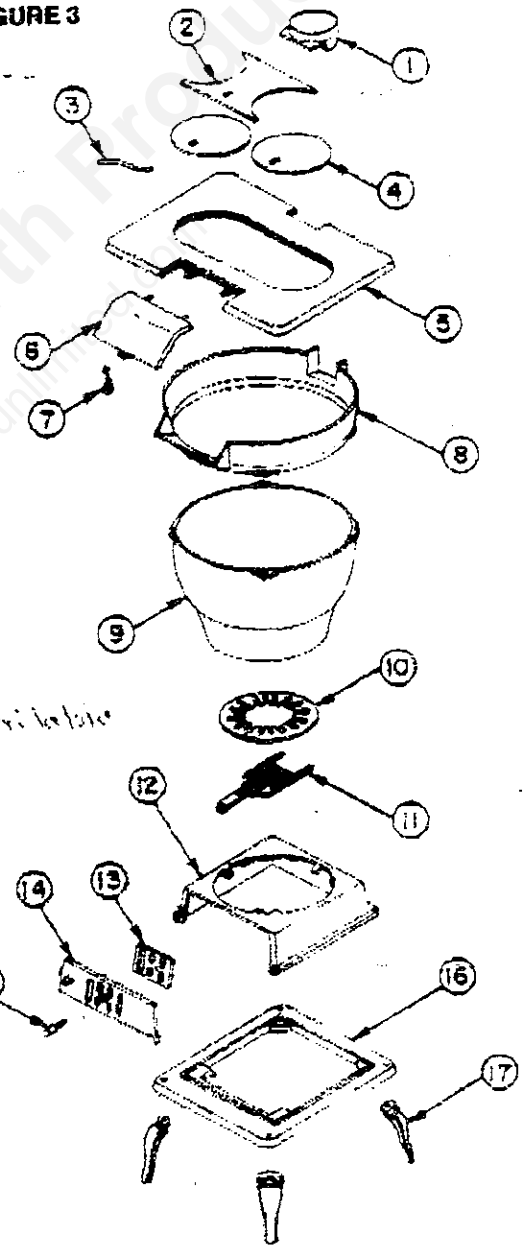

KEY NO.	NAME OF PART	PART NO.
1	Collar, Reversible	005397FS
2	Center, Short	005393FS
3	Shaker - Lifter	005405FS
4	Cover	005396FS
5	Top, Extreme	005403FS
6	Door, Feed	005399FS
7	Handle, Drop Wire	005397S
8	Top, Flange	005404FS
9	Bowl, Fire	005391FS
10	Grate, Round	005398FS
11	Grate, Pull	005394FS
12	Base, Ash	005401FS
13	Slide, Draft	005398S
14	Door, Ash	005400FS
15	Knob #22	004456S
16	Bottom	005402FS
17	Foot Painted Assembly	004452S

\* Available 6-25-99