

F7880

F7880

*This is the
part I need*

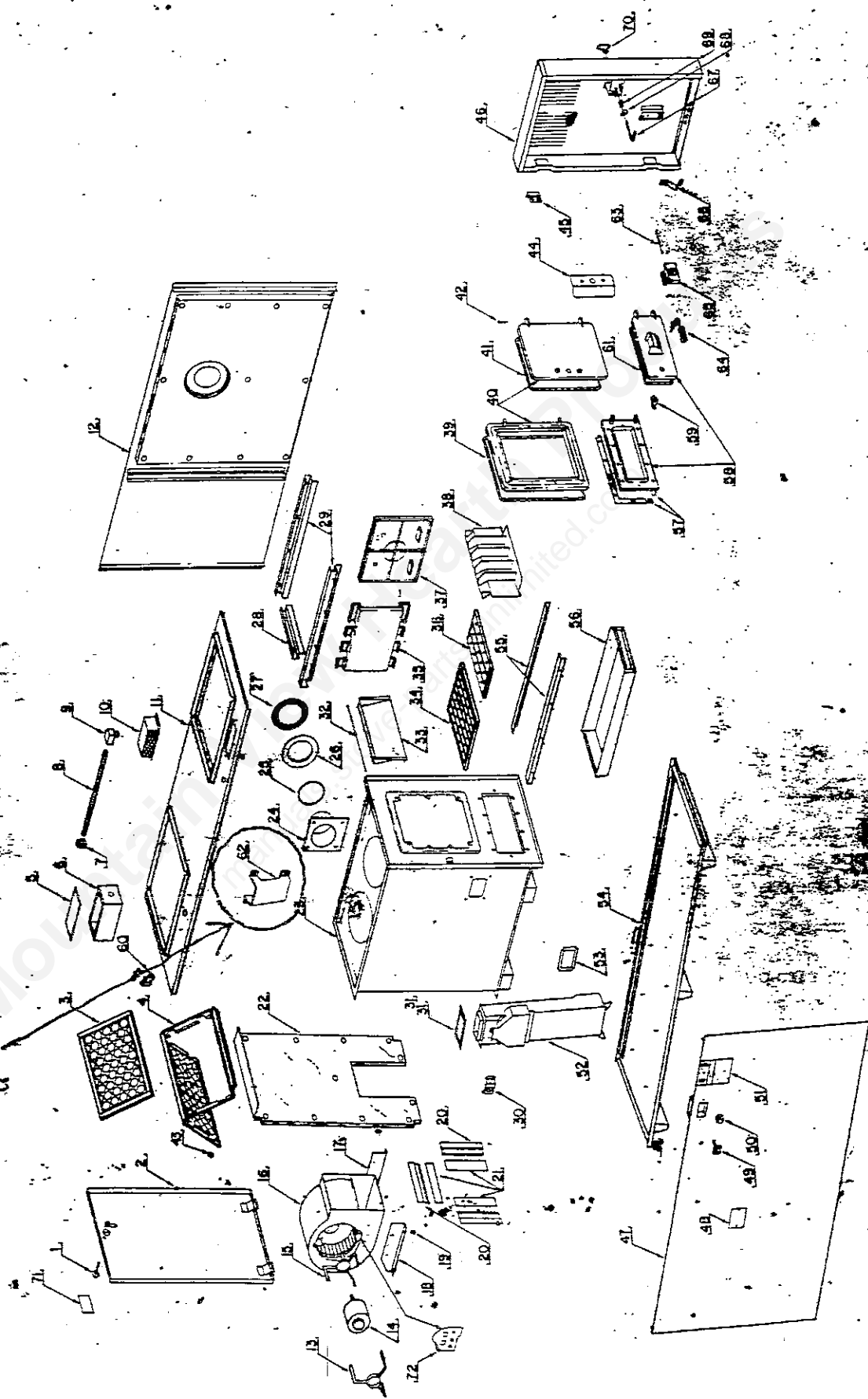

KEY NO.

DESCRIPTION

MARTIN PART NO.

49.	Fan Thermostat Control	008716
50.	Control Knob	000058
51.	Control Panel Plate	008124
52.	Draft Tube Assy	006262
53.	Downdraft Tube Gasket	007812
54.	Base Assy	008800
55.	Grate Support Angle Assy	007928
56.	Ash Pan	006562
57.	Ash Door Frame Gasket	007844
58.	Frame and Ash Door Assy	009984
59.	Latch	P5236
60.	Strain Relief Bushing	009989
61.	Fiberglass Rope	009535-04
62.	Flue Collar Baffle	009911 R
63.	Inlet Cover Rod	008724
64.	Handle	006088
65.	Inlet Assy	007943
66.	Inlet Closing Spring	008541
67.	Handle Shaft	009316-03
68.	Washer	009665
69.	Spring	009315
70.	Handle	009313
71.	Filter Label	006756
72.	Motor Hanger Support	008468

Key-No -

62 Flue collar Baffle - Part No. 009911 R
 Ashley Wood - Warm Air furnace
 model # F17880
 Ashley Form No. 010062-1-79



FORM NO. 010062-1-79

ASHLEY AUTOMATIC HEATER CO.
 P.O. Box 730, Sheffield, AL 35660

ASHLEY

0028

FORM NO. 036691-0-1187

F8200

ASHEY HEATER COMPANY
P.O. Box 128, Florence, AL

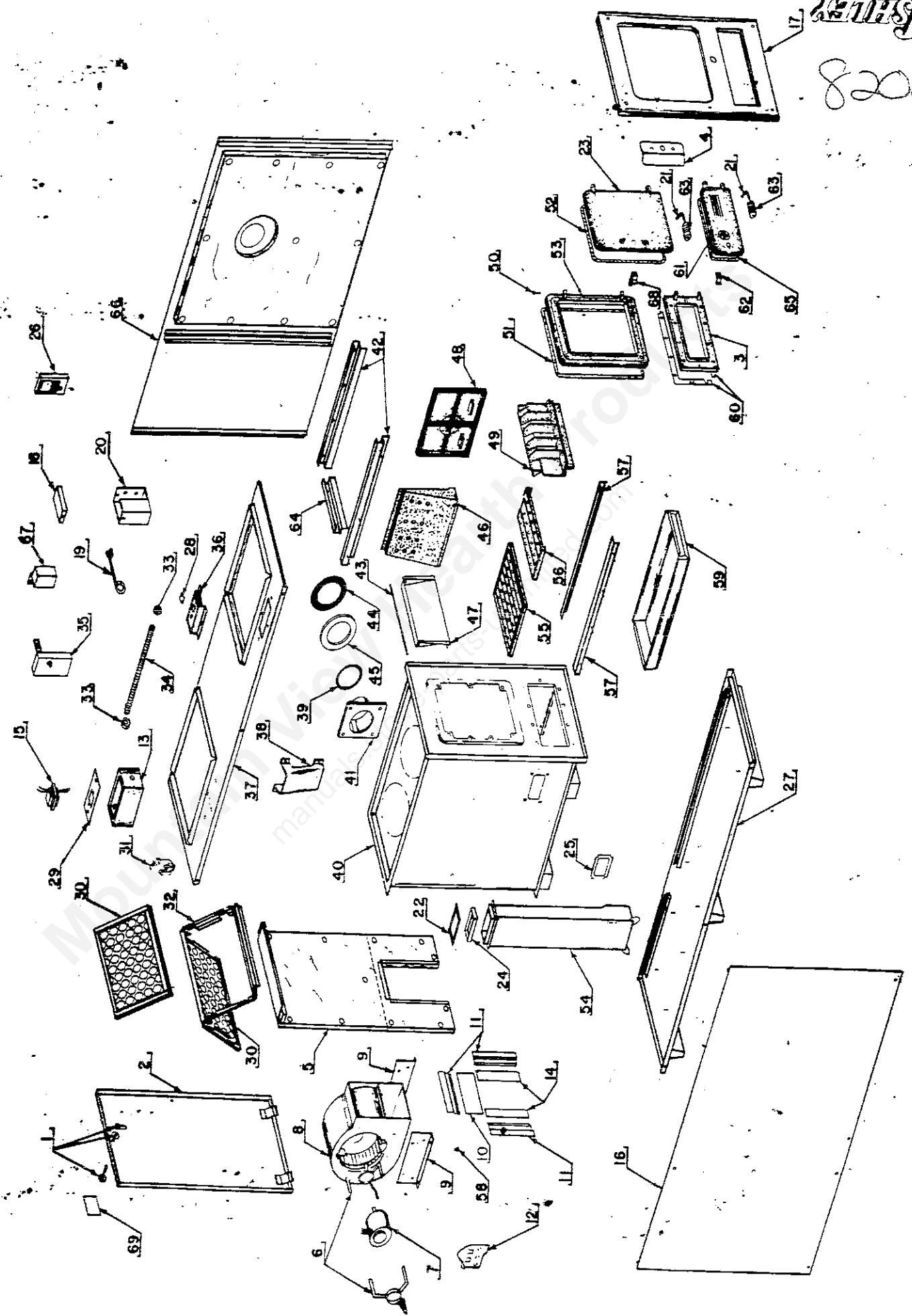

Do's

1. Do have this furnace install by a qualified installer.
2. Do be sure the furnace is attached to a listed factory-built all-fuel chimney or a masonry chimney built to N.F.P.A. standards.
3. Do provide the required floor protection when installing on combustible floors as illustrated in figure 1.
4. Do maintain the required minimum clearances between the furnace and chimney connector and combustible materials.
5. Do be sure provisions are made to supply adequate combustion air to the furnace and other fuel-burning appliances that are located in the same area with the furnace.
6. Do install and properly adjust a barometric draft regulator in the chimney connector serving the furnace.
7. Do seal all chimney connector joints with furnace cement and fasten them securely with three sheet metal screws per joint.
8. Do be sure all electrical wiring complies with the National Electric Code.
9. Do be sure that the combustion air damper closes when the thermostat is off (no voltage at the draft damper operator).

Don't

1. Don't use a chimney for this furnace that is serving any other appliance.
2. Don't use 90° elbows in the ducts connecting the furnace to the duct system.
3. Don't use volatile liquids such as kerosene, gasoline or lighter fluids to start or freshen up a fire in this furnace.
4. Don't burn liquid fuels, trash or coal in this furnace.
5. Don't install this furnace in an area where combustible gases or liquids may be present.
6. Don't install this furnace in a residential garage.

ORDER ALL REPAIR PARTS FROM YOUR ASHLEY DEALER BY SUPPLYING THE FOLLOWING INFORMATION:

1. PART NAME 2. PART NO. (Not Key No.) 3. MODEL NO.

KEY NO.	PART NAME	PART NO.	QTY.	KEY NO.	PART NAME	PART NO.	QTY.
1	Latch Handle Assembly	008506	1	41	Flue Collar	009537	1
2	Rear Cabinet Door	036679	1	42	Side Liner Retainer Assembly	008580	2
3	Frame Ash Door	016071	1	43	Smoke Curtain Rod	008110	1
4	Shield Hdl. Radiation Ptd	008804	1	44	Flue Collar Gasket	007822	1
5	Insulated Blower Divider	017227	1	45	Collar Support	011530	1
6	Motor Hanger	008467	2	46	Liner	017048	6
7	Motor	017165	1	47	Smoke Curtain	007924	1
8	Blower Housing with Wheel	017166	1	48	Rear Liner	010738	1
9	Blower Housing Support	017170	2	49	Front Liner	006734	1
10	Gasket	017811	1	50	Pin Door	P626	4
11	Felt Retainer	007832	3	51	Rope Gasket f/Feed Door Frame	026592	1
12	Support Motor (Parts Bag)	008468	1	52	Rope Gasket For Feed Door	009535-03	1
13	Junction Box Ptd	036649	1	53	Frame & Rope Assy For Feed Door	016081	1
14	Gasket	017266	2	54	Draft Tube	017232	1
15	Transformer	022788	1	55	Large Grate	017217	2
16	Insulated Left Side Cabinet	036669	1	56	Small Grate	017218	1
17	Panel Ptd Front	036665	1	57	Grate Support Angle Assembly	007928	2
18	Top Box Ptd F/Draft Optr	036677	1	58	Rubber Grommet Parts Bag	008471	1
19	Rod Control	017146	1	59	Ash Pan Assy	006562	1
20	Box Ptd F/Draft Optr	036656	1	60	Ash Door Frame Gasket	007844	1
21	Handle Shaft (*See pg. 5)	014507	2	61	Ash Door & Rope Assembly	016069	1
22	Downdraft Gasket	007821	1	62	Latch (For Ash Door)	014711	1
23	Feed Door & Rope Assembly	016070	1	63	Handle Knob (See pg. 5)	015402	2
24	Damper Frame Assembly	017149	1	64	Rear Liner Retainer Assembly	008798	1
25	Downdraft Tube Gasket	007812	1	65	Rope Gasket For Ash Door	009535-04	1
26	Thermostat	008133	1	66	Insulated Right Side Cabinet	036652	1
27	Base Assy. Ptd	035954	1	67	Draft Damper Operator	017173	1
28	Plate Ptd Cover	036663	1	68	Latch	014713	1
29	Cover (Junction Box) Ptd	036667	1	69	Label Filter	006756	1
30	Air Filter (10" x 20" x 1")	009084	2	* NOTE: Handle Parts are not available separately; order complete Handle Assy.			
31	Strain Relief Bushing	009989	1		Liners Set	015905	2
32	Filter Rack	008551	1		Grates Set	020793	1
33	Connector Straight	008611	2			020794	1
34	Conduit	022795	1				
35	Control Blower	023233	1				
36	Base Damper Operator	036660	1				
37	Top Assy Insulated Cab	036673	1				
38	Flue Collar Baffle	009911	1				
39	Rope, Fiberglass	026591	1				
40	Inner Unit	017278	1				