

Model 2721C
owners manual
Wonder Wood
Automatic Wood Burning Circulator

SAFETY NOTICE:
If this heater is not properly installed, a house fire may result. For your safety, follow the installation directions. Contact local building or fire officials about restrictions and installation inspection requirements in your area.

CAUTION:
Read All Instructions Carefully Before Starting The Installation or Operating The Heater.
Improper Installation Could Void Your Warranty!

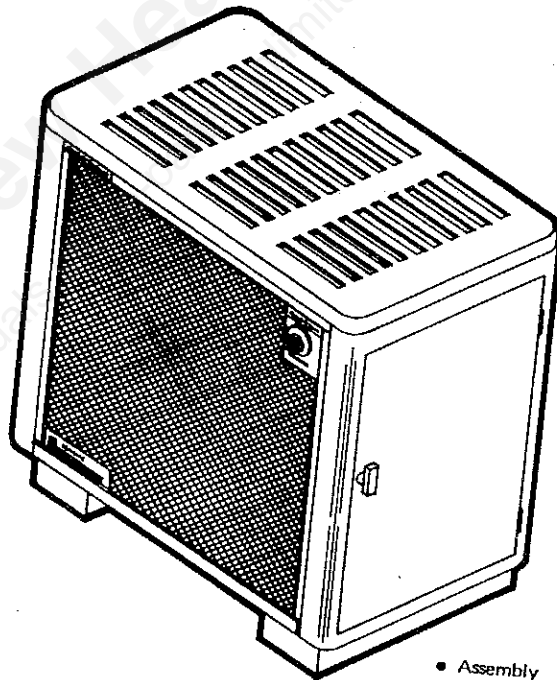

- Assembly
- Installation
- Operation
- Repair Parts

Save This Manual
For Future Reference

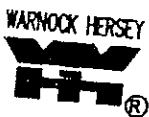

DO NOT USE THIS HEATER
IN A MOBILE HOME OR TRAILER



UNITED STATES STOVE COMPANY
P.O. BOX 151
111 Industrial Drive
South Pittsburg, TN 37380

85382J 6/91

CONGRATULATIONS!

You've purchased one of North America's Finest Woodburning Heaters.

By heating with wood you're helping CONSERVE CANADA'S ENERGY.

Wood is our Renewable Energy Resource. Please do your part to preserve our wood supply.

Plant at least one tree each year. Future generations will thank you.

Tools and materials needed

TOOLS

Pencil
6 Foot Folding Rule or Tape
Tin Snips
Drill, Hand or Electric
Drill Bit (For Sheet Metal Screws)-1/8" dia.
Screw Driver (Blade Type)
Gloves
5/16" Nut Driver or
5/16" Socket w/Ratchet

MATERIALS

Chimney connector - 6" dia. Black or Blued Steel
(24 GA. minimum): straight or elbow (as required)
1/2" Sheet metal screws (10A x 1/2")
6" Inside diameter Listed Residential Type and
Building Heating Appliance Chimney or existing
masonry chimney.
Floor Protector Material 3' - 0" x 4' - 6"
as specified on Page 4.
Furnace Cement (Manufacturer recommends:
(Rutland Black-Code 78 or equivalent).

Safety Rules

Read these rules and the instructions carefully.

SAFETY NOTICE: If this heater is not properly installed, a house fire may result. For your safety, follow the installation directions. Contact local building or fire officials about restrictions and installation inspection requirements in your area.

1. Check your local codes. The installation must comply with their rulings.
2. Do not install this heater in a mobile home or trailer.
3. Always connect this heater to a chimney and vent to the outside. Never vent to another chimney is high enough to give a good draft.
4. Do not connect a wood burning heater to an aluminum Type B gas vent. This is not safe and is prohibited by the National Fire Protection Association Code. This heater requires a masonry or a Listed Residential Type and Building Heating Appliance Chimney.
5. Inspect chimney connector and chimney twice monthly during the heating season for any deposit of creosote or soot which must be removed (see Chimney Maintenance, Page 12).
6. Provide air for combustion from outside the house into the room where the heater is located. If the intake is not in the same room, air must have free access to the room.
CAUTION - Do not block air inlets at lower front of heater.
7. **CAUTION -** The special paints used on your furnace may give off some smoke while they are curing during first few fires. Build small fires at first. The metal used in construction of the heater has a light coating of oil. This could give off smoke and / or odors when heater is used for the first couple of times. This should disappear after a short period of time. Once this burn-off has occurred, it should not reoccur.
CAUTION: Do not touch the heater until it has cooled.
8. **CAST IRON PARTS MUST BE "SEASONED" TO AVOID CRACKING. BUILD ONLY SMALL FIRES ON FIRST USE.**
9. To prevent injury, do not allow anyone to use this heater who is unfamiliar with the correct operation of the heater.
10. For further information on using your heater safely, obtain a copy of the National Fire Protection Association (NFPA) publication "Chimneys, Fireplaces and Solid Fuel Burning Appliances" NFPA 211. The address of the NFPA is Batterymarch Park, Quincy, Ma 02269.
11. **DISPOSAL OF ASHES-**Place ashes in a metal container with a tight fitting lid. Keep the closed container on a noncombustible floor or on the ground, well away from all combustible materials. Keep the ashes in the closed container until all cinders have thoroughly cooled. The ashes may be buried in the ground or picked up by a refuse collector.
12. **CARING FOR PAINTED PARTS -** This heater has a painted outside jacket. Paint baked onto the steel or iron is very durable but it will not stand rough handling or abuse. When installing your heater, use care in handling. Clean with soap and warm water when heater is not hot. **DO NOT** use any acids or scouring soap, as these wear and dull the finish. **PAINT DISCOLORATION WILL OCCUR IF THE HEATER IS OVERFIRED. FOLLOW OPERATING INSTRUCTIONS CAREFULLY.**
13. Keep the ashpit section free of excess ashes.

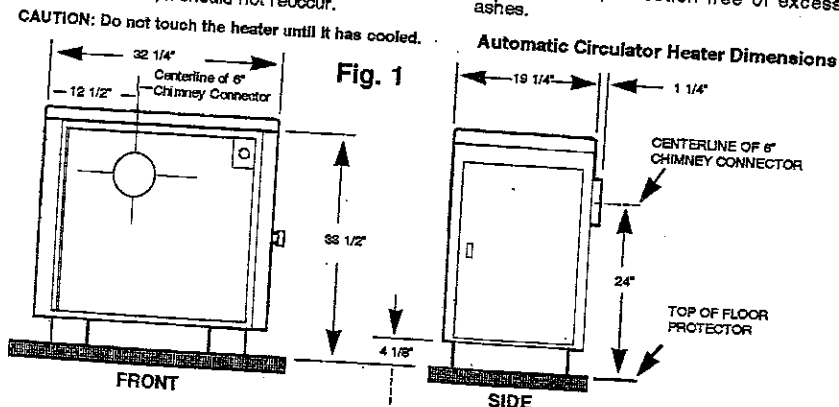

locating the heater

AS A LOCATION IS SELECTED, KEEP THE FOLLOWING IN MIND:

1. The chimney connection should be as short as possible. The heater must have its own chimney. Do not connect any other appliance to the same flue. If there is no chimney near where you wish to place the heater, you can use a Listed Residential Type and Building Heating Appliance Chimney (Fig. 6).
2. Place the heater on solid masonry or solid concrete. When the heater is used on a combustible floor, use a non-combustible floor protector 3/8" thick millboard having a thermal conductivity of $K=0.84 \text{ BTU in./ft.}^2 \text{ hr. deg. F.}$ with 28-gauge sheet metal or a UL listed floor protector.
3. Check Figures 2, 3 and 4. Be sure you have the clearances shown from the heater and the connector pipe to combustible surfaces. Reduced clearances must be made by a means approved by the regulated authority. If you have solid brick or stone wall behind your heater, you can place the heater as close as you wish to the wall. If the wall is only faced with brick or stone, treat it as a combustible wall. Heater should not be to any air distribution duct.

Have the floor protector extend 16" beyond the door side of the heater and under the connector pipe in the back. (Fig. 4).

MINIMUM CLEARANCE TO COMBUSTIBLE WALLS

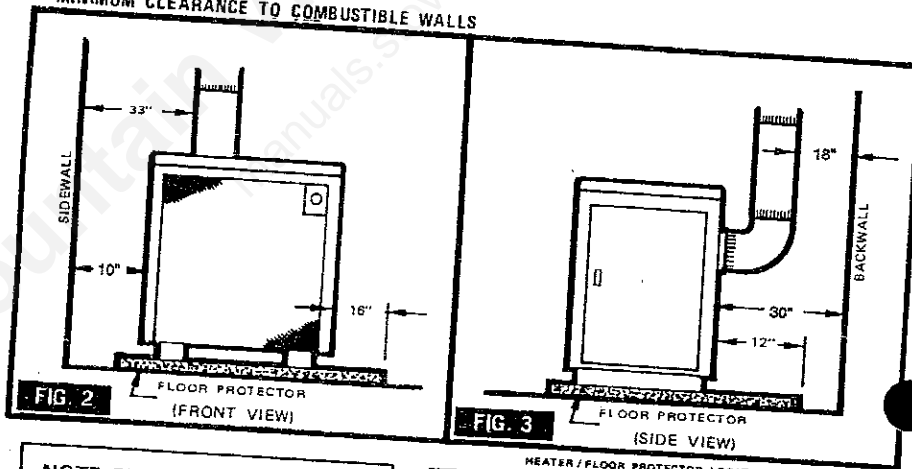

NOTE: BEFORE FIRING HEATER

1. Remove plastic knob from inside of cabinet door and install on outside of door (See p. 13).
2. Slide firebricks toward the rear so no gaps remain between them.

CAUTION

Keep furnishings and other combustible materials away from the heater.

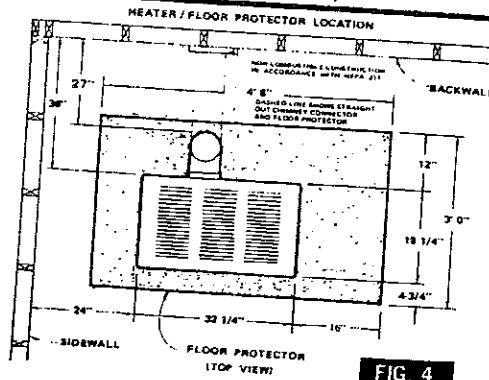

chimney connection

Two basic types of chimneys are approved for use with solid fuel. Factory-built and masonry. Factory-built chimney must comply with ULCS 629 standard.

Do not expect your stove or furnace to create draft. Draft is not a function of the appliance. Draft is purely a function of the chimney. Modern stoves and furnaces are much more air-tight and efficient than those of the past, and, therefore, require greater draft. A minimum of .06 measured in water column (gauges to measure chimney draft are readily available at stove shops and are economical to purchase or rent) is required for proper drafting to prevent back-puffing, smoke spillage, and to maximize performance.

Chimneys perform two functions - one of which is apparent: The chimney provides a means for exhausting smoke and flue gases resulting from combustion of the fuel. Secondly, though, the chimney provides "Draft" which allows oxygen to be continuously introduced into the appliance, so that proper combustion is possible. As of April 1, 1987, all wood heaters and furnaces manufactured by United States Stove Company should be installed using a factory built chimney that meets the "Type HT" requirement of UL 103 (when a factory-built chimney is used).

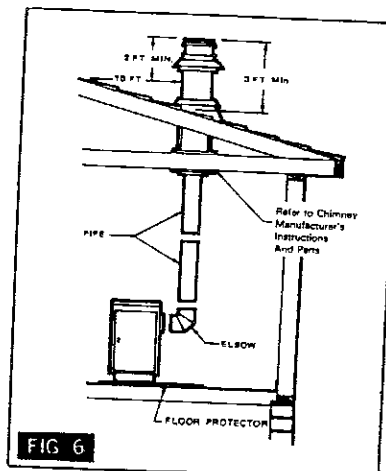
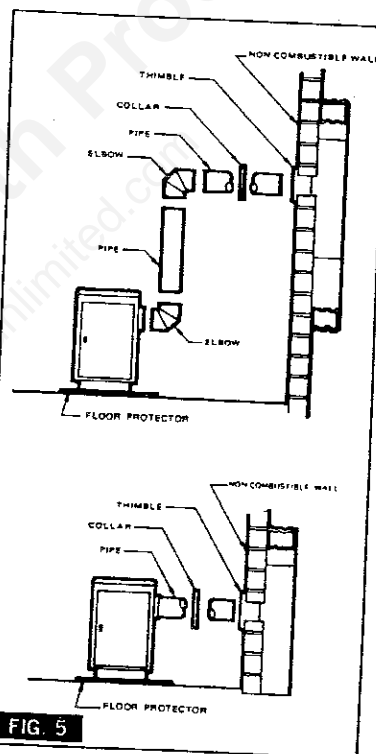

venting into a fireplace

Many people may wish to convert an existing fireplace to wood heater use. Usually, safe connection of stovepipe to a masonry chimney requires more effort than connection to a prefabricated chimney. There are two methods (Type A and Type B) to accomplish this. No matter which method you choose, the fireplace must be tightly closed and sealed at the damper in the flue. Good sealants are high-temperature caulking, ceramic wool, and furnace cement. Always remember to inspect the masonry chimney and fireplace. If necessary, clean the flue and smoke shelf before beginning your installation. Install the wood heater into the fireplace so that the system can be dismantled for cleaning and inspection.

Before deciding to convert your fireplace, keep in mind that some fireplaces and existing chimneys are unsafe. They must be structurally sound, and the flue liner must be in good condition. Clearances to combustibles are explained in the previous section on masonry chimneys. If you have any question regarding the condition of the chimney, consult a qualified engineer, competent mason, or knowledgeable inspector.

**CAUTION
NOT ALL FIREPLACES
ARE SUITABLE FOR
INSTALLATION OF A WOOD
HEATER.**

Many prefabricated fireplaces fall into the "zero-clearance fireplace" category. This is a factory-built metal fireplace with multilayered construction. It is designed to provide enough insulation and/or air cooling so that the base, back and sides can be safely placed in direct contact with combustible floors and walls. Although many prefabricated fireplaces have been tested by nationally recognized organizations for use as fireplaces, they have not been tested to accept airtight wood heaters. In fact, their use as such may void the manufacturer's warranty.

Steel-lined fireplaces, on the other hand, can be used with airtight wood heaters. These units use a 1/4-inch fire box liner and an air chamber in connection with 8 inches of masonry to meet code. They contain all the essential parts of a fireplace, firebox, damper, throat, smoke shelf, and smoke chamber. Many of them look exactly like a masonry fireplace and must be checked closely for above requirements before installing a wood heater into them.

Another method frequently used by some people is to vent the wood heater directly into the fireplace. This does not meet code since the heater is being vented into another appliance - the fireplace. This method should not be attempted because combustion products will deposit and build up in the firebox or fireplace. Be certain not to install a hazard in your house.

Fireplace installation

Connection of the stovepipe directly into the existing masonry chimney over the fireplace opening is the most desirable method. This installation performs better, yielding more heat and better draft; it is also easy to clean and inspect for creosote. Before beginning this type of installation plan carefully; a high degree of skill is required to insure safety.

An entry port for the stovepipe must be cut through the chimney with minimum damage to the fireclay liner. Some involved measurements may be required to locate the flue liner exactly. Before cutting, take time to mark the size and position of the entry port. Position the entry port so that at least 8 inches of the flue liner remains below the port.

Keep in mind that wood mantels and combustible trim around the fireplace must have adequate clearances from the heater and stovepipe or must be protected in an approved manner. Also, be sure to leave at least an 18-inch clearance between the top of the stovepipe and the combustible ceiling or other combustibles. Placing the center of the entry port 2 feet below the ceiling will insure proper clearance for 6-inch, 8-inch, and 10-inch stovepipes. Next, install a fireclay (at least 5/8 inch thick) or metal thimble, being sure that the thimble is flush with the inner flue lining, secure the thimble in place with refractory mortar. The thimble should be surrounded on all sides with 8 inches of brickwork (solid masonry units) or 24 inches of stone.

Install the stovepipe as far as possible into the thimble, but not past the inside of the flue lining. There should be a small airspace (approximately 1/2 inch) between the stovepipe and thimble, allowing for expansion of the stovepipe. Seal this airspace with high-temperature caulking or ceramic wool. Finally, be sure to wire the damper closed and apply the same sealant you used at the stovepipe and thimble junction.

Do not use the Type B installation (not illustrated in this manual), that is, venting up through the fireplace opening, regardless of whether the fireplace opening is closed.

Masonry chimneys have several positive attributes: If properly built, they are quite durable, and most homeowners consider them more attractive perhaps than an unenclosed factory built chimney. And, if the chimney is located within the confines of the house (that is, not attached to an exterior wall), its mass alone will store heat longer and continue to release the heat long after the fire has died. Masonry chimneys have many disadvantages though.

Masonry chimneys constructed on an exterior wall are exposed to cold outdoor temperatures, promoting greater heat loss, higher accumulations of creosote, and reduced draft which leads to poorer heater or furnace performance.

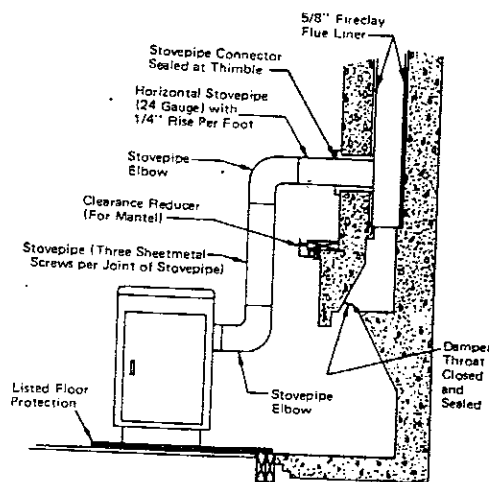

TYPE A FIG. 7
FIREPLACE CONVERSION

When considering a masonry chimney, round tiles are preferable to square or rectangular, as round tiles have much better airflow characteristics and are far easier to clean. Unfortunately, most North American chimneys use square or rectangular tile liners that are really designed for open fireplaces, not stoves or furnaces. Of most importance, second only to overall chimney height, is the diameter of the flue liner itself. In most instances, it should be sized to the appliance; i.e., 6" flue outlet on the appliance requires a 6" chimney. The inner diameter should never be less than the flue-outlet diameter and should never be greater than 50% of the appliance flue outlet. For example, do not expect a wood or coal burning stove or furnace to function properly if installed into a chimney with a flue liner greater than 50% more than the appliance outlet - - such as a 6" flue outlet requires a 6" diameter for optimum drafting, but can function well with an 8", but becomes border - line beyond an 8" diameter.

Masonry chimneys built of concrete blocks without flue liners of at least 5/8" fireclay do not meet modern building codes. A solid fuel appliance must not be joined to a chimney flue which is connected to another appliance burning other fuels.

If your chimney has a typically oversized flueliner of, say 8x12 inches, or greater, or if it is unlined, it will be necessary for you to re-line the chimney, using many of the modern approved and economical methods such as stainless steel, castable refractory, or properly sized fireclay linings.

If you have any questions regarding venting your appliance, feel free to contact the factory at the address and phone number on this Owner's Manual. You may also contact NFPA (National Fire Protection Association) and request NFPA Standard 211 (1984 Edition). Their address is Battery March Park, Quincy, Massachusetts 02269. Another helpful publication is NFPA Standard 908, available at the same address. Specify 1984 Edition of either of the above publications.

Rules For Connector Pipe Installation

1. The crimped end of the stovepipe fits inside the heater flue collar. Install additional pipe and elbow with the **CRIMPED END TOWARD THE HEATER**. This will allow any condensation in the flue to run back into the heater.
2. Slope any horizontal pipe upward toward the chimney at least 1/4 inch for each foot of horizontal run.
3. You must have at least 18 inches of clearance between any horizontal piping and the ceiling.
4. The pipe cannot extend into the chimney flue (Fig. 8).
5. Seal each connector pipe joint with furnace cement. Also seal the pipe at the chimney.
6. Use 3 sheet metal screws at each joint to make the piping rigid.
7. It is recommended that no more than two 90° bends be used in the stovepipe installation as more than two may decrease the amount of draw and possibly cause smoke spillage.
8. The chimney connector must not pass through an attic or roof space, closet, or any concealed space, or floor, ceiling, wall or combustive construction.

Fig. 8

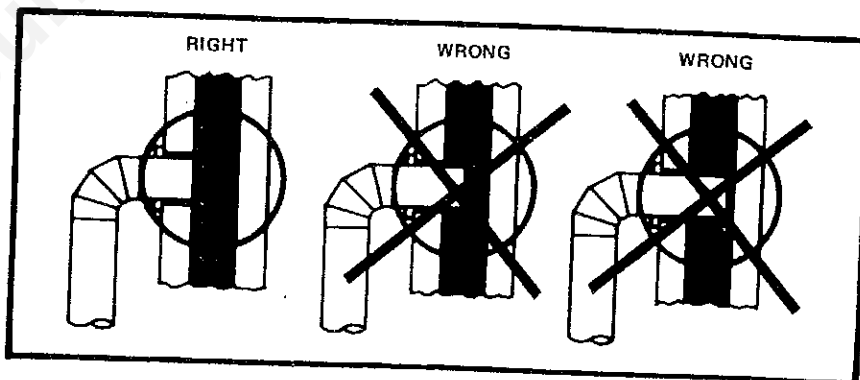

operating instructions

FUEL

Hardwood, 20" to 24" should be split and air dried, (seasoned) for 6 months to obtain maximum burning efficiency.

Wood should be stored in a dry, well ventilated area. A wooden box or crate is ideal for storage.

Use wood or wood-like materials only. Do not use coal. Coal or charcoal will destroy the Grates or Fire Box.

LIGHTING

1. Set the thermostat on "HIGH" to provide maximum draft.
2. Open the feed door and place paper and kindling on the grate for starting the fire.
3. Light Fire and close feed door.
4. Add fuel after fire is burning briskly. Use care not to smother the kindling fire.
5. Set thermostat to maintain desired temperature. "MEDIUM" setting is normally satisfactory. Set higher or lower for your comfort.

ADDING FUEL

When possible, add small amounts of fuel each hour or so instead of adding large quantities of fresh fuel every 8 to 10 hours. This will give more complete combustion and less build-up of tars or soot in the chimney.

1. Set Thermostat to HIGH before opening feed door.
2. Empty ash pan regularly. Do not allow ashes to build up to grate as grate will warp and burnout will occur, and you might spill the ashes when removing the pan. Dispose of hot ashes properly (see Note 11 on Page 3).

MINIMUM FIRE

The rate of burning at the low setting can be further adjusted by opening or closing the minimum fire air shutter (Fig. 9) on the draft control door.

1. Partially close the shutter to make the fuel burn longer.
2. Open the shutter, exposing a larger opening, to reduce the formation of creosote or soot (see Notes on Chimney Maintenance.).

CAUTION
STORING OF WOOD WITHIN
MINIMUM CLEARANCES OF HEATER
MAY CAUSE HOUSE FIRE

CAUTION
OVERFIRING THE APPLIANCE MAY
CAUSE A HOUSE FIRE. IF A UNIT
OR CHIMNEY CONNECTOR GLOWS,
YOU ARE OVERFIRING.

CAUTION
DO NOT OPERATE THE HEATER
WITH THE MINIMUM FIRE AIR
SHUTTER COMPLETELY CLOSED.

CAUTION
DO NOT OPERATE WITH FEED OR
ASH DOOR OPEN. THIS HEATER IS
DESIGNED FOR THERMOSTATIC
OPERATION. OPERATION WITH
EITHER DOOR OPEN WILL
OVERHEAT AND DAMAGE THE
HEATER.

WARNING
NEVER USE GASOLINE, GASOLINE-
TYPE LANTERN FUEL, KEROSENE,
CHARCOAL LIGHTER FLUID, OR
SIMILAR LIQUIDS TO START OR
"FRESHEN UP" A FIRE IN THE
HEATER.

WARNING
KEEP ALL FLAMMABLE LIQUIDS,
ESPECIALLY GASOLINE, FROM THE
VICINITY OF THE HEATER
WHETHER IN USE OR IN STORAGE.

CAUTION
BUILD A FIRE ON INTEGRAL GRATE
THAT IS PROVIDED WITH THE
HEATER.

Adjusting the thermostat

The thermostat control was calibrated at the factory. The operation of the heater may require a change in calibration. Calibration adjustments should be made at room temperature.

If the room temperature is not satisfactory, the thermostat operating range may be changed as follows:

- A. To increase the amount of heat at a "HIGH" setting, adjust the wire linkage to increase the draft damper opening (Fig. 15)
 1. Unhook linkage wire at Point "C".
 2. Take Point "A" in left hand and "B" in right hand, then turn "B" clockwise about 3 turns.
 3. Then hook linkage wire back to draft control damper door at Point "C".
- B. To decrease the amount of heat at "LOW" setting:
 1. Check feed and ash doors to be sure that they are closed tightly.
 2. Check the connector pipe to see that it is sealed in the flue collar and at all joints.
 3. If no air leaks are found, adjust linkage as above except turn "B" counterclockwise about 3 turns.
- C. Adjusting the Minimum Air Shutter:

The minimum air shutter has an infinite number of settings. Several adjustments may be necessary for the unit to work most effectively for your particular installation.

 1. The minimum air shutter may be adjusted to the closed position in installations where the draft is "above normal". Generally, .06 w.c. or above would be considered "above normal".
 2. In installations where the draft is "below normal", the minimum air shutter would be adjusted toward the open position.

Fig. 9

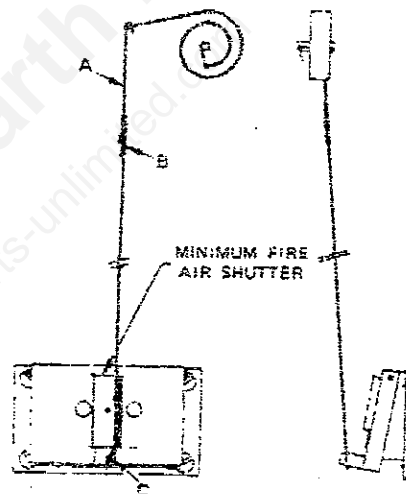

NOTE: More than one recalibration may be necessary. At room temperature (72° F) and "LOW" setting, the draft damper door should be closed.

How to Lift the Top

CAUTION - DO NOT OPEN OR CLOSE TOP WHEN HEATER IS HOT!

To open, grasp TOP at front and lift all the way, then gently lower the TOP until the TOP SUPPORT ROD latches to hold the TOP (Fig. a).

To close, lift TOP until the TOP SUPPORT ROD is unlatched. Pull the ROD forward and lower the TOP (Fig. b).

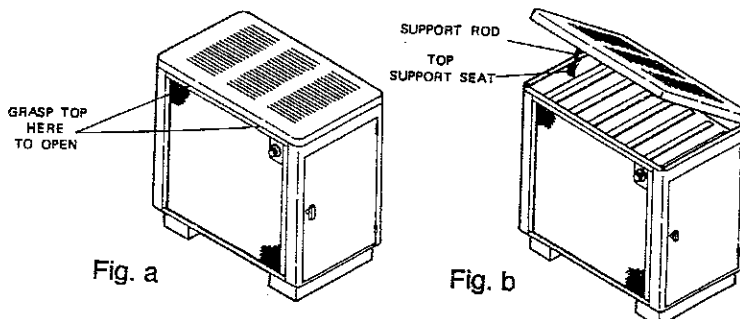

service hints

Do not expect a heater to draw. It is the chimney that creates the draft. Smoke spillage or excessive build-up of water or creosote in the chimney are warnings that the chimney is not functioning properly. Correct the problem before using furnace. Possible causes are:

1. The connector pipe may be pushed into the chimney too far, stopping the draft (Fig. 9).
2. Do not connect two heaters into the same chimney flue.
3. The chimney used for a heater must not be used to ventilate the cellar or basement, if there is a cleanout opening at the base of the chimney, it must be closed tightly.
4. If the chimney is operating too cool, water will condense in the chimney and run back into the stove. Creosote formation will be rapid and may block the chimney. Operate the heater at a high enough fire to keep the chimney warm preventing this condensation.
5. If the fire burns well but sometimes smokes or burns slowly, it may be caused by the chimney top being lower than another part of the house or a nearby tree. The wind blowing over a house or a tree, falls on top of the chimney like water over a dam, beating down the smoke. The top of the chimney should be at least 3 feet above the roof and be at least 2 feet higher than any point of the roof within 10 feet (Fig. 6).

NOTE:

A draft reading of .05 to .06 w.c. is suggested for proper burning of this unit.

chimney maintenance

CREOSOTE - FORMATION AND NEED FOR REMOVAL

When wood is burned slowly, it produces tar and other organic vapors, which combine with expelled moisture to form creosote. The creosote vapors condense in the relatively cool chimney flue of a slow-burning fire. As a result, creosote residue accumulates on the flue lining. When ignited, this creosote makes an extremely hot fire.

The chimney connector and chimney should be inspected at least twice monthly during the heating season to determine if a creosote build up has occurred.

If creosote has accumulated, it should be removed.

Failure to remove creosote or soot may cause a house fire. Creosote may be removed by using a chimney brush or other commonly available materials.

Chimney fires burn very hot. If the chimney connector should glow red, immediately call the fire department, then reduce the fire by closing the inlet air control and pour a large quantity of coarse salt, baking soda or cool ashes on top of the fire in the firebox. CAUTION: A chimney fire may cause ignition of wall studs or rafters which you thought were a safe distance from the chimney. If you have a chimney fire, have your chimney inspected by a qualified person before using again.

Cabinet Door Catch Assembly

The door knob is mounted inside of the cabinet door to facilitate shipping and must be reversed for proper usage.

To get cabinet door open, place hand under cabinet frame (right hand side - cabinet door side) and push door out.

INSTALL THE CABINET DOOR KNOB USING THE STEPS BELOW:

1. Remove the machine screw and door knob (Fig. 10)
2. Place door knob on outside of cabinet door. Then place machine screw through hole and into door knob and tighten (Fig. 11)

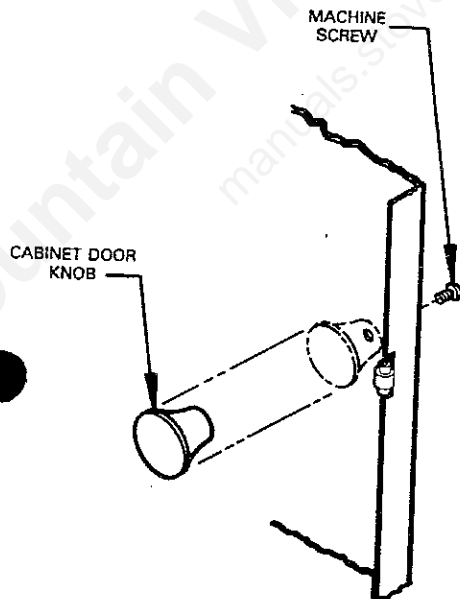

Fig. 10

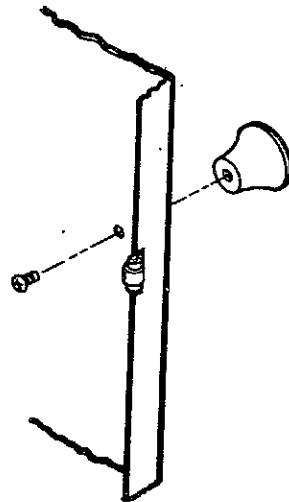
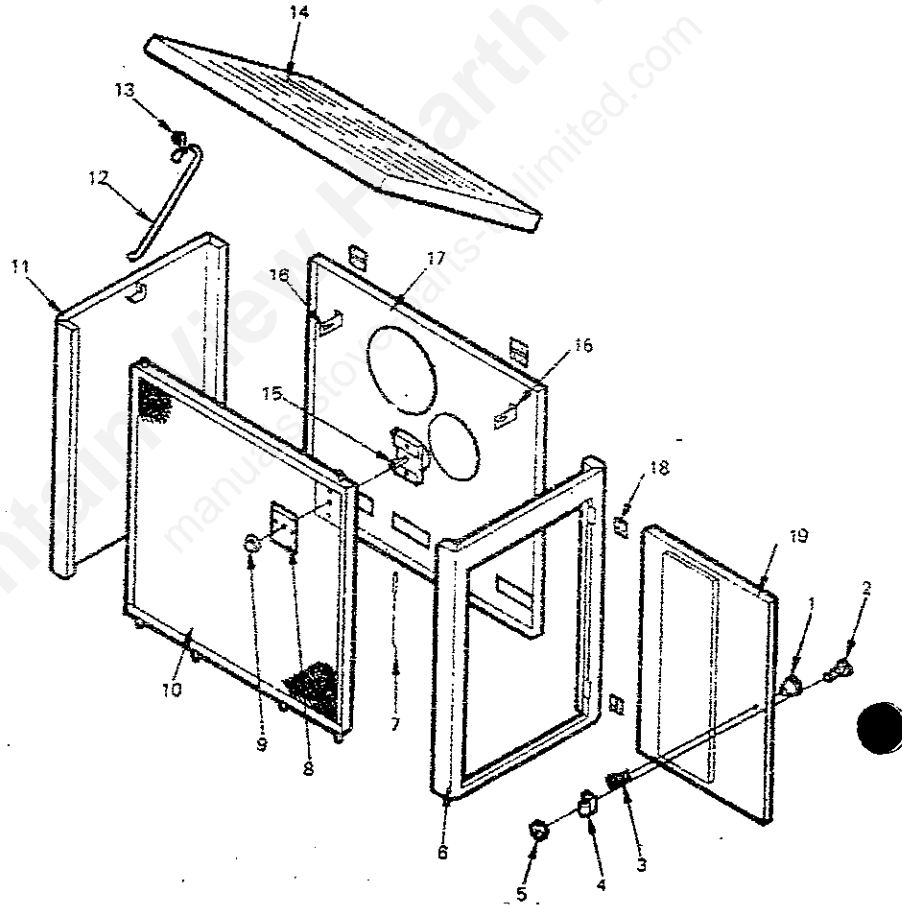

Fig. 11

repair parts

AUTOMATIC WOODBURNING CIRCULATOR
MODEL NUMBER 2721



repair parts

AUTOMATIC WOODBURNING CIRCULATOR
MODEL NUMBER 2721

Key No.	Part No.	Description	Qty.
1	89062	DOOR KNOB	1
2	83033	MACHINE SCREW (8 - 32 X 1/4)	1
3	83005	MACHINE SCREW (10-24 X 1/2)	1
4	83093	SPRING LATCH	1
5	83244	NUT (KEP. 10-24 PLAIN)	1
6	67968	CAB. RIGHT SIDE	1
7	86191	THERMOSTAT LINKAGE ADJUSTER	1
8	85389	CONTROL PANEL PLATE	1
9	89142	THERMOSTAT KNOB	1
10	67902	CABINET FRONT	1
11	67967	CAB. LEFT SIDE	1
12	21593	HINGE SUPPORT	1
13	83833	HINGE CLIP	1
14	67966	CABINET TOP	1
15	67743	THERMOSTAT	1
16	21063	BACK BRACE	2
17	67514	CABINET BACK	1
18	89065	DOOR HINGE	4
19	67969	CABINET BACK	1

repair parts

AUTOMATIC WOOD BURNING CIRCULATOR
MODEL NUMBER 2721

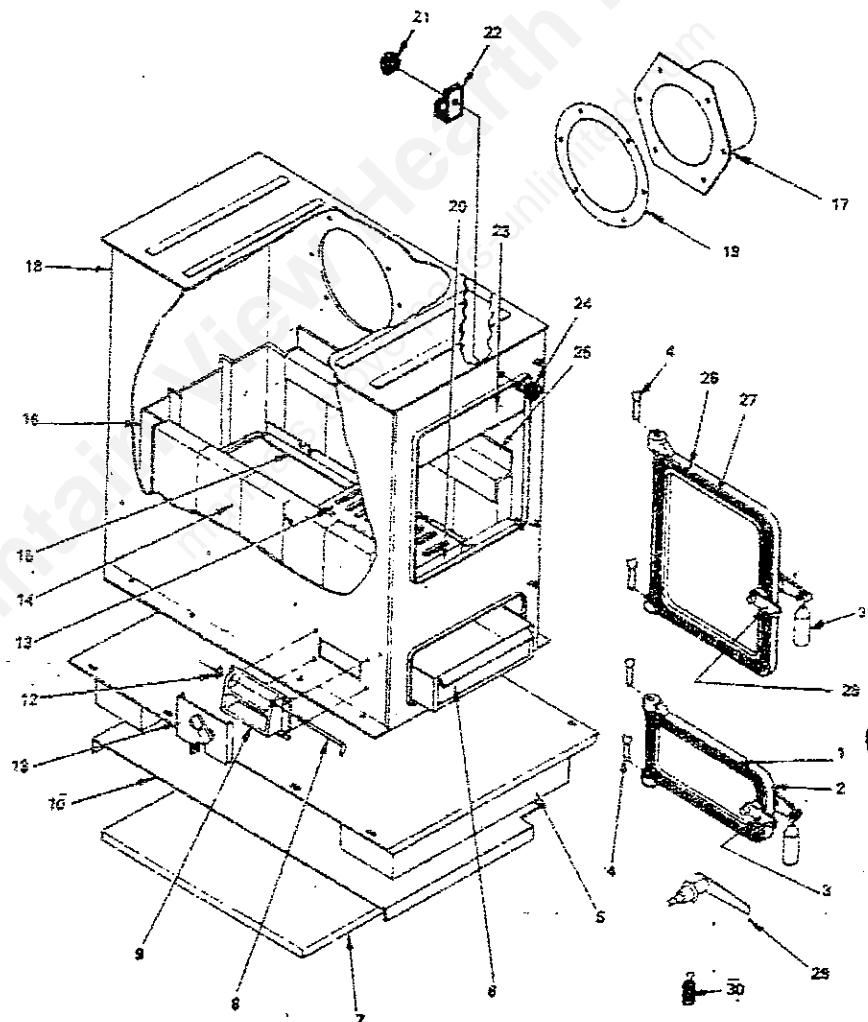

repair parts

AUTOMATIC WOODBURNING CIRCULATOR
MODEL NUMBER 2721

Key No.	Part No.	Description	Qty.
1	21803SV	ASH DOOR, GASKET	1
2	67781SV	ASH DOOR (INCLUDES HANDLE AND GASKET)	1
3	22108	LATCH, ASH DOOR	1
4	83114	HINGE PIN	4
5	67859	BASE	1
6	67444	ASH PAN	1
7	22110	HEAT SHIELD	1
8	17200	DRAFT DAMPER PIN	1
9	40075	DRAFT DAMPER FRAME	1
10	67806	SECOND FLOOR SHIELD	1
11	67132	DRAFT DAMPER	1
12	83818	CLIP SPRING	2
13	40076	FIREGRATE	2
14	89066	FIREBRICK	10
15	66080	GRATE & LINER SUPPORT	2
16	17130	BACK LINER	1
17	40246	FLUE COLLAR	1
18	67858	HEAT JACKET	1
19	88032	FLUE COLLAR GASKET	1
20	22247	FRONT LINER	1
21	83250	NUT (KEP 1/4 - 20)	2
22	22171	SMOKE CURTAIN BRACKET	2
23	22090	SMOKE CURTAIN	1
24	83086	MACHINE SCREW (1/4-20X1/2 PH TH 2)	2
25	17350	FIREBRICK RETAINER	2
26	67775SV	FEED DOOR (INCLUDES HANDLE & GASKET)	1
27	21804	FEED DOOR GASKET	1
28	21047	LATCH FEED DOOR	1
29	40091	DOOR HANDLE	2
30	89920	WOOD HANDLE (OPTIONAL)	2
31	89523	WOOD HANGER HANDLE	2
*	85382J	OWNERS MANUAL	
*		NOT SHOWN	

owners manual

HOW TO ORDER REPAIR PARTS

THIS MANUAL WILL HELP YOU TO OBTAIN EFFICIENT, DEPENDABLE SERVICE FROM THE HEATER, AND ENABLE YOU TO ORDER REPAIR PARTS CORRECTLY.

KEEP IN A SAFE PLACE FOR FUTURE REFERENCE.

WHEN WRITING, ALWAYS GIVE THE FULL MODEL NUMBER AND SERIAL NUMBER WHICH IS ON THE NAMEPLATE ATTACHED TO THE INSIDE OF THE CABINET DOOR OF THE HEATER.

WHEN ORDERING REPAIR PARTS, ALWAYS GIVE THE FOLLOWING INFORMATION AS SHOWN IN THIS LIST:

1. The PART NUMBER
2. The PART DESCRIPTION
3. The MODEL NUMBER: 2721C
4. The SERIAL NUMBER: _____

BEFORE INSTALLING YOUR CIRCULATOR, FILL IN THE SERIAL NUMBER OF YOUR CIRCULATOR, WHICH IS ON THE NAMEPLATE, IN THE SPACE PROVIDED ABOVE.

UNITED STATES STOVE COMPANY

111 Industrial Drive
South Pittsburg, Tennessee 37380 - (615) 837-2100