



COMBINATION COAL AND WOOD BURNING CIRCULATOR HEATER MODEL 9901B1

Installation, Operation and Maintenance Instructions

TABLE OF CONTENTS

IMPORTANT INFORMATION	1
HOW THIS HEATER OPERATES	1
BUILDING CODES AND SAFETY STANDARDS	1
SELECTING A LOCATION FOR THE HEATER	1
UNPACKING AND INSPECTION	3
CHIMNEY CONNECTOR AND CHIMNEYS	3
FLOOR PROTECTION	3
TOOLS & SUPPLIES NEEDED FOR INSTALLATION	3
INSTALLATION PROCEDURE	3
HEATER OPERATION	4
MINIMUM FIRE ADJUSTMENT	5
WOOD AND COAL STORAGE	5
HEATER AND CHIMNEY MAINTENANCE	6
Disposal of Ashes	6
Chimney Connector and Chimney	6
Heater Maintenance	6
CORRECTION OF OPERATIONAL PROBLEMS	6
FINAL CHECKLIST OF DO'S AND DON'TS	7

IMPORTANT INFORMATION

SAFETY NOTICE: IF THIS HEATER IS NOT PROPERLY INSTALLED, A HOUSE FIRE MAY RESULT. FOR YOUR SAFETY, FOLLOW THE INSTALLATION INSTRUCTIONS. CONTACT LOCAL BUILDING OR FIRE OFFICIALS ABOUT RESTRICTIONS AND INSTALLATION INSPECTION REQUIREMENTS IN YOUR AREA.

To assure that satisfactory and safe service is received from this heater:

1. Read these instructions entirely before beginning any part of the installation.
2. Use these instructions as a guide during the installation of the heater.
3. Be sure these instructions become the property of and are reviewed by all future users of this heater to encourage proper operation and maintenance of this appliance.

This heater is designed to burn wood or stove size bituminous or anthracite coal and provide heat to one or more rooms. Because of its heat radiating characteristics, this heater must be installed as an unenclosed, freestanding unit with clearances to combustibles as specified by these instructions. This heater must be connected to an Underwriters' Laboratories, Inc. Listed Factory-Built Residential Type And Building Heating Appliance Chimney or a properly constructed and maintained masonry chimney.

DO NOT CONNECT THIS UNIT TO A CHIMNEY FLUE SERVING ANOTHER APPLIANCE.

This heater is not designed to burn liquid fuels, gaseous fuels or household refuse. Any attempt to burn these type fuels, to enclose the heater or to attach the heater to an air circulation system or a stoking device can be very hazardous. **THIS HEATER IS NOT DESIGNED TO BE USED IN A MOBILE HOME.**

HOW THIS HEATER OPERATES

The chimney draft draws in combustion air through an adjustable air inlet thermostat located inside the cabinet. Air flows through and across the bed of fuel, causing the fire to progress through the fuel bed. Heat is transferred to the air that flows between the cabinet and the firebox. Any attempt to alter this flow of air by connecting this heater to a duct system or air movement fans other than the optional UL listed blower, available from your King dealer, can lead to improper and possibly hazardous operation of this heater.

BUILDING CODES AND SAFETY STANDARDS

These instructions comply with the applicable National Fire Protection Association and Underwriters' Laboratories, Inc. Standards for the installation and operation of this type heater. Before beginning the installation, you should check with local building officials to assure compliance with local regulations and codes.

Look for the Underwriters' Laboratories, Inc. listing mark on your heater.

SELECTING A LOCATION FOR THE HEATER

When selecting a location for the heater, be sure attention is given to the following considerations:

1. If the heater is to be vented into a Factory-Built Residential Type And Building Heating Appliance Chimney, review the installation instructions for the chimney to comply with requirements for proper chimney location, height, space requirements, etc.

2. If the heater is to be vented into a masonry chimney, the heater should be located as near the chimney as possible without failing to comply with the requirements for minimum spacing between the chimney connector, heater and combustibles. (Be sure chimney is constructed according to NFPA standards.)
3. The location of the heater must provide at least the minimum clearances between the heater, chimney connector and combustible materials as specified by figures 1, 2, and 3.
4. If the heater is to be located on a combustible floor, there must be suitable floor space to install a floor protector beneath and extending beyond the heater as shown by figure 4.
5. The heater should be located centrally within the area where heat is desired but out of traffic areas to minimize the likelihood of persons accidentally contacting the hot surface of the heater.
6. The heater should be located away from doorways and central heat outlets and inlets to reduce the chances of drafts blowing smoke, ashes or sparks out of the heater during refueling or ash removal.
7. The heater should be located where a small supply of wood or coal may be kept conveniently close but not within 36 inches of the heater.
8. Locate the heater so that drapes, curtains, furniture and other combustible materials will not be closer than the clearances shown in figures 1, 2 and 3.

FIGURE 1

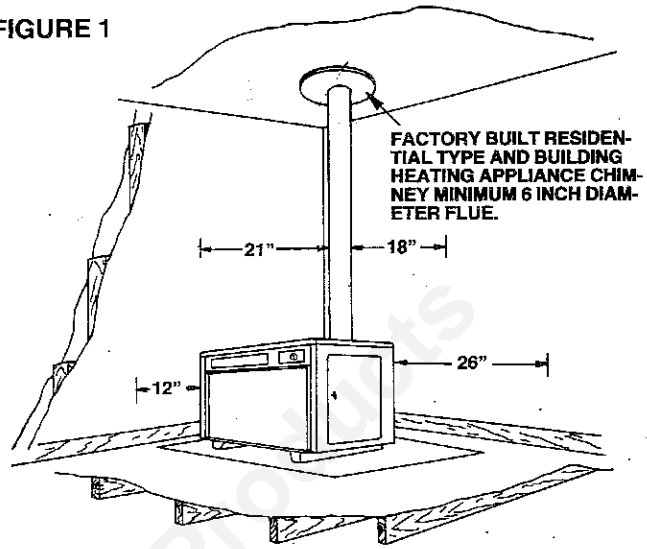

FIGURE 2

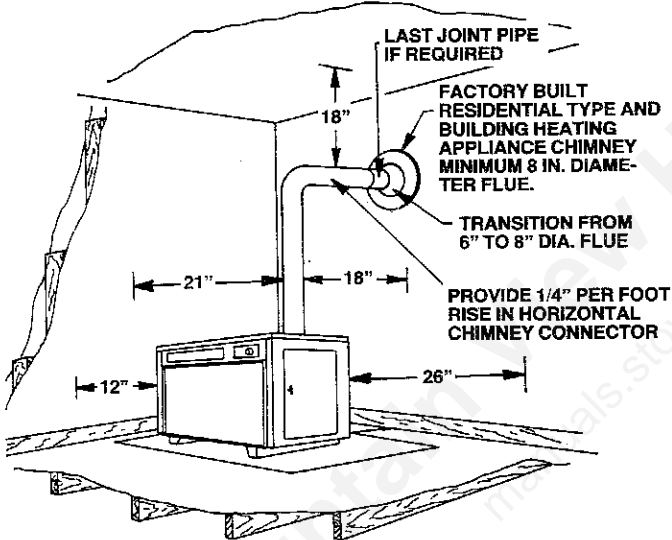
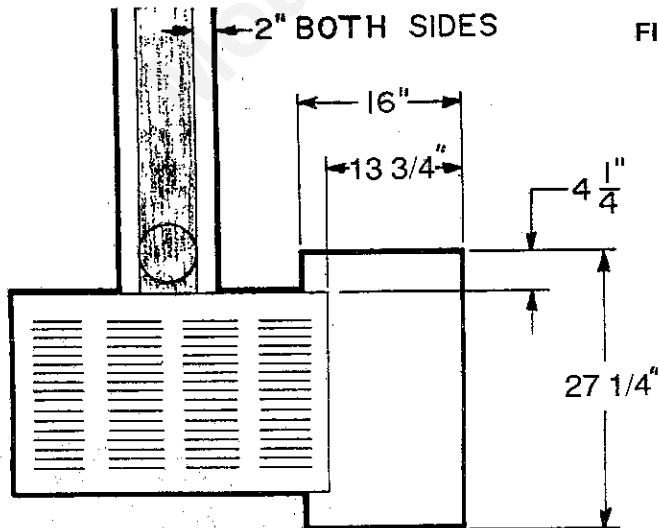
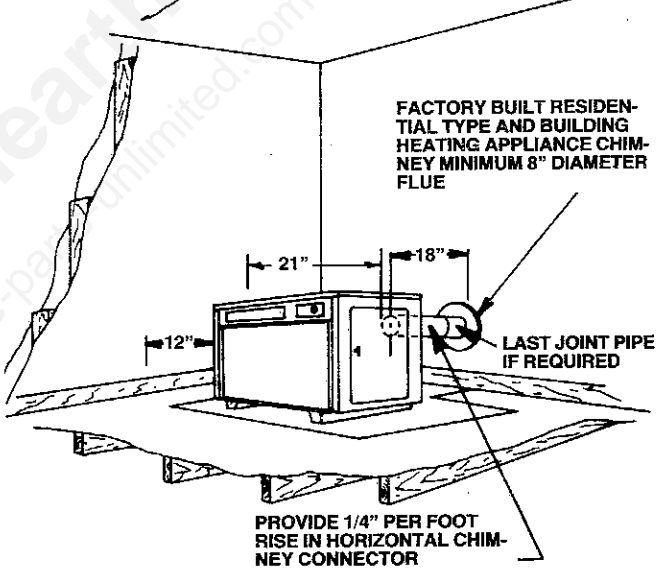
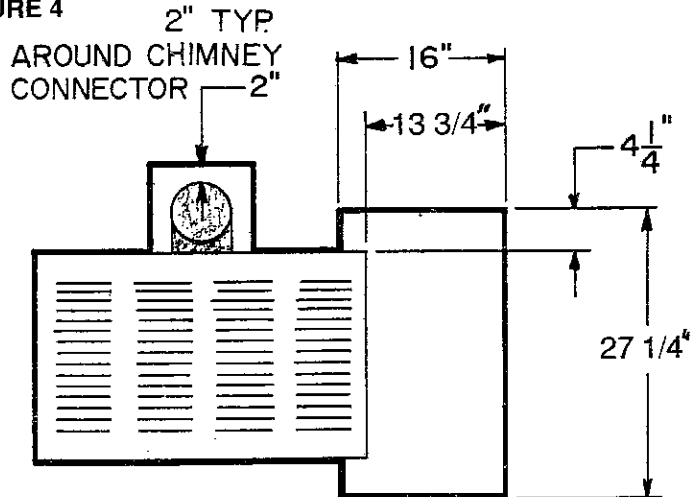

FIGURE 3



PLAN VIEW OF INSTALLATION WITH HORIZONTAL FLUE PIPE TO SHOW OUTLINE OF MINIMUM SIZE FOR NON-COMBUSTIBLE FLOOR COVERING OR UL LISTED FLOOR PROTECTOR.

FIGURE 4



PLAN VIEW OF INSTALLATION WITH VERTICAL FLUE PIPE TO SHOW OUTLINE OF MINIMUM SIZE FOR NON-COMBUSTIBLE FLOOR COVERING OR UL LISTED FLOOR PROTECTOR.

UNPACKING AND INSPECTION

Remove the heater from the packaging materials. Inspect the heater for external damage or missing parts. Check the gaskets around the doors to assure that they are still in place. Check the inside of the heater. If any parts are found to be damaged or missing, report these to your dealer and make sure all problems are resolved before installing the heater.

CHIMNEY CONNECTOR AND CHIMNEYS

It is very important to assure safe and satisfactory performance from your heater that it be properly connected to a correctly constructed and maintained chimney. If a Factory-Built Residential and Building Heating Appliance Chimney is used, follow the chimney manufacturer's installation instructions carefully. If a masonry chimney is to be used, be sure it is constructed to the National Fire Protection Association (N.F.P.A.) and local code standards. A copy of the N.F.P.A. 211 Chimney, Fireplaces, Vents and Solid Fuel Burning Appliances may be obtained from N.F.P.A., Inc. Batterymarch Park, Quincy, MA 02269.

The chimney connector (pipe from heater to chimney) must be 6 inches in diameter and made from 24 gauge or heavier steel. The length of the chimney connector and number of elbows used should be kept to a minimum. Moisture that might collect in the chimney should be directed to the heater by providing a slope of 1/4 inch per foot in a horizontal run of the chimney connector and installing all pipes with the male end toward the heater. (See figure 5.) The chimney connector should extend at least two inches into the flue of a factory-built chimney. When making a horizontal connection to a masonry chimney, the connector should extend to the inside face of the vertical flue liner, (See figure 6).

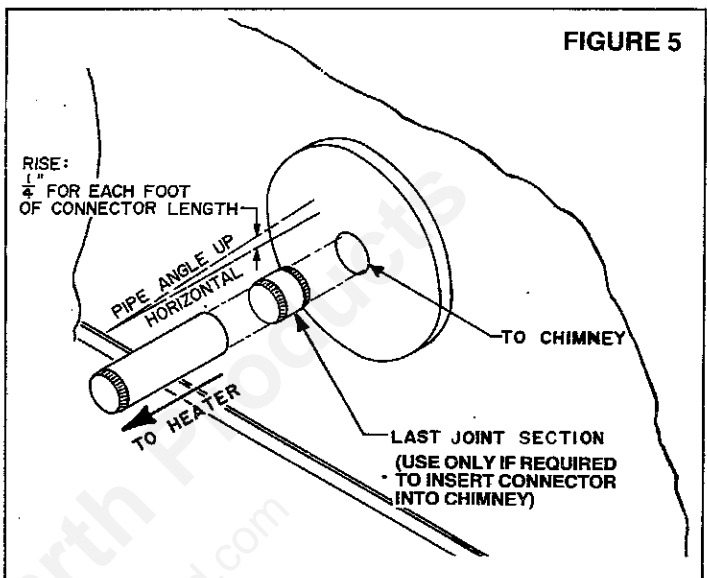

NOTE: The inside diameter of some chimney thimbles are too small to accept a standard six inch diameter chimney connector pipe. If you encounter this problem, the last joint pipe included with your heater can be used as shown by figures 2, 3, and 5. Be sure the last joint pipe is securely attached to the chimney connector with screws and sealed at each end with furnace cement. Be sure all chimney connector joints are sealed with furnace cement and secured with 3 screws.

DO NOT USE MORE THAN TWO 90 DEGREE ELBOWS IN THE CHIMNEY CONNECTOR. Installations which require two 90 degree elbows must be vented into a flue at least 8" in diameter or 8" square. (See figure 2).

DO NOT PASS A CHIMNEY CONNECTOR THROUGH A FLOOR, CEILING, OR WALL OF ANY KIND. Only Listed Factory-Built Residential Type and Building Heating Appliance chimneys or masonry chimneys constructed to N.F.P.A. standards should pass through these structures.

FLOOR PROTECTION

This heater has been designed to prevent excessive temperatures on the floor beneath the heater. It is important, however, that a combustible floor be protected by a noncombustible floor covering or U.L. listed floor protector beneath the heater and extending beyond the heater as shown by figure 4. The floor covering is required to prevent damage or possible ignition from sparks or glowing embers that might escape the heater during refueling or ash removal or could drop from the joints of the chimney connector. Noncombustible materials are materials that will not burn such as steel, brick, stone, concrete, etc.

TOOLS AND SUPPLIES NEEDED FOR INSTALLATION

Electric drill 1/4 or 3/8 inch drive	10-24 x 1 Bolts, nuts and lockwashers (2 required)
1/8 inch drill bit	Can or tube of furnace cement
1/4 inch drill bit	Floor protector
Screwdriver (blade type and size to fit screws listed below)	Rag or several paper towels
No. 8 sheet metal screws (3 for each joint of chimney connector)	Chimney connector pipes (and elbows, if required)

INSTALLATION PROCEDURE

If this heater is not installed as specified by this installation manual and local codes, a serious fire may occur.

1. Install a Factory-Built Residential Type and Building Heating Appliance Chimney, build a masonry chimney or adapt an existing masonry chimney to vent the heater. (See the CHIMNEY CONNECTOR AND CHIMNEYS section of this manual for important information.)
2. Purchase the 6 inch diameter chimney connector pipes that are required.
3. If the heater is to be installed on a combustible floor, purchase a noncombustible floor protector and install it in the proper location. (See figure 4.)
4. Assemble the chimney connector sections to determine if the chimney connector will correctly extend from the heater flue collar to the chimney. See the CHIMNEY CONNECTOR AND CHIMNEYS section of this manual for important information.

- After it is determined that the assembled chimney connector will properly connect the heater to the chimney, disassemble all sections in preparation for the first assembly procedures.
- Position the first section of chimney connector pipe inside the heater flue collar and drill two 1/4 inch diameter holes in the pipe sections to match the holes in the flue collar.
- Apply furnace cement to the mating surfaces of the flue collar and chimney connector pipe so that an airtight seal is formed as the pipe is put into place and fasten the pipe joint in place with 10-24 bolts, nuts and lock washers.
- Assemble the remaining sections of chimney connector by applying furnace cement to each joint, drilling 1/8 inch diameter holes for and attaching each joint with 3 sheet metal screws.
- Wipe all excess furnace cement from the pipe joints with a rag or paper towels.

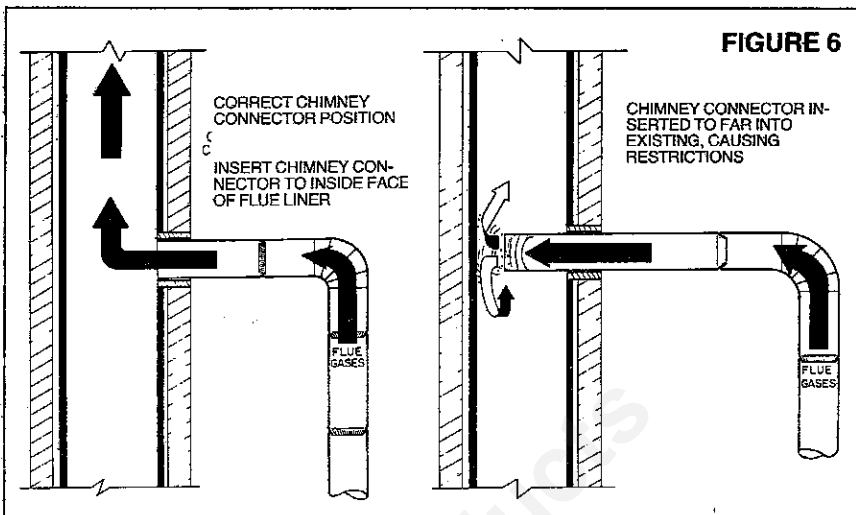

HEATER OPERATION

This heater must be operated as outlined in this manual or a serious fire may occur.

THE PAINT ON THE EXTERIOR OF THE FIREBOX WILL GO THROUGH A CURING PROCESS DURING THE FIRST FIRING OF THE HEATER AND WILL EMIT SOME SMOKE AND ODOR. BE PREPARED FOR THIS BY RAISING A WINDOW OR OPENING A DOOR TO PROVIDE VENTILATION.

The first time the heater is fired, the fire should be regulated so as to increase in intensity gradually to allow the paint to cure slowly and the other components to adjust to their expanded size.

To Build a Fire:

- Set the thermostat to the "HI" position.
- Open the feed door (see figure 7) and lay paper and/or kindling on the grate in sufficient quantities to ensure continued ignition.

WARNING: NEVER USE GASOLINE, GASOLINE TYPE LANTERN FUEL, KEROSENE, CHARCOAL LIGHTER FLUID, OR SIMILAR LIQUIDS TO START OR "FRESHEN UP" A FIRE IN THIS HEATER. KEEP ALL SUCH LIQUIDS WELL AWAY FROM THE HEATER WHILE IT IS IN USE. FAILURE TO COMPLY WITH THIS WARNING COULD CAUSE AN EXPLOSION.

- Light the fire.
- Close the feed door (see figure 7) and the ash door.
- Add larger pieces of wood as the fire gains in intensity. As soon as the fire is established, wood or coal may be added as desired.

CAUTION: OPERATING THE HEATER WITH THE ASH DOOR OR FEED DOOR OPENED CREATES AN ABNORMAL FIRING CONDITION WHICH CAN OVERHEAT THE HEATER, CHIMNEY AND ADJACENT COMBUSTIBLE MATERIALS. THIS CAN DRASTICALLY SHORTEN THE HEATERS LIFE AND VOID THE FACTORY WARRANTY

- MAKE SURE THAT THE FEED DOOR, ASH DOOR AND CABINET DOOR ARE SECURELY CLOSED.
- Set the thermostat to a point midway between "HI" and "LO". If the house or heating situation requires a higher or lower setting to obtain the desired amount of heat, adjust the thermostat setting appropriately.

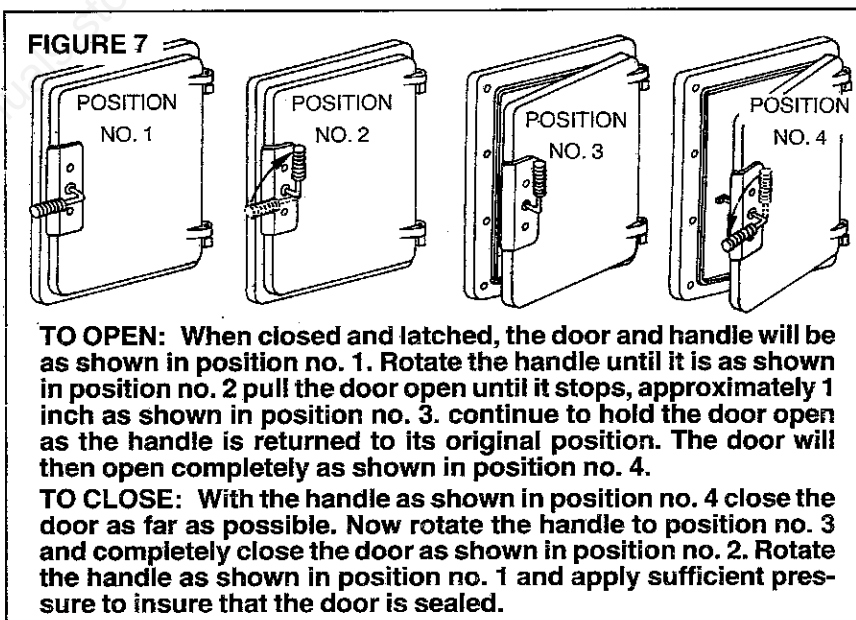

Firetending

Firetending is the occasional poking or stirring of the burning fuel bed to ensure airflow through the fire and adding new wood or coal as needed. With experience, you should determine how often fire tending is required to maintain the desired heat output of the heater. To ensure safe and satisfactory performance of the heater, the following rules should be observed:

- KEEP THE FEED AND ASH DOORS CLOSED EXCEPT WHEN TENDING THE FIRE OR REMOVING ASHES. Operating the heater with the doors open can cause the heater to overheat and will increase the possibility of smoke, ash or sparks escaping the heater and damaging the dwelling or its contents.
- NEVER FILL THE HEATER SO THAT BURNING COAL IS ABOVE THE TOP OF THE FIREBOX LININGS. This can cause the heater to overheat and will shorten its life.

3. NEVER OPEN THE FEED DOOR WITHOUT FIRST TURNING THE THERMOSTAT TO "HI" FOR AT LEAST 30 SECONDS.
4. ADD ONLY SMALL AMOUNTS OF FRESH WOOD OR COAL TO THE HEATER AT EACH REFUELING. Adding large amounts of fresh wood or coal can cause an accumulation of gases above the fire that can cause backpuffing. Backpuffing can occur whenever concentrated gases accumulate over the fire bed and then catch fire quickly. This may cause smoke and flame to be expelled from the heater during fire tending but under rare conditions, backpuffing can be severe enough to break apart poorly connected chimney connector pipes. If backpuffing is experienced, see CORRECTION OF OPERATIONAL PROBLEMS section of this manual. This is an abnormal condition and a potential hazard. Determine and correct the cause.

Adding large amounts of wood or coal to the fire causes a rapid cooling of the chimney and the release of excessive amounts of water vapor up the chimney. This can cause excessive creosote or soot accumulation in the chimney. Refer to the heater and chimney maintenance section of this manual for more information concerning creosote.

5. TURN THERMOSTAT TO "HI" FOR 15 MINUTES AFTER ADDING FRESH WOOD OR COAL TO A FIRE. This allows the gases to be driven off and shortens the length of time the dense smoke is likely to deposit soot or creosote on the chimney walls.
6. DO NOT TAMPER WITH THE INTERNAL THERMOSTAT MECHANISM. The thermostat has been designed and calibrated to provide continuous control of the fire for safety and efficiency. Thermostat adjustments are made with the thermostat control knob only. (See figure 8.)
7. PREPARE THE HEATER TO HOLD FIRE ALL NIGHT BY LOADING IT WITH WELL DRIED WOOD OR COAL AT LEAST AN HOUR BEFORE BEDTIME. Burn the heater at the normal rate for this hour, then turn it back to a slower burn just before going to bed. This procedure will help drive excess moisture and gases out of wood or coal and minimize creosote or soot buildup during the night. This procedure also minimizes the likelihood of backpuffing.
8. DO NOT OVERFIRE THE HEATER. If any part of the heater or chimney connector become red hot, turn the thermostat to low and keep the ash and feed doors closed until the heater cools.

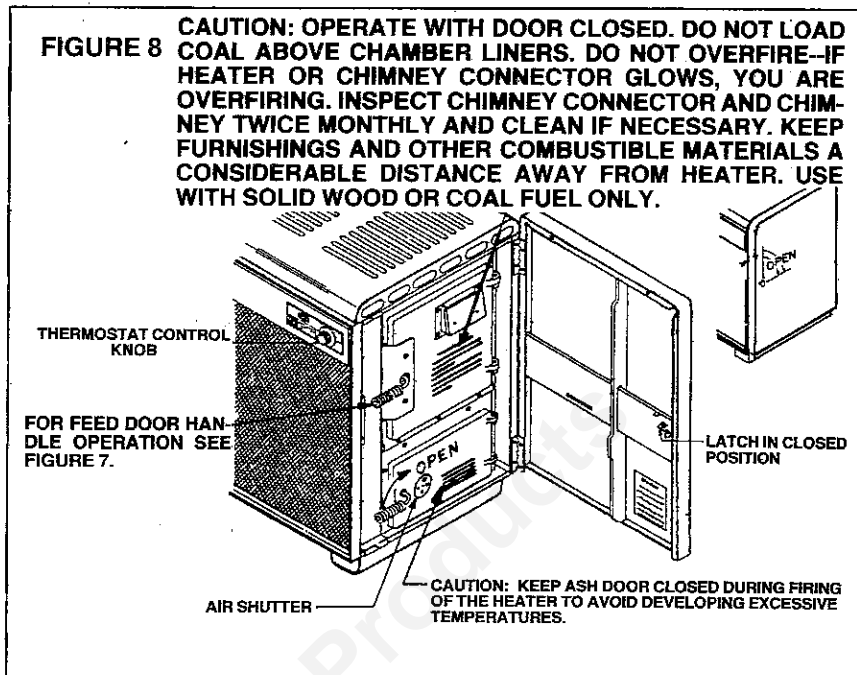

MINIMUM FIRE ADJUSTMENT

Creosote is more likely to accumulate in the chimney connector and chimney liner during extended periods of low firing. This accumulation can be reduced by proper setting of the air shutter on the ash door. (See figure 8.)

Rotating the air shutter to allow more air into the fire chamber will increase the rate of the minimum fire and reduce the accumulation. Experience in a particular heating situation will give guidance in choosing the best setting. Setting changes are made with common pliers. Set the shutter to the largest opening and use a smaller opening only if the heat output cannot be adequately controlled by the thermostat.

WOOD AND COAL STORAGE

The small amounts of wood or coal used in daily fire tending should be kept in a noncombustible container at least 36 inches from the heater.

Two wood characteristics largely determine the amount of heat energy per cord. The first is moisture content. Wood must be dry before it will burn properly. When first cut, its moisture content is high so wood burns poorly and encourages the formation of creosote. It should be cut and stored in a dry place several months, preferably a year before it is used. Splitting the wood before it is stored reduces its drying time and exposing both ends to the air aids in drying. After wood has been stored from six to twelve months, it will be dried to a moisture content of 15 to 25 percent. This drying results in more even burning and will minimize the buildup of creosote in your chimney.

The second factor determining heat output of wood is its density or weight per cord. With equal seasoning and dryness, heavier, denser wood has more heating value per cord. For example, hickory is denser wood than pine, so a cord of hickory will give more heat than a cord of pine.

For more specific information on how to select and obtain good fire wood, obtain the U.S. Department of Agriculture--Forest Service Leaflet No. 559 by writing to Superintendent of Documents, U.S. Government Printing Office, Washington, D.C., 20402.

For longer and safer heater life, never use manufactured composition logs, salt water soaked wood (driftwood), or chemical additives in this heater.

Coal that is improperly stored can catch fire from heat generated by chemical changes occurring within the coal bed (spontaneous combustion). To avoid the development of these conditions, coal quantities that will be stored more than three days should be kept clean of all combustible materials, such as leaves, hay, wood, rags, etc. and stored where the temperature of the air and objects the coal contacts are 75 degrees F. or less. Alternate wetting and drying of coal should be avoided. Wet and dry

coal should never be stored where each will be in contact with the other.

If the emission of heat or unusual odors from a coal storage area is observed, the process leading up to spontaneous combustion may be occurring and the fire department should be called immediately.

HEATER AND CHIMNEY MAINTENANCE

Disposal of Ashes

Ashes should be placed in a metal container with a tight fitting lid. The closed container of ashes should be placed on a non-combustible floor or on the ground, well away from all combustible materials, pending final disposal. If the ashes are disposed of by burial in soil or otherwise locally dispersed, they should be retained in the closed container until all cinders have thoroughly cooled.

Wear noncombustible gloves to protect your hands from hot surfaces when removing the ashes from the heater. Ashes should not be allowed to accumulate until they obstruct the airflow through the fuel bed. If ashes are allowed to accumulate to within two inches of the bottom of the grates, poor burning of the fuel is likely, and the grates will be damaged from overheating.

Chimney Connector and Chimney

Creosote and Soot - Formation and Need for Removal

When wood is burned slowly, it produces tar and other organic vapors, which combine with expelled moisture to form creosote. When coal is burned, the products of combustion combine with moisture to form a soot residue. The creosote vapors condense and the soot residue form in the relatively cool chimney flue of a slow burning fire and accumulates on the flue lining. When ignited the creosote or soot makes an extremely hot fire.

The chimney connector and chimney should be inspected at least twice monthly during the heating season to determine if a creosote or soot buildup has occurred. If creosote or soot has accumulated, it should be removed to reduce the risk of a chimney fire.

A chimney fire is usually indicated by a roaring noise within the chimney and/or a pinging noise within the chimney connector. Well developed chimney fires will emit ash and sparks from the top of the chimney.

If a chimney fire occurs, turn the thermostat to "LOW", keep the feed, ash and cabinet doors closed, call the fire department and protect the roof by wetting it with a garden hose or buckets of water. After the chimney fire is over, thoroughly inspect all combustible materials around the chimney and chimney connector for fires that might have been ignited by the intense heat. The chimney and chimney connector should then be inspected for any damage and repairs made if necessary.

Although a properly constructed chimney should not be damaged by a chimney fire, it is best to prevent a chimney fire by:

1. Burning well seasoned wood. Green or wet wood increases the chances of creosote forming.
2. Not burning small smoldering fires for long periods of time. Small smoldering fires tend to allow the chimney to stay relatively cool, increasing the chances of creosote and soot forming. A small load burning quickly is far better than a large smoldering load. Less fuel and less chimney cleaning will be required if smaller loads are burned in this manner.
3. Cleaning and inspecting the chimney regularly (inspect at least twice monthly during heating season to determine if creosote buildup has occurred).
4. Preparing the fire for night burning, (see item 7 under FIRETENDING).

There are special brushes available for chimney cleaning and many areas have professional chimney cleaning services. Most fire departments will make free chimney inspections and can provide help in locating chimney services.

(YOU SHOULD ALWAYS CLEAN AND INSPECT YOUR CHIMNEY BEFORE EACH HEATING SEASON.)

Heater Maintenance

The porcelain surfaces of the heater may be wiped free of dust with a soft cloth. The use of any other cleaning method may damage the porcelain.

Check the following items regularly during the heating season to ensure proper heater operation:

1. Condition of feed door and ash door gaskets--replace if excessive wear is observed.
2. Condition of feed door, ash door and cabinet latching pawls and handles--ensure that operation will securely close the door. Adjust as necessary.

At the end of each heating season, the heater should be thoroughly cleaned of all ashes. Ashes remaining in the heater in combination with moisture in the air can cause severe corrosion of the heater. All rust spots on the heater should be wire brushed and covered with a coat of high temperature paint. If the heater is to be stored until the next heating season, be sure the storage area is dry.

The heater should never be used with damaged or missing parts.

CORRECTION OF OPERATIONAL PROBLEMS

1. Symptom: Fire rate does not increase with thermostat open, smoke spilling from feed door when tending fire or back-puffing.
Check for:
 - a. Chimney connector pushed too far into a masonry chimney thimble restricting draft.
 - b. Chimney or chimney connector restricted with creosote.
 - c. Chimney draft reduced by air entering through:
 - Unsealed chimney clean-out access.
 - Loose mortar or cracked chimney wall.
 - Holes in rusted chimney connector.
 - Incompletely sealed chimney connector joint or thimble.
 - d. Downdraft in too large chimney or chimney with no top cover.
 - e. Combustion air inlet blocked with ashes.
 - f. Chimney too short.

2. Symptom: Fire rate too high when thermostat closed:
Check for:
 - a. Feed door or ash door not securely closed.
 - b. Feed door or ash door gasket worn excessively.
 - c. Minimum fire shutter setting too large. (See Minimum Fire Adjustment.)
3. Symptom: Smoke smell in living space:
Check for:
 - a. Items a through f of No. 1 above.
 - b. Leaking creosote at pipe joints or flue collar.

FINAL CHECKLIST OF DO'S AND DON'TS

DO'S:

1. Do read and follow the installation, operation and maintenance manual carefully.
2. Do install a smoke detector in an area that will give warning in the unlikely event that a fire develops in the area of the heater or the heater malfunctions.
3. Do be sure that there is a fire extinguisher of the proper type and in good working order accessible in the unlikely event that a fire develops near the heater or the heater malfunctions.
4. Do check with local building officials to be sure the installation of the heater complies with all building codes and requirements and obtain required building permits.
5. Do plan your installation with safety as your primary consideration.
6. Do keep all flammable liquids, gases and pressurized containers away from the heater.
7. Do complete the installation before attempting to use the heater.
8. Do use only the prescribed materials and parts for the installation of the heater.
9. Do install the heater in an area that will minimize the hazards of persons coming in contact with the hot surfaces of the heater.
10. Do instruct all responsible persons in the proper and safe operation of the heater.
11. Do instruct all persons, especially children and elderly persons, of the hazards involved with the heater and improper and unauthorized tampering with the heater.
12. Do check the heater for proper adjustment and operation before leaving it unattended for long periods of time.
13. Do start a fire only with paper, kindling or solid composition fire starters specifically designed for starting a fire. The use of liquid fire starters can cause an explosion within the heater.
14. Do use only a Listed Factory-Built Residential Type and Building Heating Appliance Chimney or a properly constructed and maintained masonry chimney to vent this heater.
15. Do use 6-inch diameter chimney connector pipes made from a minimum of 24 gauge cold rolled steel.
16. Do place all ashes in a metal container with a tight fitting lid and place them on a noncombustible surface well away from other combustible materials until they have completely cooled.
17. Do check the door latching mechanisms and gaskets regularly and replace parts or make adjustments as needed to maintain the intended tightness of the fire chamber.
18. Do use a noncombustible floor covering beneath the heater as required.
19. Do observe all instructions regarding clearance between the appliance, chimney connector and combustibles.
20. Do store your wood or coal supply at least 36 inches from the heater.
21. Do build fires of moderate intensity in the appliance for the first three fires to allow the materials to adjust and cure before being subjected to the intense heat of a large fire.
22. Do burn only wood or coal in the heater. Burning of other types of fuels can be hazardous and damaging to the heater.
23. Do be sure the heater is located in an area where combustible vapors are not present.
24. Do use a chimney for this heater that is not used by another appliance.
25. Do assemble the chimney connector so that moisture that accumulates within the chimney will flow back toward the heater.
26. Do remove the ashes from the heater regularly.
27. Do set the thermostat on "HIGH" and allow the heater to burn for approximately 15 minutes after fresh wood or coal is added before reducing the thermostat setting.
28. Do store wood in such a manner as to keep it dry and coal in such a manner that wet and dry coal will not mix.
29. Do burn only dry, seasoned wood.
30. Do protect your hands with noncombustible gloves when loading the heater, removing ashes, etc.
31. Do keep the heater doors closed except when refueling the heater or removing ashes.

DON'TS:

1. Don't dry clothing or other articles on or near the heater.
2. Don't store or place flammable liquids, gases or pressurized containers near the heater.
3. Don't use gasoline, kerosene, engine oil, charcoal lighter or other flammable liquids to start or intensify a fire. Using these and other similar materials can cause an explosion within the heater.
4. Don't use an unlisted, type B, or poorly constructed or maintained chimney to vent this heater.
5. Don't use galvanized pipe, steel pipe less than 24 gauge, or pipe of a diameter smaller than 6 inches as a chimney connector.
6. Don't store ashes in combustible containers, store them near combustible materials or dispose of them until they have completely cooled.

7. Don't use power blowers or air circulation systems with this heater that are not specifically recommended in the manual.
8. Don't neglect to inspect regularly and maintain door gaskets and latching mechanisms to assure the intended tightness of the fire chamber.
9. Don't install the heater or chimney connector at clearances to combustibles less than those recommended in this manual.
10. Don't install the heater where flammable or explosive liquids or vapors are likely to be present.
11. Don't install this heater in a chimney flue that is used by another appliance.
12. Don't neglect to clean and inspect your chimney regularly.
13. Don't operate the heater with the doors open.

Mountain View Hearth Products
manuals.stove-parts-unlimited.com

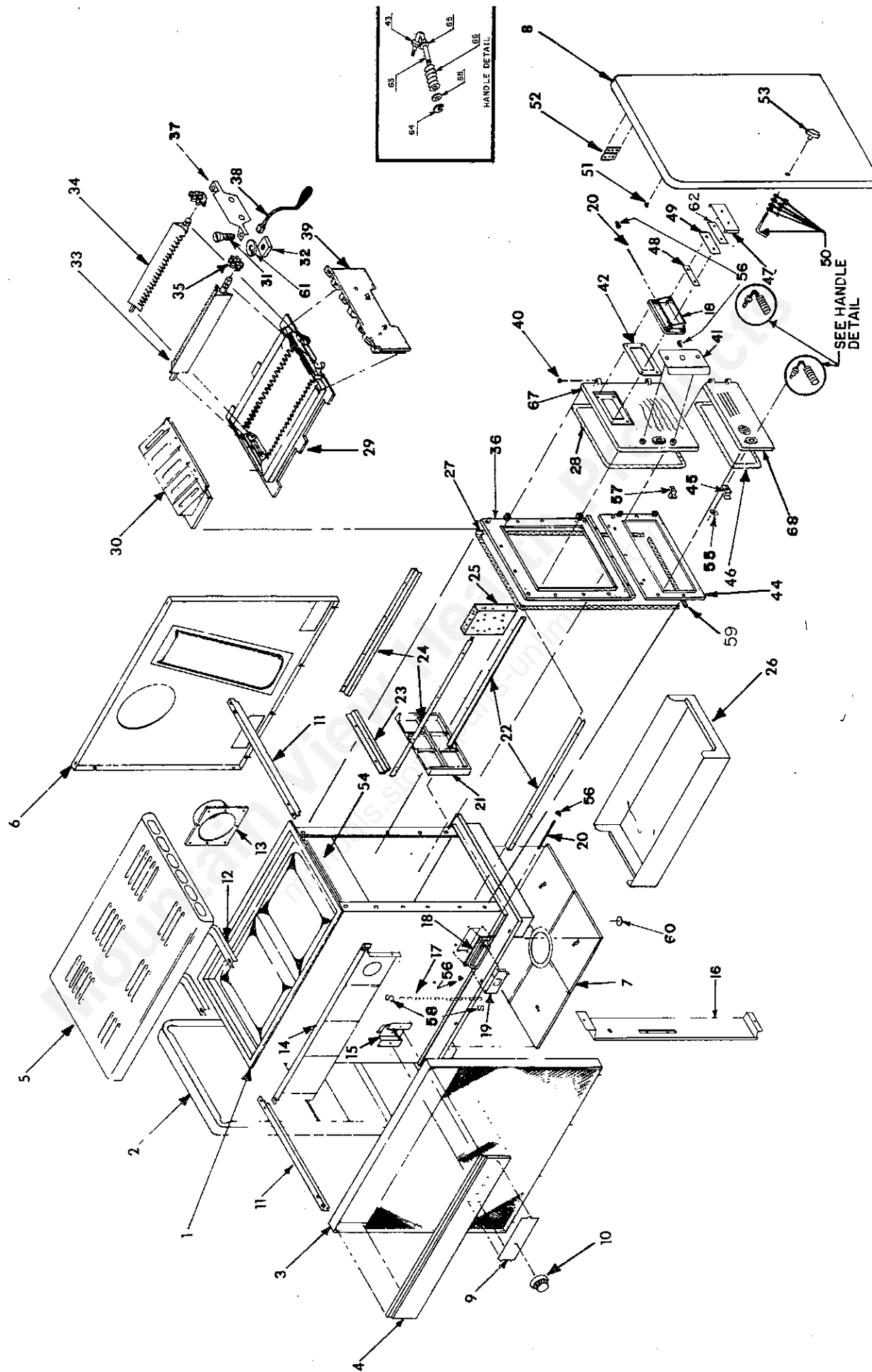

KEY NO.	PART NAME	PART NO.
1	Chamber Assy.(Includes base and chamber shell only)	009059
2	End Cabinet Painted Assy.	009047
3	Screen Frame Painted Assy.	009066
4	Panel Trim	008338
5	* Top, Cabinet Assy.*	004094
6	* Back, Casing Painted Assy.*	009051
7	Shield Base Assy.	009005
8	Door Casing Enameled Assy.	014761
9	Plate, Logo	006474
10	Knob	004798
11	Bar, Right Casing Tie Painted	004090
12	Brace, Top (2 per unit)	C15301
13	Flue Collar 35 AL Drilled	010822
14	Shield, Radiation Painted Assy.	008236
15	Thermostat Assy.	009006
16	Panel, Thermostat Cover	009686
17	Chain	013911
18	Manifold Painted Assy.	006401
19	Plate Assy., Draft	010327
20	Pin, Draft Control	009027
21	Liner, Back	009669
22	Angle, Grate Support Assy.	000851
23	Retainer, Rear	006075
24	Side Brick Retainer	006076
25	Brick (10 per unit)	004911
26	Pan Ash Welded	006237
27	Rope	009448-01
28	Rope	009535-01
29	Frame, Grate	007591
30	Extension, Grate	006251
31	Screw, 1/4-20 x 3/4	*
32	Nut, 1/4-20	*
33	Grate, Left	007717
34	Grate, Right	007716
35	COG, Grate	007714
36	Feed Door Frame	016097
37	Retainer Cog	007715
38	Shaker	005256
39	Liner Front	006307
40	Door Pin(For feed door & ash door)	P626
41	Shield, Handle Radiation	008804
42	Gasket Manifold	006145
43	Washer .471 I.D. x 23/32 O.D. x .125	015812
44	Ash Door Frame	016093
45	Latch	014711
46	Rope	009535-02
47	Relief Plate Painted Assy.	006257
48	Plate, Spacer	006285
49	Gasket, Relief Plate	006124
50	Cabinet Door Catch Assy.	009917
51	Rubber Bumper	P6108
52	Hinge, Painted	009054
53	Cabinet Door Handle & Screw Assy.	011335
54	Smoke Curtain Painted	009102
55	Shim	014756
56	Acorn Nut	009028
57	Latch for Feed Door	014713
58	"S" Hook (2 per unit)	011641
59	Rope Gasket (For Bottom of Ash Frame)	009535-06
60	Leveler (4 per unit)	009041
61	Washer 1/4 Split Lock Plain	*
62	Spacer Plate	006285
63	Handle Shaft	014507
64	Ring 1/2" Basic External Retainer	015904
65	Washer .506 I.D. x 23/32 O.D. x .063	015815
66	Handle Knob	015402
67	Feed Door & Rope Assy.	016105
68	Ash Door & Rope Assy.	016082
69	Handle Assy. (Items 63-66)	015905

**ORDER REPAIR PARTS FROM
YOUR KING DEALER BY
SUPPLYING THE FOLLOWING
INFORMATION**

1. PART NAME
2. PART NUMBER (Not Key No.)
3. MODEL NUMBER

* Purchase Locally

LIMITED WARRANTY

KING WOOD OR COAL BURNING HEATERS, ACCESSORY BLOWERS, OR FURNACES

Manufactured by: Martin Industries, Inc. Post Office Box 128, Florence, Alabama 35631

WHAT IS COVERED AND FOR HOW LONG

For one year from the date this heater, accessory blower, or furnace is first purchased for use, Martin Industries, Inc. will make available to you at our factory a free replacement for any defective part of this heater, accessory blower, or furnace.

WHAT IS NOT COVERED

- Removal and re-installation costs.
- Labor costs for replacement or repairs.
- Transportation or shipping cost.
- The cost of a service call to diagnose trouble.
- Painted surfaces.
- Damage or defect caused by improper installation, accident, misuse, abuse, or alteration.

LIMITATIONS AND EXCLUSIONS

1. No one has authority to add to or vary this limited warranty, or to create for Martin Industries, Inc. any other obligation or liability in connection with this heater, accessory blower, or furnace.
2. ANY IMPLIED WARRANTY APPLICABLE TO THIS HEATER, ACCESSORY BLOWER OR FURNACE IS LIMITED IN DURATION TO THE SAME PERIOD OF TIME AS THIS WRITTEN WARRANTY. Some states do not allow limitations on how long an implied warranty lasts, so the above limitations may not apply to you.
3. MARTIN INDUSTRIES, INC. SHALL NOT BE LIABLE FOR INCIDENTAL, CONSEQUENTIAL, SPECIAL, OR CONTINGENT DAMAGES YOU MIGHT SUFFER AS A RESULT OF ITS BREACH OF THIS WRITTEN WARRANTY OR ANY IMPLIED WARRANTY. Some states do not allow the exclusion or limitation of incidental or consequential damages, so the above limitation or exclusion may not apply to you.
4. This warranty applies only to the original purchaser and may not be transferred.
5. This warranty applies only to a heater sold and used in the United States.

YOUR DUTIES

- This heater, accessory blower, or furnace must be installed and operated in accordance with local codes and the instructions furnished with it.
- You should keep an invoice, cancelled check, or payment record to verify the purchase date.

IF YOU HAVE A PROBLEM WITH YOUR HEATER, ACCESSORY BLOWER, OR FURNACE

1. Contact or take it to the nearest King dealer. If you cannot locate your King dealer, call or write Martin Industries Customer Service Department as indicated below.
2. If you do not receive satisfactory service from the dealer within a reasonable time, write Martin Industries, Inc. Customer Service Department and include the date you purchased your heater, accessory blower, or furnace its serial number, and details of the problem you are having.

Customer Service Department
Martin Industries, Inc.
Post Office Box 128
Florence, Alabama 35631
Telephone: 205-767-0330

This warranty gives you specific legal rights, and you may also have other rights which vary from state to state.

