

**UNITED STATES STOVE COMPANY**  
**MODEL 2000**  
**EPA DOCUMENTATION**

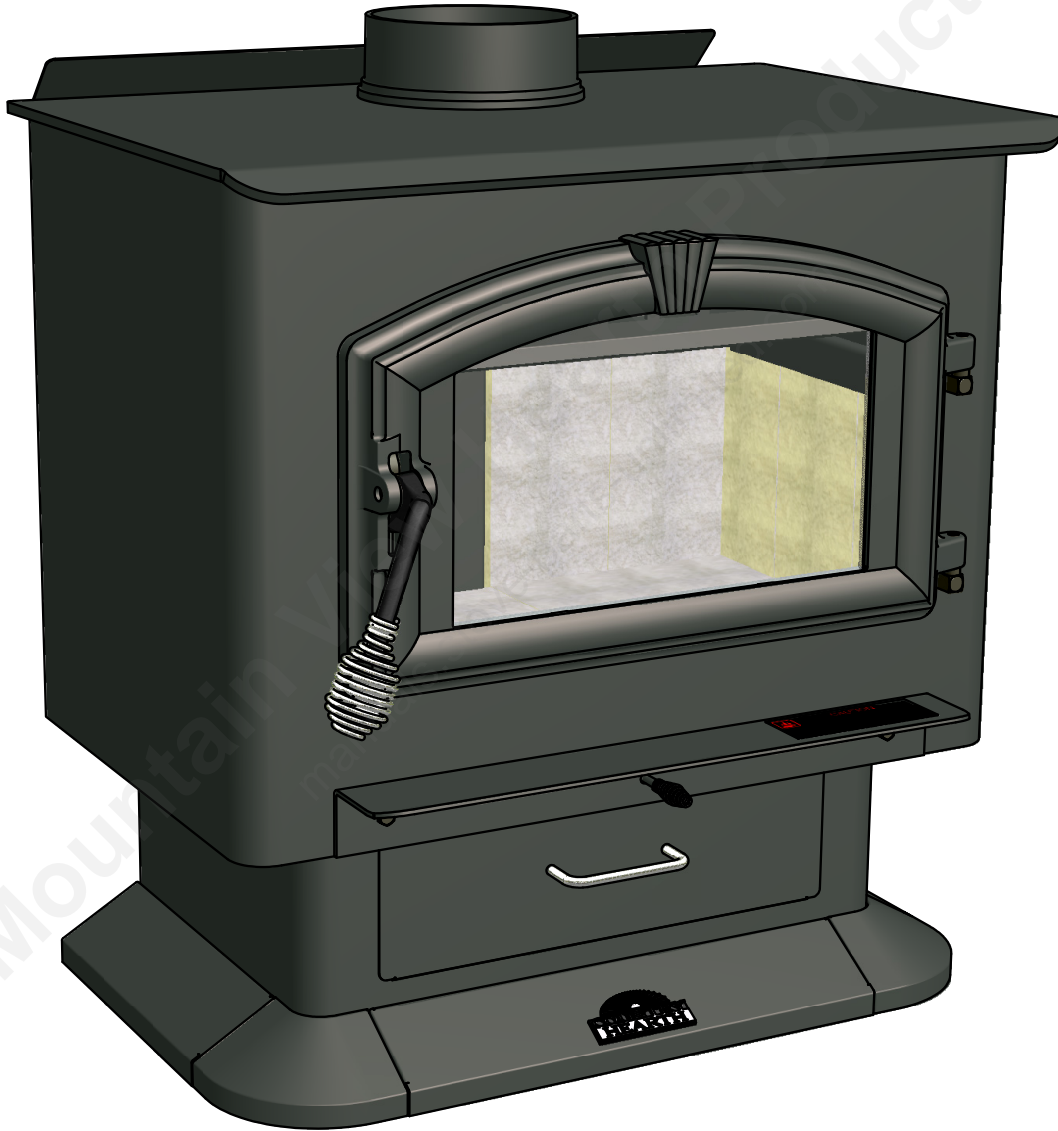

MARCH 3, 2010

## **EPA “K” List Requirements**

1. Firebox dimensions: We need the dimensions of the firebox detailed enough to determine firebox volume.
2. Air introduction systems: We need cross sectional area from inlet and outlet of all air introductions systems. We also need an air flow diagram using arrows showing airflow introduction to exit. *Example: start-up air, primary air, secondary air, air wash for glass.*
3. Baffle dimensions and locations.
4. Refractory insulation dimensions and locations: *Example: firebrick and baffle material.* We also need material specifications on these items. *(data sheet from manufacturer is preferred)*
5. Flue gas exit. Dimensions and exit location. This would include dimensions above the baffle to and including the flue collar.
6. All gasketing material. This would include dimensions and material specs. of all gasketing and a clear indication of its location on the appliance. *(material specs from the manufacturer would be helpful.)* We also need the specifications, size and thickness of the door glass.
7. Outer shielding and locations. Drawings should include shielding and locations and overall dimensions.
8. *(Pellet Stoves)* Auger motor rating, design and power rating. Show a drawing of the angle of the auger to the firebox.
9. *(Pellet Stoves)* Forced air combustion systems. Motor specs of the combustion systems and blade size.
10. Fan Option appliances: CFM of optional fan *(send manufacturer data sheet)*

**This above information is being supplied to the EPA as documenting the tested unit. Any insulation, refractory, or door and catalyst bypass gaskets and the items listed above must not be changed unless approved by the EPA in writing. The EPA presumes any changes can change emissions and therefore changing these items could require re-testing.**

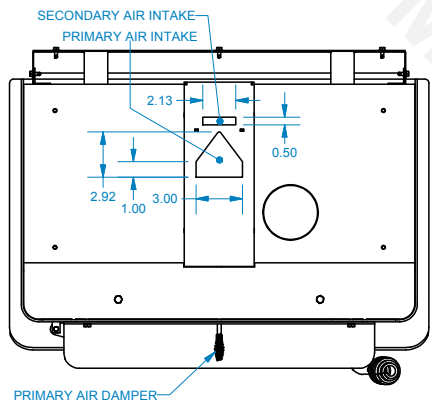

BOTTOM VIEW (shown w/o pedestal)  
COMBUSTION AIR INTAKE LOCATION

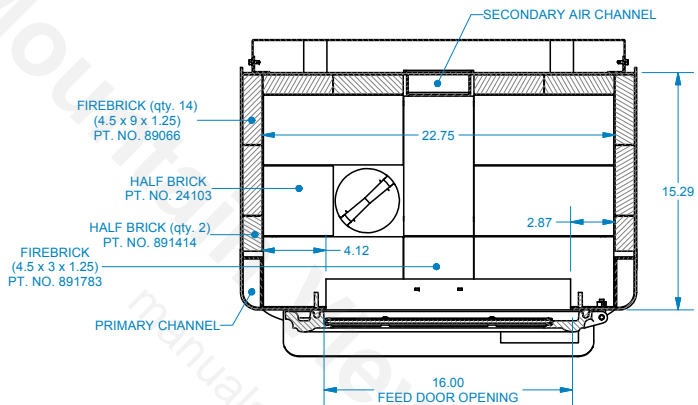

SECTION B-B

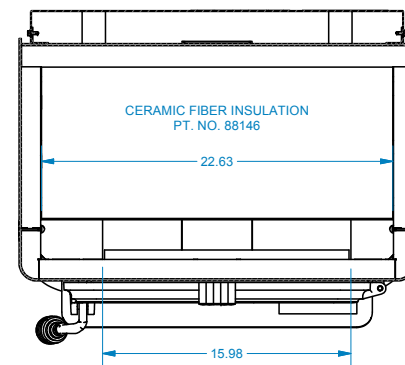

SECTION C-C

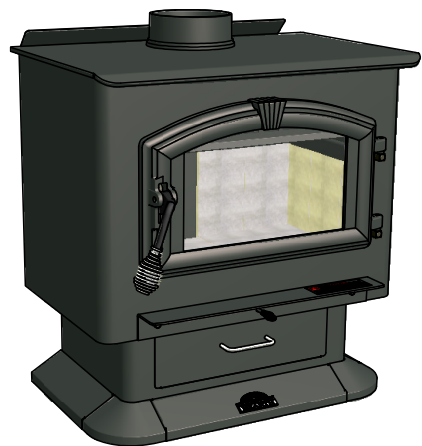

UNITED STATES STOVE COMPANY  
MODEL 2000  
EPA K-LIST

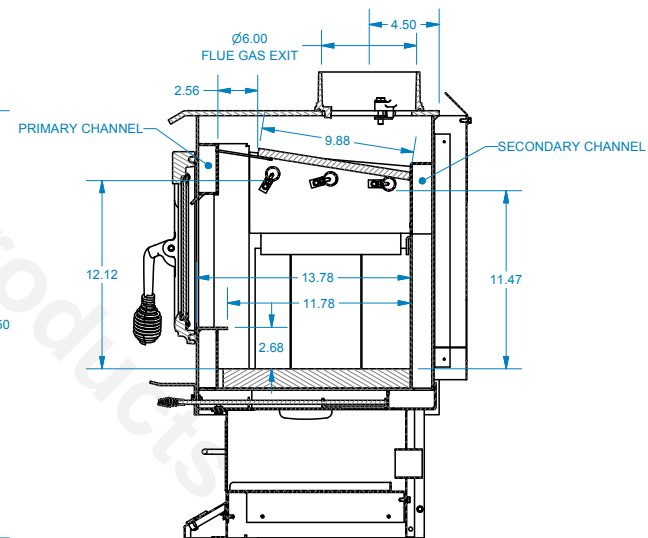
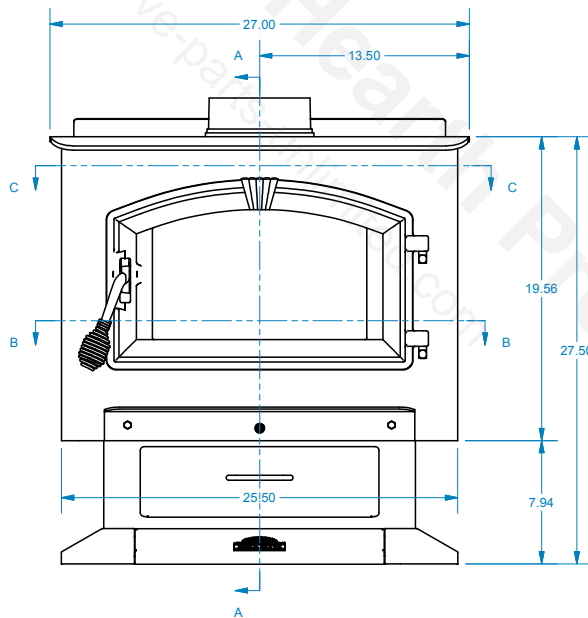

SECTION A-A

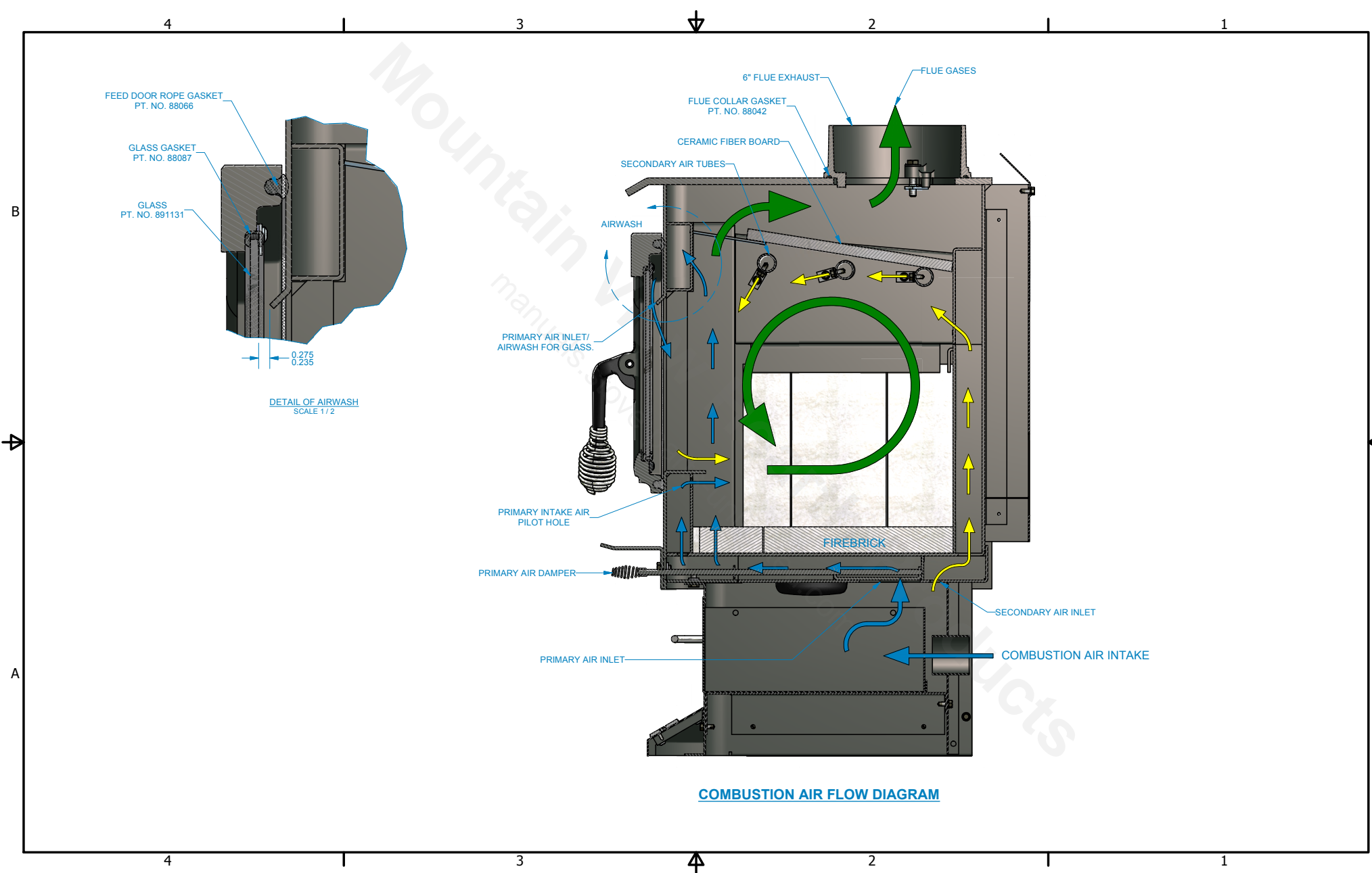

FEED DOOR ROPE GASKET  
PT. NO. 88066

GLASS GASKET  
PT. NO. 88087

GLASS  
PT. NO. 891131

0.275  
0.235

DETAIL OF AIRWASH  
SCALE 1/2

6" FLUE EXHAUST

FLUE GASES

FLUE COLLAR GASKET  
PT. NO. 88042

CERAMIC FIBER BOARD

SECONDARY AIR TUBES

AIRWASH

PRIMARY AIR INLET/  
AIRWASH FOR GLASS.

PRIMARY INTAKE AIR  
PILOT HOLE

PRIMARY AIR DAMPER

PRIMARY AIR INLET

FIREBRICK

SECONDARY AIR INLET

COMBUSTION AIR INTAKE

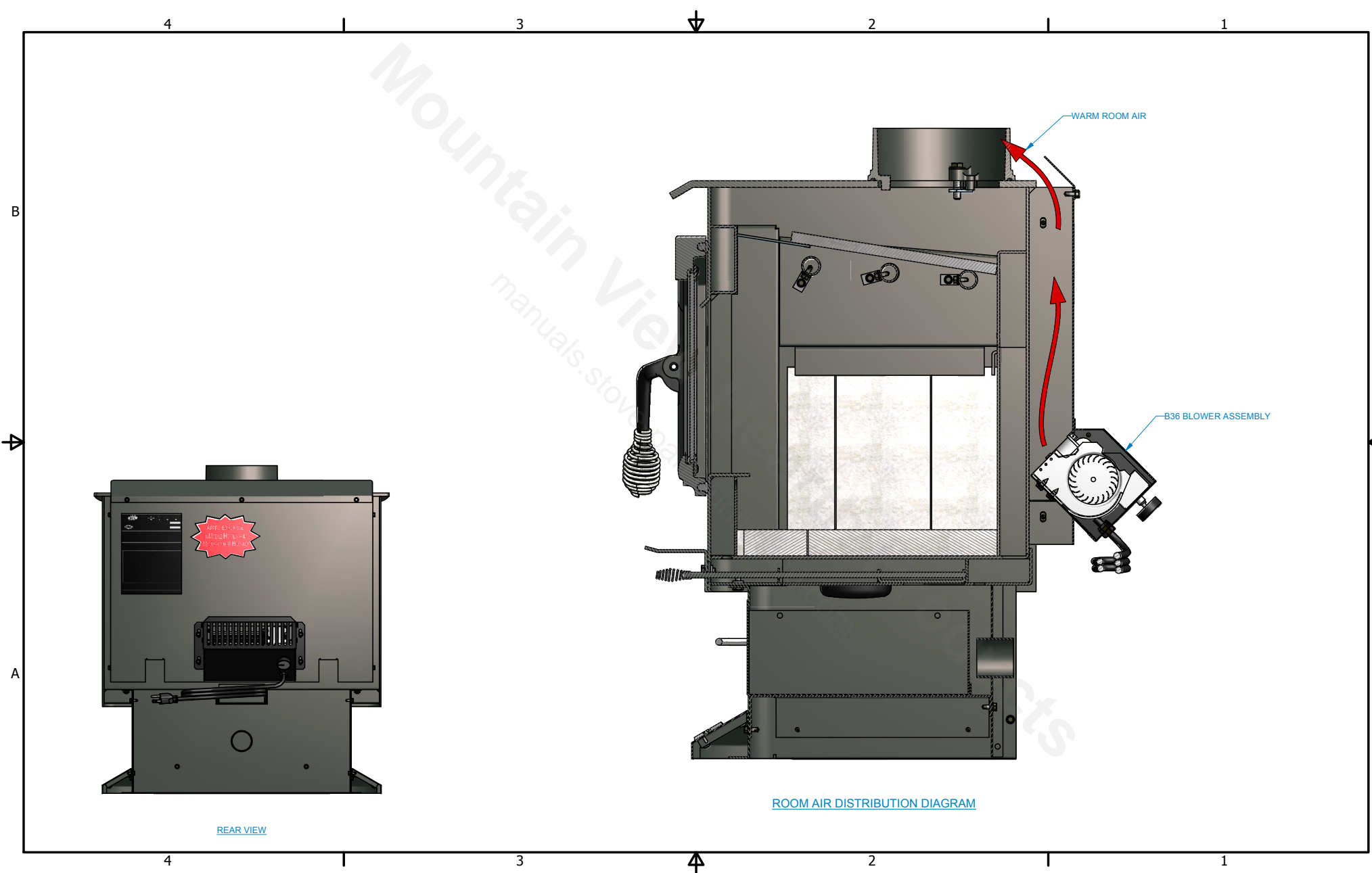

REAR VIEW

ROOM AIR DISTRIBUTION DIAGRAM

REVISION HISTORY			
REV	DESCRIPTION	DATE	BY
A	INITIAL RELEASE	3/3/2010	CDB

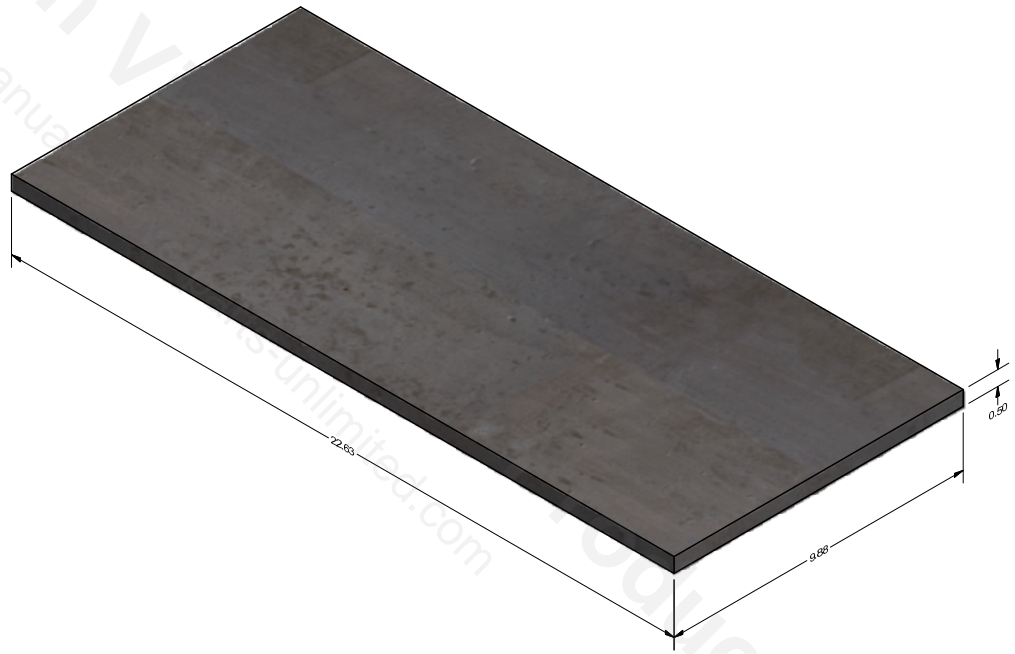

**SPEC. CONTROL**

**Material:** Gemcolite® FG23-102  
 C-Cast Aluminosilicate Ceramic Fiber  
 with organic binder  
**Color before firing:** Gray/Off-White  
**Color after firing:** White  
**Density:** 36 PCF after rigidizing  
**Temperature Rating:** 2300°F (1260°C)

**SOURCE OF MANUFACTURER**

**Refractory Specialties Inc.**  
 230 West California Ave.  
 Sebring, OH 44672  
**Phone:** (330) 938-2101  
**Contact:** Ken Diver (Plant Engineer)

TOLERANCES EXCEPT AS NOTED	HOLES ± .005"	DESCRIPTION GEMCOLITE (SEE NOTE)	SCALE 1:3	SIZE B	REV A	UNITED STATES STOVE COMPANY ESTABLISHED 1869	NUMBER 88146	SHEET 1 OF 1
	DECIMAL XX ± 0.03 XXX ± 0.010		BLANK NUMBER					
	ANGULAR ± 2°	REFERENCE 2000	DATE 3/3/2010	TITLE BOARD, CERAMIC FIBER				

Mountain View  
 manuals.stove-parts-unlimited.com  
 Products

REVISION HISTORY			
REV	DESCRIPTION	DATE	BY
A	INITIAL RELEASE	5/9/2008	CDB

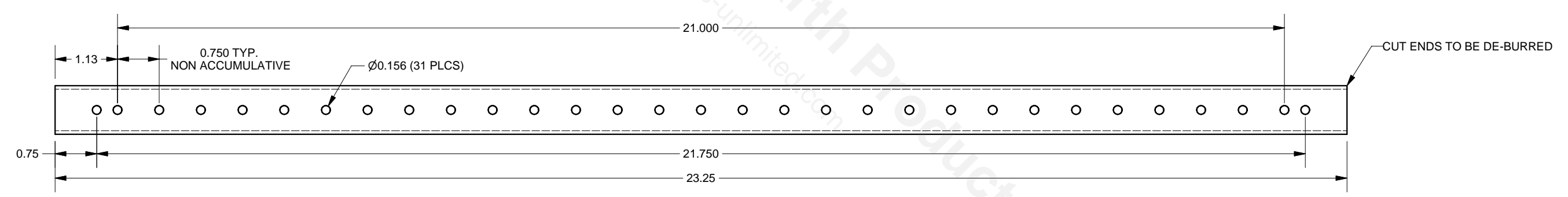
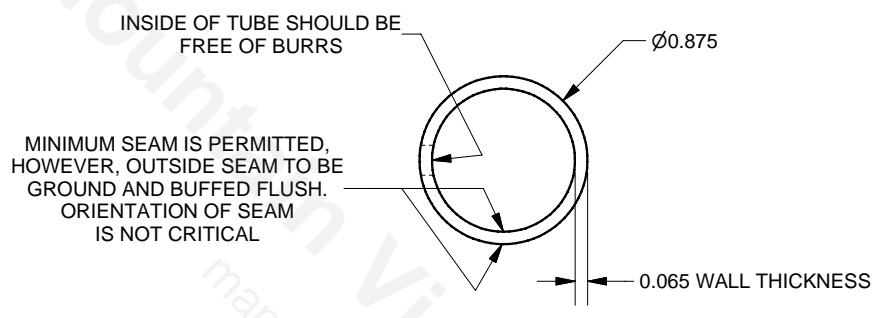

TOLERANCES EXCEPT AS NOTED	HOLES $\pm .005"$	DESCRIPTION .875" x .065 TP 304/304L SS	SCALE 1:2	SIZE B	REV A	UNITED STATES STOVE COMPANY ESTABLISHED 1869		
	DECIMAL .XX = 0.03 XXX = 0.010	BLANK NUMBER	DWN BY CDB	TITLE TUBE, SECONDARY AIR	NUMBER 86643			
	ANGULAR $\pm 2^\circ$	REFERENCE 2500	DATE 4/16/2008					

REVISION HISTORY			
REV	DESCRIPTION	DATE	BY
A	INITIAL RELEASE	5/9/2008	CDB

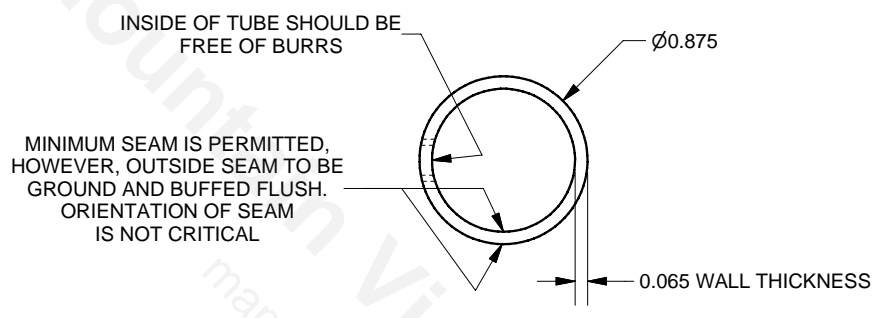

TUBE END PROFILE  
SCALE 1:1

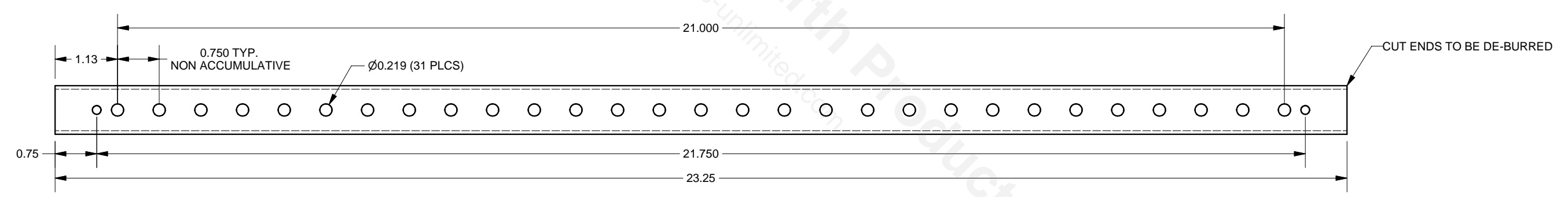

TOLERANCES EXCEPT AS NOTED	HOLES ± .005"	DESCRIPTION .875" x .065 TP 304/304L SS	SCALE 1:2	SIZE B	REV A	UNITED STATES STOVE COMPANY ESTABLISHED 1869	NUMBER 86645	SHEET 1 OF 1
	DECIMAL .XX = 0.03 XXX = 0.010		DWN BY CDB	TITLE TUBE, SECONDARY AIR				
	ANGULAR ± 2°	BLANK NUMBER	DATE 4/16/2008					
		REFERENCE 2500						

REV	ECN	DESCRIPTION	DATE	BY
		RELEASED		
A		(1) 1 1/4 WAS 1 3/16 (2) 4 1/2 WAS 4 3/8	10-10-78	EG
B		ADDED TOLERANCES	10-16-80	CRT
C	81-339	ADDED NOTE	8-22-81	AMOS
D	82-609	ADDED (1)	8-10-82	AMOS
E	83-956	ADDED #3 SOURCE	9-23-83	MDK
F		ADDED NOTES, CHANGED SOURCE.	5-13-94	WA

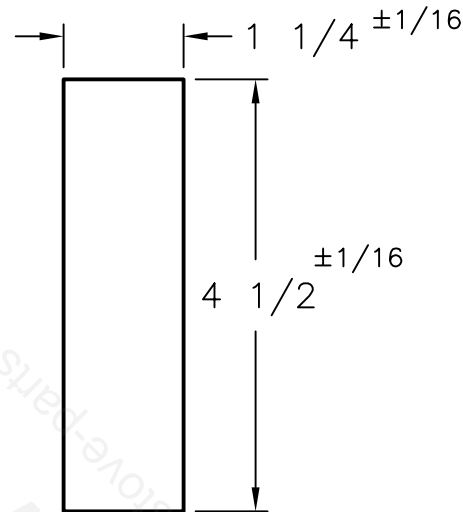
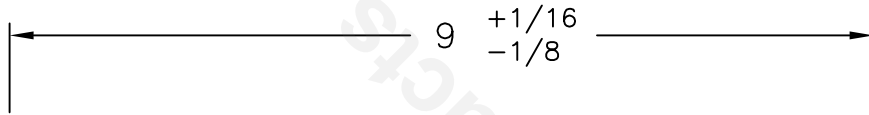

METHOD OF MANUFACTURE - VACUUM DRY PRESS

TYPICAL CHEMICAL ANALYSIS	
SiO <sub>2</sub>	66.9%
Al <sub>2</sub> O <sub>3</sub>	25.6%
Fe <sub>2</sub> O <sub>3</sub>	2.5%
CaO	.2%
MgO	.7%
TiO <sub>2</sub>	1.5%
Alkali	2.6%

TYPICAL PHYSICAL PROPERTIES	
P.C.E.	20-26
Apparent Porosity	13-17%
Modulus of Rupture	700-1200
Temperature fired to during manufacture=2100 F (1149 C)	
Manufactured to meet ASTM C-27 Low Duty	
Recommended Maximum Operating Temperature = 2000 F	

**FINAL PRINT-DESTROY  
ALL PREVIOUS PRINTS  
5-18-94**

SOURCE  
WHITACRE-GREER  
1400 SOUTH MAHONING AVENUE  
ALLIANCE, OHIO 44601  
(216)823-1610

TOLERANCES	HOLES + -	MATERIAL	NOTED	SCALE	1/2	SIZE	C	REV	F	UNITED STATES STOVE COMPANY	
EXCEPT	FRACTIONAL +	FINISH	N/A	DWN BY		WVA				ESTABLISHED 1869	NUMBER
AS	ANGULAR + -	REFERENCE	WOOD CIRCULATOR	DATE	5-1-92		FIREBRICK				89066
NOTED											

Mountain View Hearth Products | manuals.stove-parts-unlimited.com

REVISION HISTORY			
REV	DESCRIPTION	DATE	BY
A	INITIAL RELEASE	8/10/2006	CDB

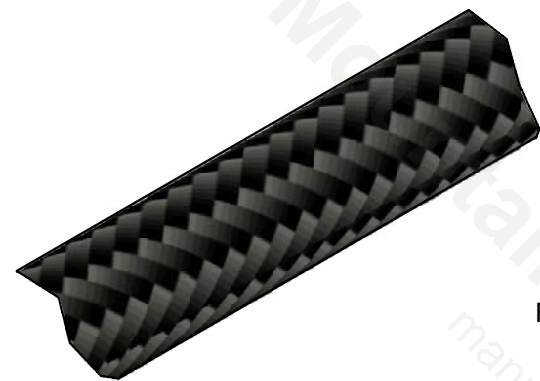

**MATERIAL NOTE:**  
 1/4" DIA., MEDIUM DENSITY,  
 FIBERGLASS ROPE GASKET w/GRAPHITE  
 TEMP. RATING: 1,000°F (538°C)  
 WIDTH/YIELD TOLERANCE: ±5%

FIL-TEC DESC.: MD .250 G

DETAIL A-1  
 SCALE 3:1

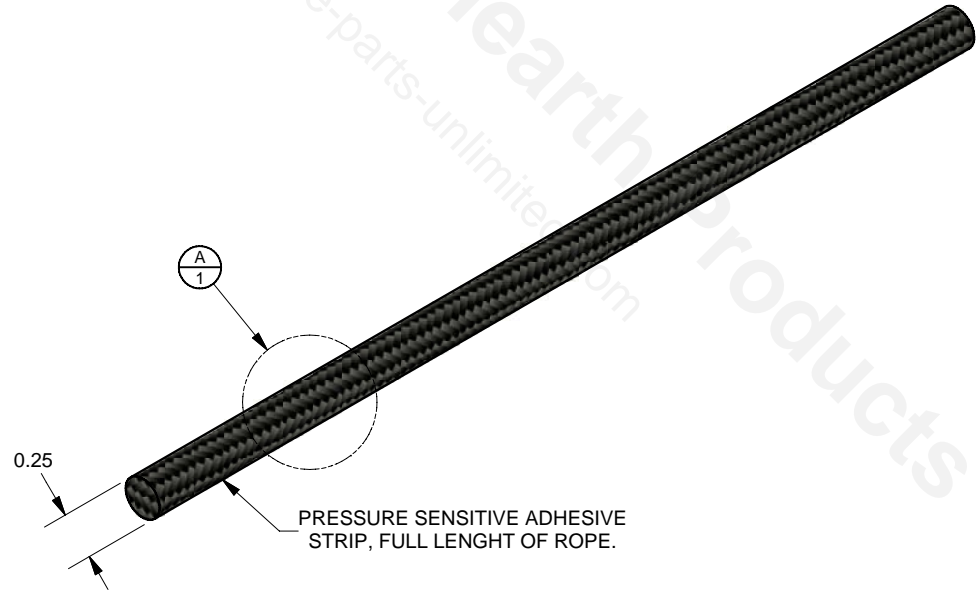

PRESSURE SENSITIVE ADHESIVE STRIP, FULL LENGTH OF ROPE.

**SOURCE OF SUPPLY**  
 FIL-TEC, INC  
 P.O. BOX B  
 HAGERSTOWN, MD 21741-1191  
 PHONE: (301) 824-6166  
 FAX: (301) 824-6938

CONTACT: CHIP ROCKWELL

**SPEC/SOURCE CONTROL**

TOLERANCES EXCEPT AS NOTED	HOLES + .005" - .001"	DESCRIPTION SEE NOTE	SCALE 1:1	SIZE B	REV A	<b>UNITED STATES STOVE COMPANY</b> ESTABLISHED 1869		
	DECIMAL .XX = 0.03 XXX = 0.010	BLANK NUMBER	DWN BY CDB	TITLE 1/4" ROPE GASKET		NUMBER 88042	SHEET 1 OF 1	
	ANGULAR ± 2°	REFERENCE	DATE 8/10/2006					

REVISION HISTORY			
REV	DESCRIPTION	DATE	BY
A	INITIAL RELEASE	5/24/2006	REC

**SOURCE OF SUPPLY :** FIL-TEC INCORPORATED  
 P.O. BOX 126  
 HAGERSTOWN, MD 21741-0126  
 CONTACT: MARTHA UNGER  
 PH: (301) 824-6166  
 FAX: (301) 824-6938  
 E-MAIL: munger@fil-tec.com

**SPECIFICATIONS:** 5/8" DIAMETER FIBERGLASS W/GRAPHITE COATING.  
 LOW DENSITY, TYPE 2 ROPE.  
 RATED TO 1000° F.  
 NON-ASBESTOS.  
 pH RANGE OF 4-9.  
 NON-ABSORBING.  
 FIL-TEC PART NUMBER IS **LD2 .625 G.**

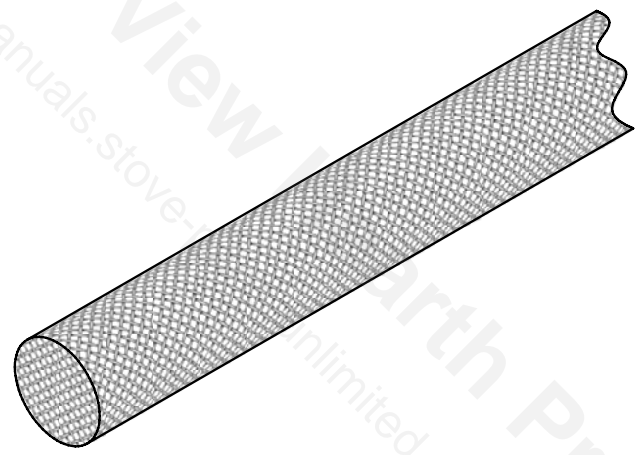

Mountain View Hearth Products  
 manuals.stove-parts-unlimited.com

**SOURCE/SPEC CONTROL**

TOLERANCES EXCEPT AS NOTED	HOLES + .005" - .001"	DESCRIPTION SEE NOTE	SCALE 1:1	SIZE B	REV A	<b>UNITED STATES STOVE COMPANY</b> ESTABLISHED 1869	
	DECIMAL .XX = 0.03 XXX = 0.010	BLANK NUMBER	DWN BY REC	TITLE GASKET, 5/8 ROPE (LD2 .625 G)		NUMBER 88066	SHEET 1 OF 1
	ANGULAR ± 2°	REFERENCE VARIES	DATE 5/24/2006				

REVISION HISTORY			
REV	DESCRIPTION	DATE	BY
A	Added Note 2. Physical Properties.	9/8/2005	RAH
B	Same Pt. No. New Part. Redrawn Per New Part.	9/8/2005	RAH

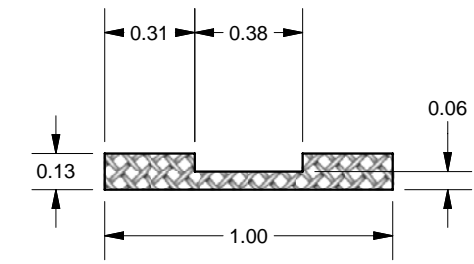
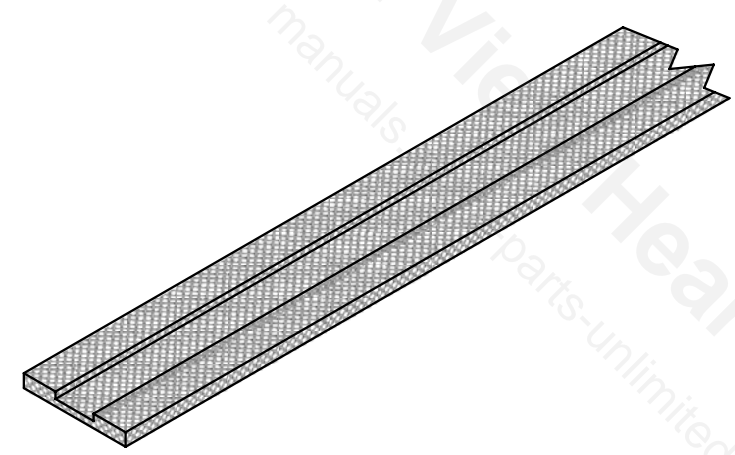

SCALE 1.50 : 1

**Material / REF.:**  
 1/8 X 1 Fiberglass Window Gasket w / Adhesive.  
 2U Window Channel w / 3U Channel In Graphite  
 (Black) w / PSA (Pressure Sensitive Adhesive).  
 Base Material - E - Glass Fiberglass Yarn.  
 Tight Weave.  
 Temperature Rating: Good To 1000° F Constant.

**SOURCE OF SUPPLY:** SPECIALTY GASKETS INC.  
 6400 SHAWSON DRIVE, UNIT 1  
 MISSISSAUGA, ONT, L5T 1L8.

TEL: (905) 564-0807  
 FAX: (905) 564-4812

CONTACT: JUDY McVEIGH

**SPEC/SOURCE CONTROL**

TOLERANCES EXCEPT AS NOTED	HOLES + .005" - .001"	DESCRIPTION Noted In Material Note.	SCALE 3:4	SIZE B	REV B	UNITED STATES STOVE COMPANY ESTABLISHED 1869		
	DECIMAL .XX = 0.03 XXX = 0.010	BLANK NUMBER	DWN BY RAH	TITLE 1/8 X 1 WINDOW GASKET W/ADHESIVE		NUMBER 88087	SHEET 1 OF 1	
	ANGULAR ± 2°	REFERENCE MULTIPLE UNITS	DATE 9/8/2005					

REVISION HISTORY			
REV	DESCRIPTION	DATE	BY
A	INITIAL RELEASE	12/16/04	CDB
B	MADE "SAND ETCHED" THE PRIMARY APPLICATION FOR LOGO.	12/7/2005	CDB
C	REMOVED "AMERICAN HARVEST" LOGO	5/31/2006	REC

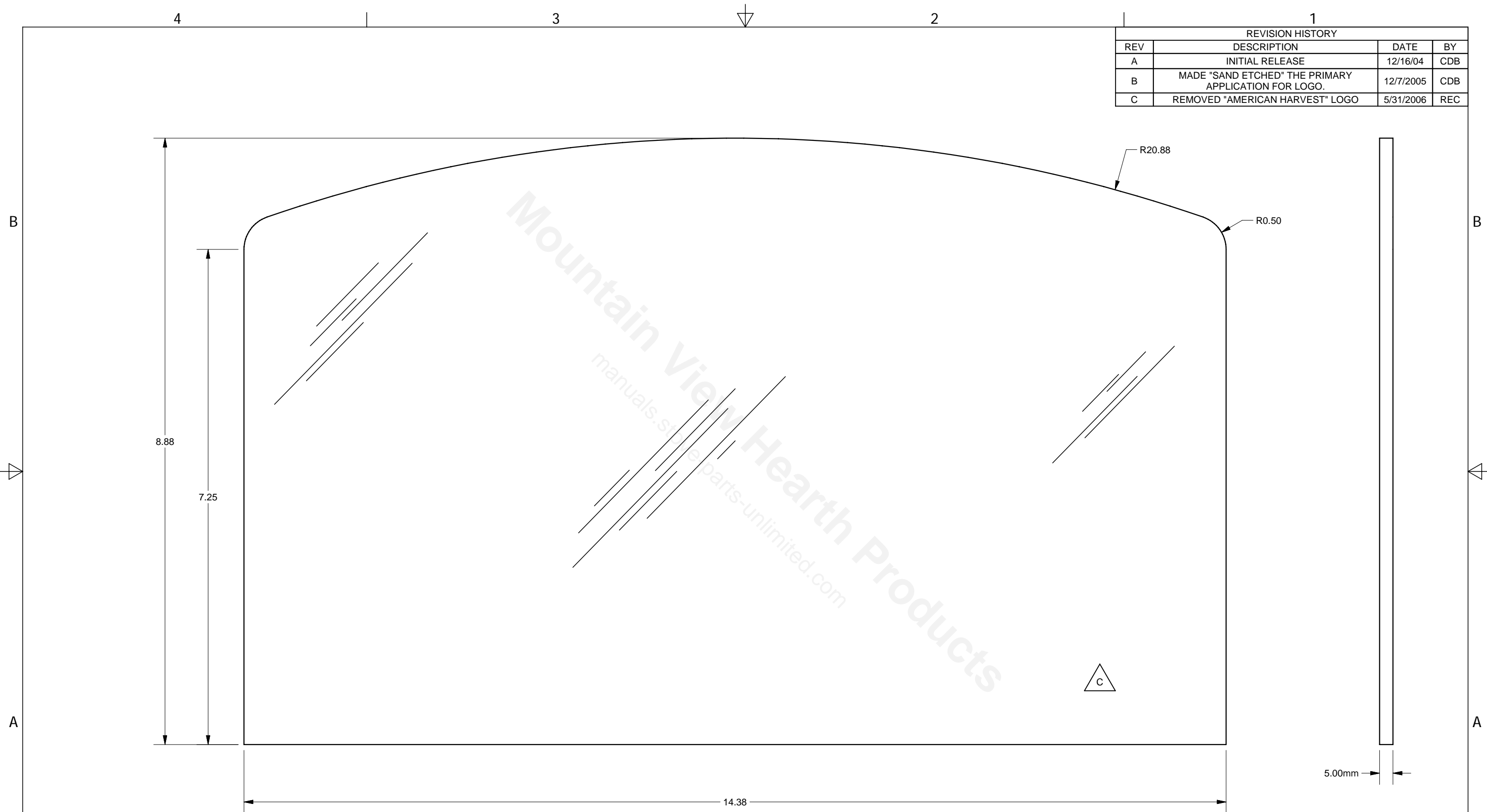

FRONT VIEW

TOLERANCES EXCEPT AS NOTED	HOLES + .005" - .001"	DESCRIPTION <b>TRANSPARENT CERAMIC GLASS</b> 1400° SERVICE TEMP.	SCALE 3:4	SIZE B	REV C	<b>UNITED STATES STOVE COMPANY</b> ESTABLISHED 1869		
	DECIMAL .XX = 0.03 XXX = 0.010		BLANK NUMBER	DWN BY CDB	TITLE CERAMIC GLASS		NUMBER 891131	SHEET 1 OF 1
	ANGULAR ± 2°		REFERENCE 6039	DATE 12/16/2004				

PARTS LIST			
ITEM	PART NO	TITLE	QTY
1	25089	BLOWER HOUSING BACK	1
2	25090	BLOWER HOUSING FRONT	1
3	80442	80 CFM BLOWER	1
4	80090	RHEOSTAT W/KNOB	1
5	80109	STRAIN RELIEF	1
6	80232	SUPPLY CORD	1
7	83172	#10AX1/2 HX W SM SCR BL OX 99723	8

REVISION HISTORY			
REV	DESCRIPTION	DATE	BY
A	INITIAL RELEASE	8/11/2006	CDB

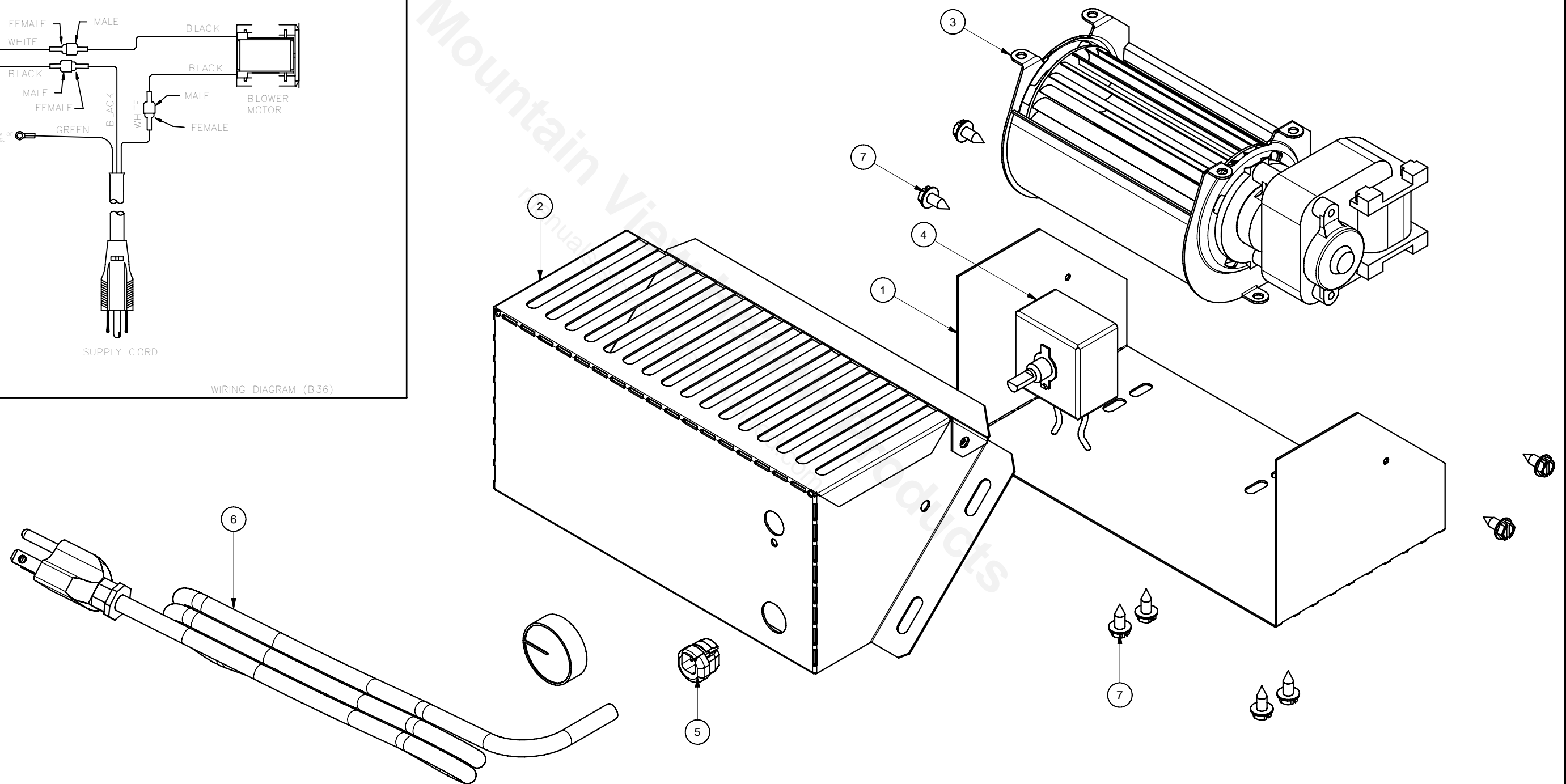
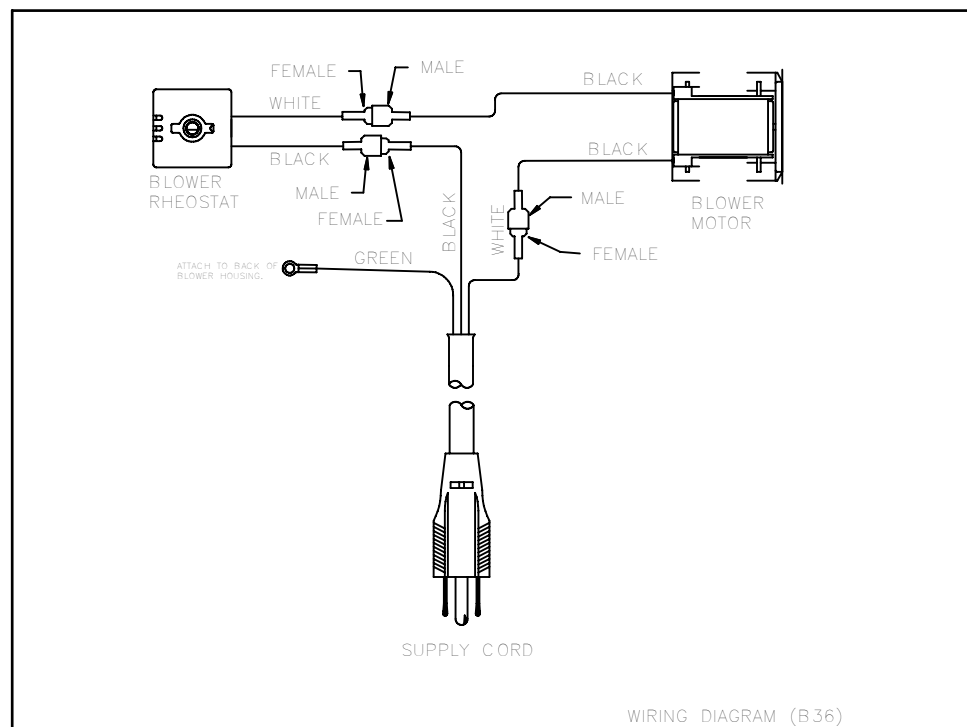

TOLERANCES EXCEPT AS NOTED	HOLES + .005" - .001"	DESCRIPTION ASSEMBLY	SCALE 1:2	SIZE B	REV	UNITED STATES STOVE COMPANY ESTABLISHED 1869	NUMBER B36	SHEET 1 OF 1
	DECIMAL .XX = 0.03 XXX = 0.010	BLANK NUMBER	DWN BY CDB	TITLE B36 BLOWER ASSEMBLY				
	ANGULAR ± 2°	REFERENCE	DATE 8/11/2006					

NOTES:

1. APPLY 6129 4659 TO READ RIGHT WITH EXHAUST IN UNDERSHOT POSITION.
2. PACK 28 PER CONTAINER, 224 MAX. AMT. PER PALLET, PACKING ASSY:  
8785-4912, P.S. 8883-4200 & P.S. 8883-4408.
3. MARK EACH CONTAINER WITH REQUIRED INFORMATION.

APPLICATION	WOOD BURNING									
	B	LA	FR	A	S	C	E	B	A	
	42	58	01	X	17	OF	0	0	2	
CUSTOMER	U. S. STOVE									
CUSTOMER PART NO.	80442									

**LEAD MATERIAL**  
 18 GA. 125° C 2/64 INSUL.  
 X-LINKED POLY. BLACK  
 6.00/4.00 IN. LONG  
 W/TERM. 8903-9148  
 AMP #2-520102-2

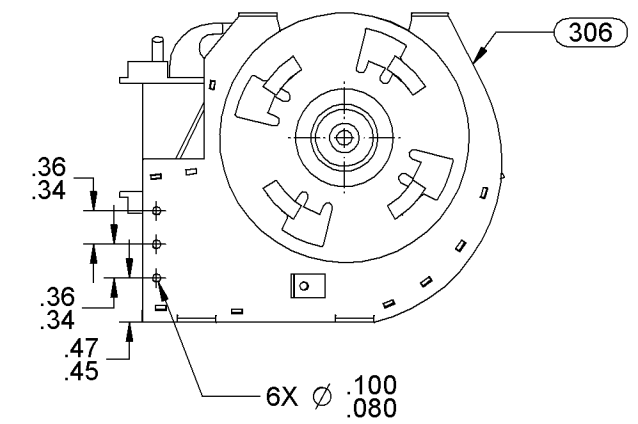
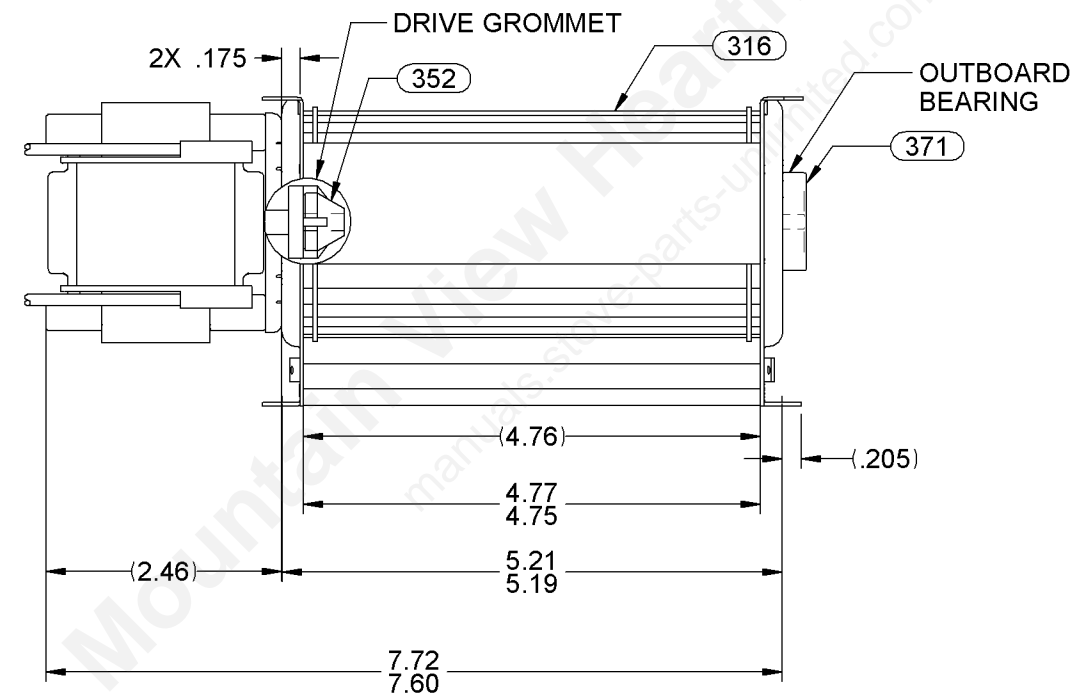
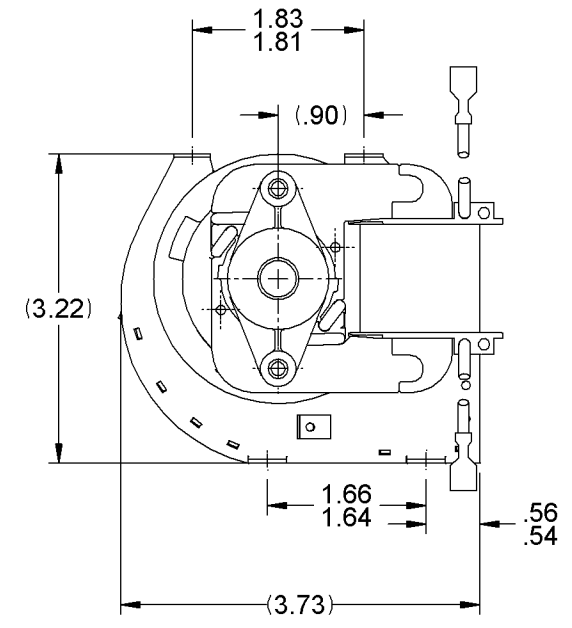
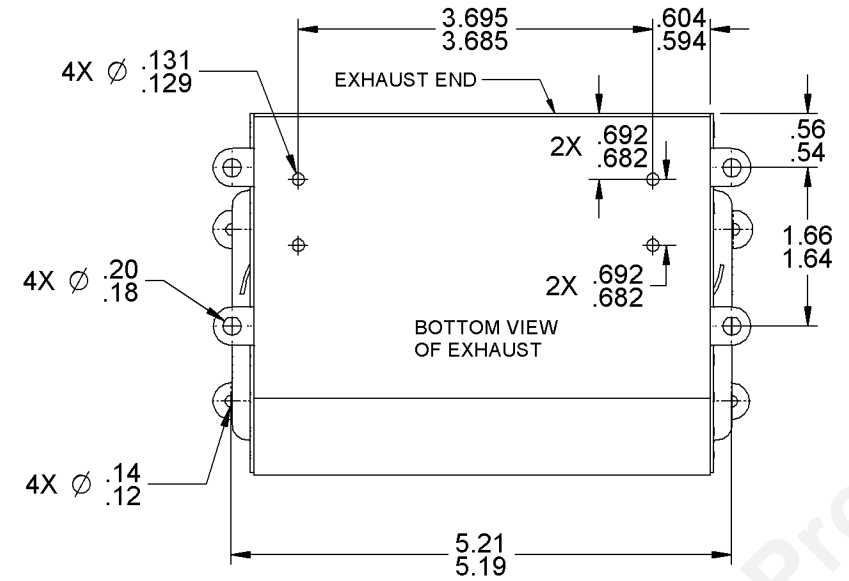

**FASCO®**  
**TRANSFLO**  
**BLOWER**

6129-4659

TYPICAL PERFORMANCE TEST DATA WITH EXHAUST 1/2 BLOCKED			
AT 115 VOLTS 60 HZ.			
	R.P.M.	WATTS	AMPS
	3245	28	.41
BLOWER WEIGHT LBS.			END PLAY .XX/.XX

UNLESS OTHERWISE SPECIFIED DIMENSIONS ARE IN INCHES TOLERANCES ARE: FRACTIONS ± 1/16 DECIMALS .XX ± .01 ANGLES ± 1° XXX ± .005	
APPROVALS	DATE
DRAWN VLL	08-06-2002
CHECKED JMH	08-06-2002
FINISH COLOR	NATURAL

<b>FASCO</b> FASCO MOTORS GROUP AC MOTOR/BLOWER DIVISION	
CONFIDENTIAL: DO NOT DUPLICATE OR DISCLOSE TO THIRD PARTIES WITHOUT WRITTEN PERMISSION OF FASCO MOTORS GROUP, AC MOTOR/BLOWER DIVISION.	
TITLE <b>BLOWER ASSEMBLY</b>	
SIZE <b>B</b>	DWG. NO. 7058 0210
DO NOT SCALE DRAWING	REV. <b>01</b>
SHEET 1 OF 2	

If Printed, this is an Uncontrolled Document.

NOTES:

1. MOTOR MUST START AT 90 VOLTS.
2. ASSEMBLE BEARING SPRING ON BACK OF MOTOR.
3. SHAFT EXTENSION MEASURED WITH ENDPLAY PULLED OUT.

APPLICATION	BLOWER	B	LA	FR	A	S	C	E	B	A
ENVIRONMENT	DRY	00	58	01	X	17	OF	0	0	2

IMPEDANCE PROTECTED  
CLASS "B" INSULATION  
SEALED BALL BEARING

CUSTOMER U.S. STOVE

CUSTOMER PART NO. 80442

LEAD MATERIAL  
18 GA. 125° 2/64 INSUL.  
X-LINKED POLY. BLACK  
6.00/4.00 IN. LONG  
W/TERM. 8903-9148  
AMP #2-520102-2

FRONT END

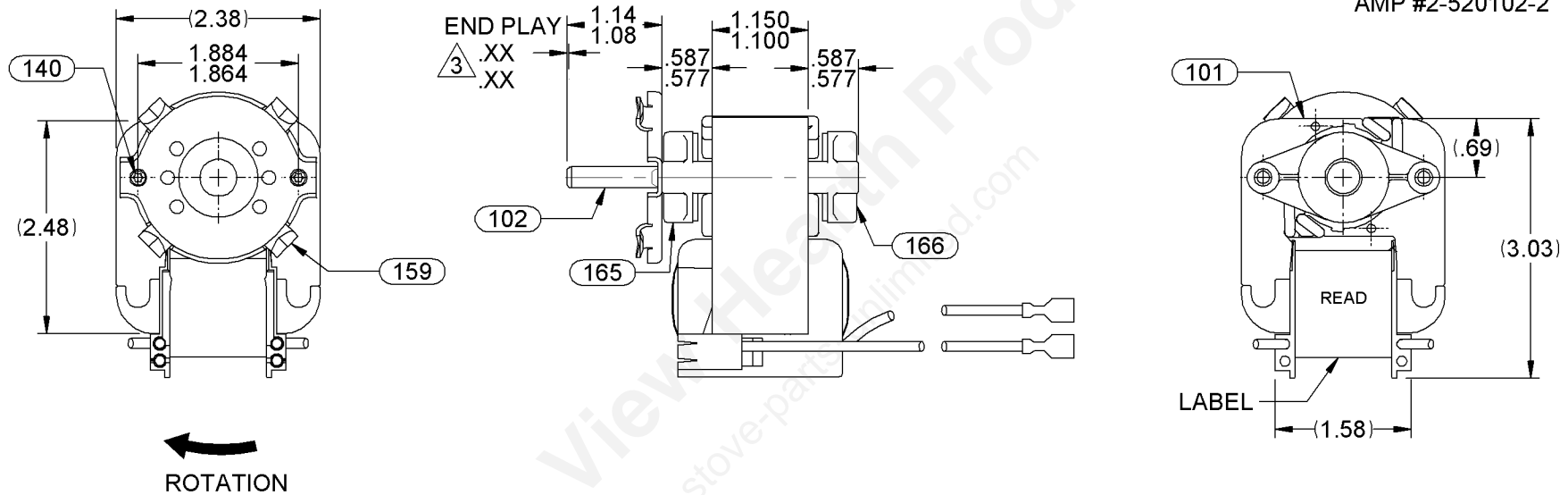

STDNP20

**FASCO** Industries, Inc.  
Motor Division  
Cassville Plant

UL  
SP

No. 7058-0210 Class B  
Type 58B V 115  
Hz 60 A 4 Z.P.  
RPM 3000  
Cust P/N 80442  
Sealed Ball Brg AO

6129-9553

FRONT SHAFT POSITION

HORZ.

AVERAGE SAMPLE VALUE AT:		115 VOLTS			60 HZ.			MOTOR WEIGHT LBS.			UNLESS OTHERWISE SPECIFIED DIMENSIONS ARE IN INCHES TOLERANCES ARE:		
MOTOR SPEED	IDLE			LOADED			LOCKED			BREAK			
	RPM	AMP	WATT	IN. OZ.	RPM	AMP	WATT	IN. OZ.	AMP	WATT	IN. OZ.		
	3412	.34	22	2.4	3000	.40	27	2.0	.52	32	2.8		
APPROVALS												DATE	
DRAWN										VLL	08-06-2002		
CHECKED										JMH	08-06-2002		
FINISH COLOR												NATURAL	

**FASCO** FASCO MOTORS GROUP  
AC MOTOR/BLOWER DIVISION

CONFIDENTIAL: DO NOT DUPLICATE OR DISCLOSE TO THIRD PARTIES WITHOUT WRITTEN PERMISSION OF FASCO MOTORS GROUP, AC MOTOR/BLOWER DIVISION.

TITLE  
**MOTOR ASSEMBLY**

SIZE DWG. NO. REV.  
**A** 7058 0210 01

DO NOT SCALE DRAWING SHEET 2 OF 2

If Printed, this is an Uncontrolled Document.



<b>Part Number</b>	70580210B	<b>Date</b>	7/23/02
<b>Customer</b>	U S STOVE	<b>Technician</b>	JLB
<b>Motor P/N</b>	58	<b>File Name</b>	4114
<b>Motor MFG</b>	CASS	<b>Barometric Pres.</b>	29.10
<b>Blower</b>	42	<b>Temperature</b>	73
<b>Impeller</b>	NEW #	<b>Air Density</b>	0.0724
<b>Chamber Number</b>	2	<b>Correction Factor</b>	1.0366
<b>Comments:</b>		<b>Volts/Hz</b>	116/60

SP	VP	RPM	AMPS	WATTS	CFM	CORR SP	NOZ FAC
0.20	0.00	3250	0.37	24.72	0.00	0.21	14.93
0.15	0.11	3221	0.36	24.43	18.40	0.16	14.93
0.13	0.45	3216	0.37	24.76	37.20	0.13	14.93
0.11	0.81	3160	0.37	25.17	49.90	0.11	14.93
0.08	1.10	3088	0.38	26.03	58.20	0.08	14.93
0.06	1.25	3030	0.39	26.52	62.00	0.06	14.93
0.04	1.35	2970	0.40	27.14	64.50	0.04	14.93
0.02	1.41	2973	0.40	27.14	65.90	0.02	14.93
0.00	1.53	2910	0.40	27.63	68.60	0.00	14.93

**Performance Disclaimer:**

This test data is from an engineering sample. Values shown do not guarantee production performance. Application suitability must be determined by customer.

N.P. Amps .40 App. By AJD 7-23-02

F A S C O I N D U S T R I E S , I N C .  
Cassville Motor & Blower Division

Fasco P/N: 71580210  
Revision: B  
Unit No: 1  
Customer: U S STOVE  
Cust P/N:

Date: 07-23-2002  
Filename: G2302009  
N/P Voltage: 115  
Rated Freq: 60  
Rotation: CWSE

Winding - Gauge Turns Res Amb C Rotor P/N: NEW #  
Main: 25 950 12.6 23 End Rings: .105F x .105F  
Tap1: E/R ID: .50  
Tap2: Skew:  
Protector: IMP. OD: US

BLAFRASCEBA: 005801X17 00

Comments: .56 AMPS 35 WATTS 120/60 C/LK  
Test is on 115 winding at 60 Hz

Volts	Amps	Win	Speed	OzIn	Eff	HP	Wout	Wloss
115.20	0.341	21.9	3412	0.04	0.004	0.000	0.1	21.8
115.20	0.341	21.9	3412	0.04	0.004	0.000	0.1	21.8
115.20	0.355	23.5	3313	0.90	0.094	0.003	2.2	21.2
115.20	0.392	26.7	3075	2.14	0.182	0.007	4.9	21.8
115.10	0.424	28.7	2839	2.81	0.206	0.008	5.9	22.8
115.00	0.448	30.2	2619	2.79	0.179	0.007	5.4	24.8
115.00	0.464	30.9	2411	2.84	0.164	0.007	5.1	25.8
115.00	0.476	31.4	2214	2.50	0.131	0.005	4.1	27.3
114.90	0.485	31.6	2021	2.32	0.110	0.005	3.5	28.2
114.90	0.492	31.8	1832	1.97	0.084	0.004	2.7	29.2
114.90	0.498	32.0	1647	1.79	0.068	0.003	2.2	29.8
114.90	0.503	32.1	1466	1.59	0.054	0.002	1.7	30.4
114.90	0.507	32.1	1294	1.70	0.051	0.002	1.6	30.5
114.90	0.511	32.1	1121	1.86	0.048	0.002	1.5	30.6
114.90	0.515	32.1	936	2.11	0.045	0.002	1.5	30.6
114.90	0.518	32.0	742	2.11	0.036	0.002	1.2	30.8
114.80	0.519	31.9	549	2.16	0.027	0.001	0.9	31.0
114.80	0.519	31.9	360	2.04	0.017	0.001	0.5	31.4
114.80	0.518	31.8	150	2.26	0.008	0.000	0.3	31.6
114.90	0.518	31.8	0	2.09	0.000	0.000	0.0	31.8
115.10	0.373	25.1	3200	1.60	0.151	0.005	3.8	21.3
115.20	0.388	26.3	3100	2.08	0.182	0.006	4.8	21.5
115.10	0.403	27.4	3000	2.44	0.197	0.007	5.4	22.0
115.10	0.417	28.3	2900	2.64	0.200	0.008	5.7	22.7
115.10	0.429	29.0	2800	2.75	0.197	0.008	5.7	23.3
115.00	0.440	29.7	2700	2.80	0.188	0.008	5.6	24.1
115.00	0.449	30.2	2600	2.85	0.182	0.007	5.5	24.7
114.90	0.493	31.8	1800	1.99	0.083	0.004	2.7	29.2
114.90	0.497	31.9	1700	1.82	0.072	0.003	2.3	29.6
114.90	0.499	32.0	1600	1.70	0.063	0.003	2.0	30.0

Weight \_\_\_\_\_ lb \_\_\_\_\_ oz

N.P.A. \_\_\_\_\_ amp

Technician \_\_\_\_\_  
Engineer ADD  
7-23-02

**Part Number**

70580210B

**File Name**

4114

**Customer**

U S STOVE

**Date**

7/23/02



**Comments**

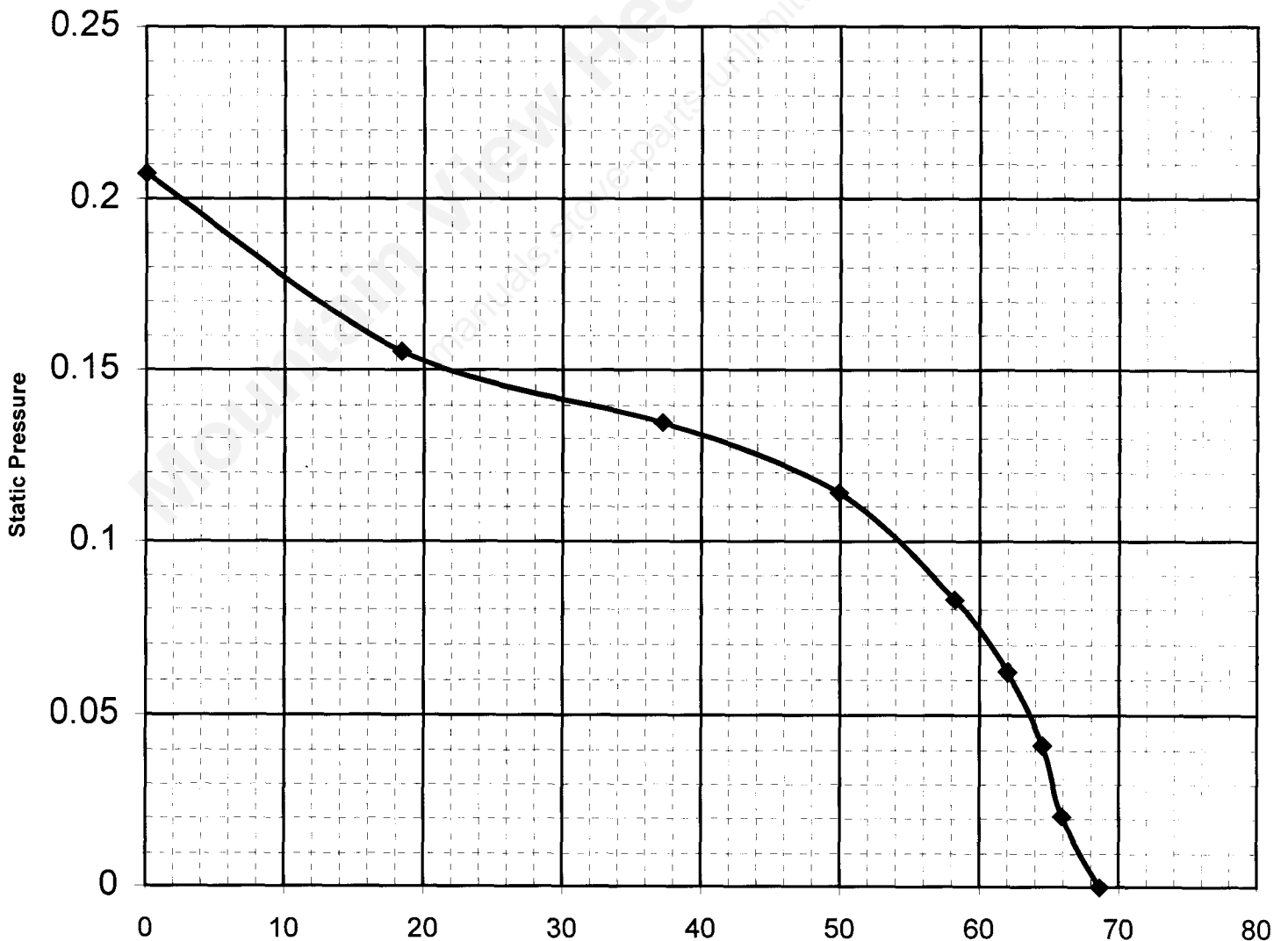
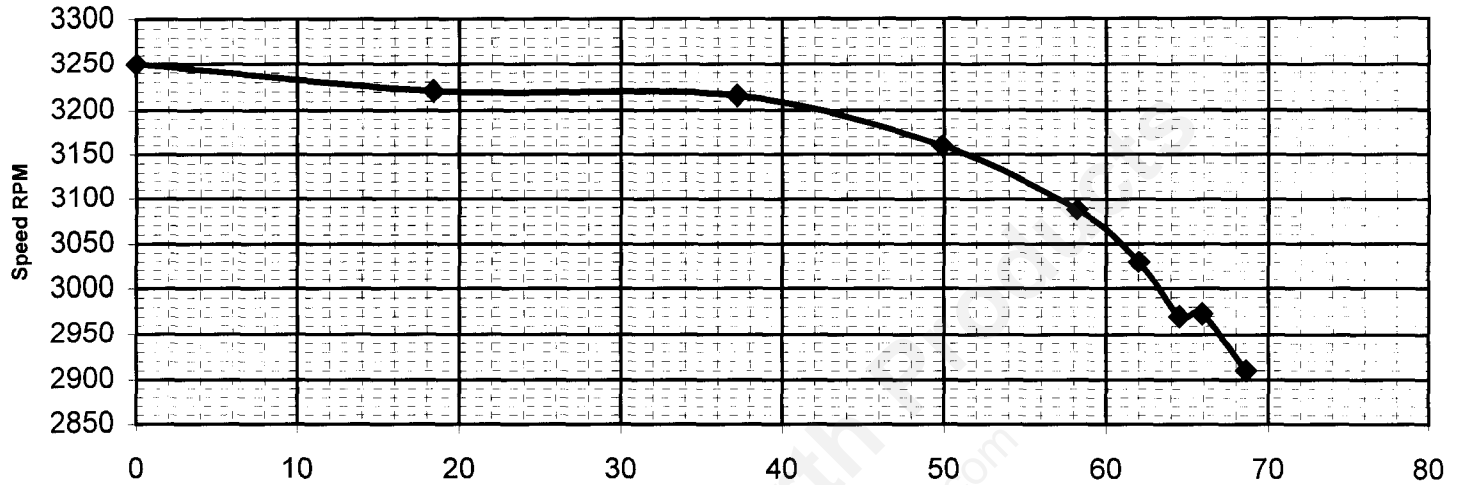

F A S C O I N D U S T R I E S

Fasco PN: 71580210

Date: 07-23-2002

Unit #: 1

Rev: B

Amp	Win	Eff	mHp	Oz In
.54	36	0.9	7.2	2.7
.48	32	0.8	6.4	2.4
.42	28	0.7	5.6	2.1
.36	24	0.6	4.8	1.8
.30	20	0.5	4.0	1.5
.24	16	0.4	3.2	1.2
.18	12	0.3	2.4	0.9
.12	8	0.2	1.6	0.6
.06	4	0.1	0.8	0.3
.00	0	0.0	0.0	0.0

