

200

DONTS

1. Don't dry clothing or other articles on or near the heater.
2. Don't store or place flammable liquids, gases, or pressurized containers near the heater
3. Don't attempt to use the heater until the installation is complete.
4. Don't use improper materials or substitute parts in the installation of the heater.
5. Don't take for granted that the heater is adjusted properly and is operating properly before leaving it unattended for long periods of time.
6. Don't install this heater in an area where combustible vapors are present.
7. Don't use gasoline, kerosene, engine oil, charcoal lighter or other flammable liquids to start or intensify a fire. Using these and other similar materials can cause an explosion within the heater.
8. Don't use an unlisted, type B, or poorly constructed or maintained chimney to vent this heater.
9. Don't use galvanized pipe, steel pipe less than 24 gauge, or pipe of a diameter smaller than 6" as a chimney connector.
10. Don't store ashes in combustible containers, store them near combustible materials or dispose of them until they have completely cooled.
11. Don't use power blowers or air circulation systems with this heater that are not specifically recommended by Martin Industries.
12. Don't operate the heater in a manner that causes any part of the heater or chimney connector to become red hot.

FIGURE 3

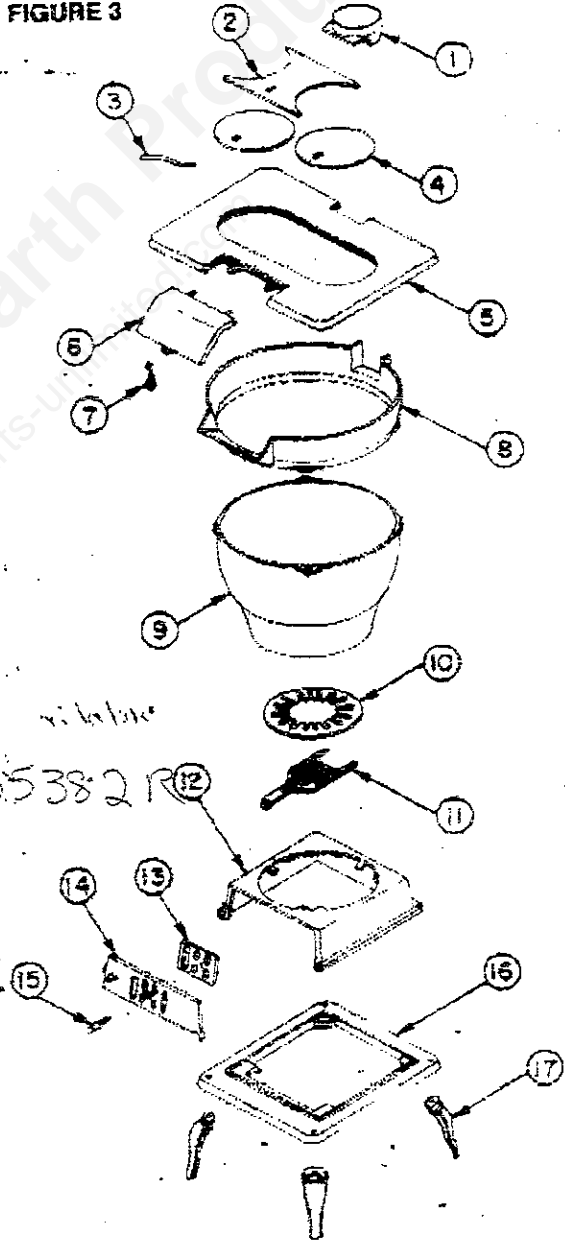

ORDER ALL REPAIR PARTS FROM YOUR KING DEALER BY SUPPLYING THE FOLLOWING INFORMATION:

1. PART NAME
2. PART NO. (Not Key No.)
3. MODEL NO.

KEY NO.	NAME OF PART	PART NO.
1	Collar, Reversible	005387FS
2	Center, Short	005383FS
3	Shaker - Lifter	005405FS
4	Cover	005396FS
5	Top, Extreme	005403FS
6	Door, Feed	005399FS
7	Handle, Drop Wire	004387S
8	Top, Flange	005406FS
9	Bowl, Fire	005381FS
10	Grate, Round	005395FS
11	Grate, Pull	005394FS
12	Base, Ash	005401FS
13	Slide, Draft	005398S
14	Door, Ash	005400FS
15	Knob #22	004455S
16	Bottom	005402FS
17	Foot Painted Assembly	004452S

To Order Parts:
 1-888-299-1440

* Available 3-25-99