

Gasket Replacement Instructions

for the Sequoia Stove

The Sequoia Stove uses rope-type fiberglass gaskets to make a tight seal between some parts, particularly those parts that move or may be removed. With use, gaskets can become brittle and compressed and can begin to lose their effectiveness.

All of the gaskets used in the Sequoia are made of fiberglass. The front, side and ash doors, as well as the top and inner top, all use 3/8" diameter gasket. The front door glass is sealed with a 3/16" gasket, while the flue collar employs a 1/4" size. This gasket kit includes enough gasket and cement to refurbish your entire stove.

Procedure

Before you begin to replace any gasket, however, wait until the fire is out and the stove has cooled. Be sure to follow the standard safety procedure for working with dusty materials; wear safety goggles and a dust mask. The procedure for replacing gaskets is the same, regardless of the gasket location. Four easily-accomplished steps are involved:

1. Remove the gasket.
2. Clean the groove of any remaining cement or gasket fragments.
3. Spread a bead of new cement in the groove.

4. Place the new gasket in position, beginning at one end of the gasket channel, and wait until you are a couple inches from the finishing end before trimming to its final size.

Replacing the Door Gasket

1. Remove the door when it is perpendicular to the stove by lifting it and raising the front end simultaneously. Lay it face down on a padded surface.
2. Remove the existing gasket by grasping an end and pulling firmly.
3. Use a wire brush or the tip of a screwdriver to clean the channel of any remaining cement or bits of gasket.
4. Apply a thin bead of stove cement to the newly-cleaned groove.
5. Pack a new 3/8" gasket into the groove. Wait until you have placed all but a couple inches from the end before you cut it.

To find low spots in the door gasketing that may allow too much air into the stove, close each door on a slip of paper and attempt to pull the paper free. If the paper is freed without tearing, the gasket is not snug enough at that spot.

If the door will not tighten sufficiently with additional turning of the handle, try "adjusting" the gasket in the area needing attention. Pack more cement or a smaller diameter gasket into the channel beneath the gasket so the main gasket is raised and makes contact with the stove front.

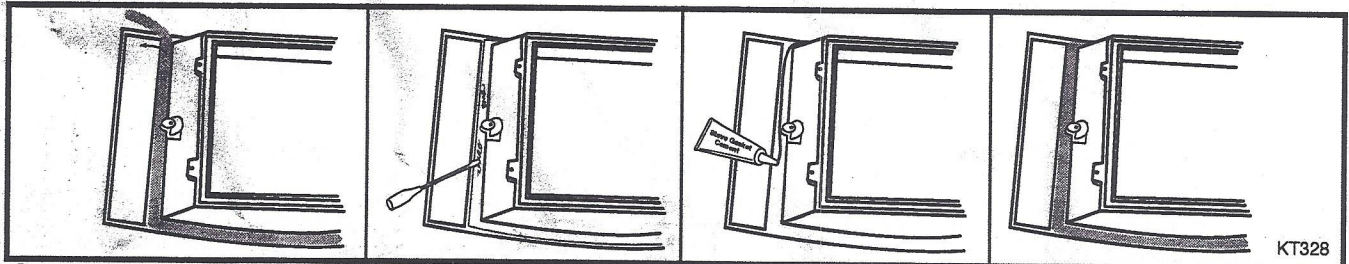

Step 1. Remove existing gasket.

Step 2. Clean the groove.

Step 3. Spread a bead of cement.

Step 4. Place new gasket in position.

KT328

7000899 12/08 Rev. 2

Replacing the Flue Collar Gasket

1. Remove any chimney connector.
2. Remove the flue collar of the stove.
3. Remove the existing gasket and install a new 1/4" gasket following steps 1-4 described on the reverse side.
4. Reconnect the flue collar to the stove and reinstall the chimney connector.

Replacing the Damper and Top Plate Gasket

This procedure can best be done when the stove's top is removed for a visual inspection of the catalytic combustor. Refer to the owner's manual for top plate removal and combustor inspection.

1. With the stove top removed, check the condition of the damper gasket. If it is damaged or portions are missing, it should be replaced.
2. Remove the existing gasket and install a new 3/8" gasket following steps 1-4 described on the reverse side.

Once the new gasket is installed, the damper may need to be adjusted for a proper fit. Refer to the owner's manual for damper adjustment instructions. Follow the same procedure to replace the gasket of the stove's top plate before reinstalling it.

Replacing the Door Glass Gasket

1. Remove the front door and place it face down on a padded surface.
2. Remove the 7/16" bolts holding the stainless steel glass retaining clips on the left and right sides of the glass. Remove the clips, and lift the glass off the brass frame.
3. Remove the old gasket and clean any residue.
4. Place a new piece of 3/16" gasket around the perimeter of the brass frame for the glass to rest on, then place the glass on it.
5. Position the glass retainer clips and fasten with the 7/16" bolts previously removed. Tighten the bolts alternately. Take care not to overtighten.

MHSC

149 Cleveland Drive • Paris, Kentucky 40361
www.mhsc.com